

ORIGINAL

RESOLUTION NO.: R-2025-057

*Authorizing acceptance and dedication of streets known as a portion of Ashcroft Circle, Brockway Drive, Clairmeade Way and Durwin Way, located in Ashcroft, Phase 1; Richland County
TMS#25711-05-01; CF#352-49*

WHEREAS, the above-referenced streets are located in the City limits of Columbia in the subdivision known as Ashcroft, Phase 1. The approval of the development plans for Ashcroft, Phase 1 included dedication of the streets to the City of Columbia; and,

WHEREAS, the Street Division has inspected the streets on the said property and found that they were constructed in compliance with the City's ordinances and regulations and recommends approval for acceptance; NOW, THEREFORE,

BE IT RESOLVED by the Mayor and City Council of the City of Columbia, South Carolina this day 16th of September, 2025 that the City of Columbia accepts dedication of the aforesaid streets known as a portion of Ashcroft Circle, Brockway Drive, Clairmeade Way, and Durwin Way, located in Ashcroft, Phase 1.

Ashcroft, Phase 1 subdivision is located in District 4 on the southeastern side of Clemson Road and was annexed into the City limits on September 30, 2019. The said streets are located as shown on a final plat of Ashcroft, Phase 1, dated December 15, 2020, last revised July 16, 2025 and to be recorded in the Office of the Register of Deeds for Richland County. Also being on file in the office of the Department of Engineering under City File #352-49. A copy of said final plat being attached hereto and made a part hereof as Exhibit "A".

Requested by:

Assistant City Manager Shealy

Approved by:

Cherise B. Wilson
City Manager

Approved as to form:

[Signature]
City Attorney

Mayor

[Signature]

ATTEST:

Erika D. Hammond
City Clerk

Introduced: 09/16/2025

Final Reading: 09/16/2025

Exhibit "A"
Ashcroft, Phase 1; CF#352-49

		CIVIL ENGINEERING OF COLUMBIA 1001 CENTER FOR 1ST FLOOR, 2ND FLOOR 1001 CENTER FOR 1ST FLOOR, 2ND FLOOR	19178	CIVIL ENGINEER	1 OF 1
			CLAYTON ROBERTS GROUP, INC. D/W/A/IN/C/O 2001 SOUTH CAROLINA	CIVIL ENGINEER	1 OF 1

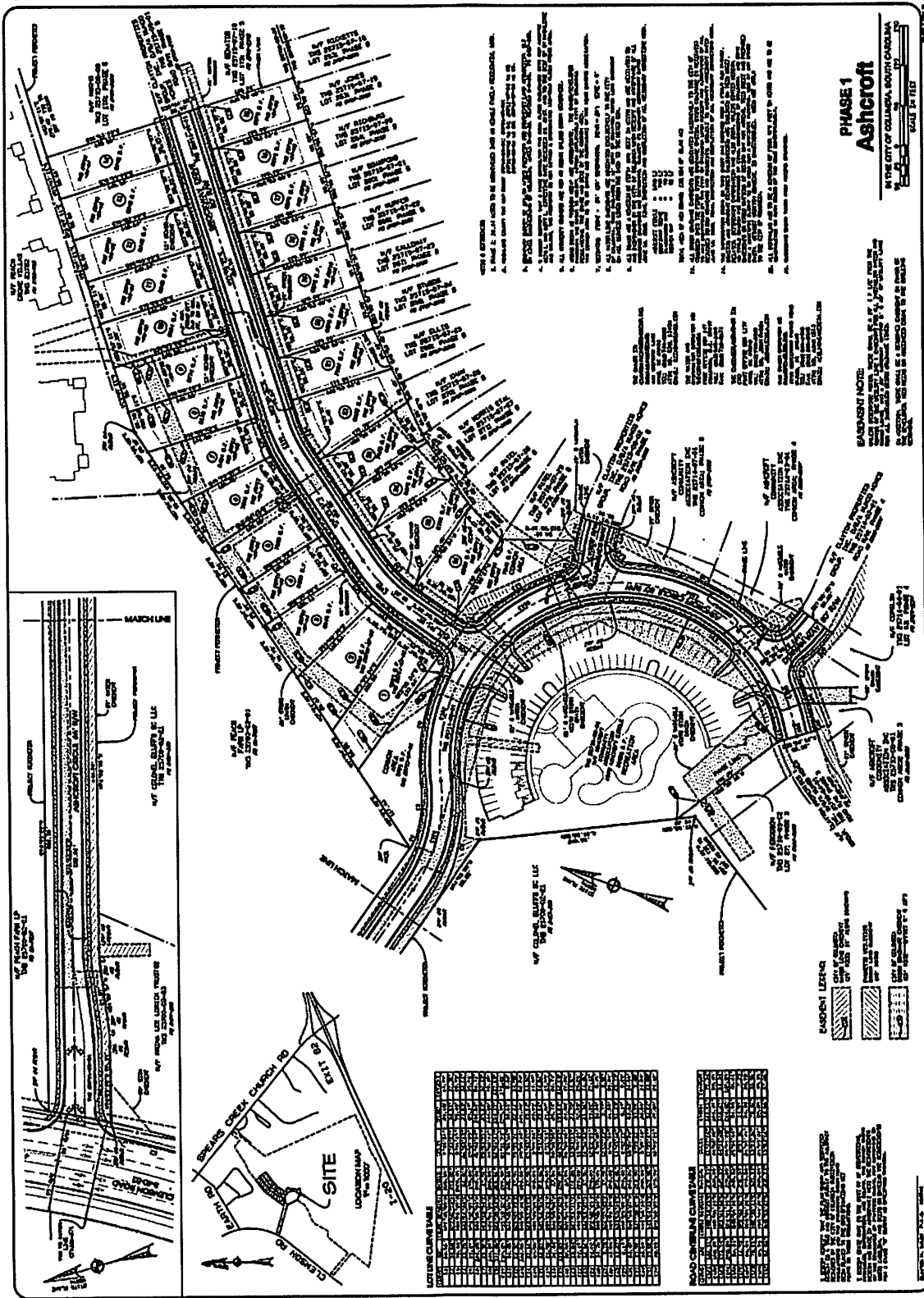

**PHASE 1
Ashcroft**

IN THE CITY OF COLUMBIA, SOUTH CAROLINA
 SCALE: 1/4" = 1'-0"

LANDSCAPE NOTES:
 1. ALL PLANTING SHALL BE INSTALLED IN ACCORDANCE WITH THE CITY OF COLUMBIA LANDSCAPE MAINTENANCE MANUAL.
 2. ALL PLANTING SHALL BE INSTALLED IN ACCORDANCE WITH THE CITY OF COLUMBIA LANDSCAPE MAINTENANCE MANUAL.
 3. ALL PLANTING SHALL BE INSTALLED IN ACCORDANCE WITH THE CITY OF COLUMBIA LANDSCAPE MAINTENANCE MANUAL.
 4. ALL PLANTING SHALL BE INSTALLED IN ACCORDANCE WITH THE CITY OF COLUMBIA LANDSCAPE MAINTENANCE MANUAL.
 5. ALL PLANTING SHALL BE INSTALLED IN ACCORDANCE WITH THE CITY OF COLUMBIA LANDSCAPE MAINTENANCE MANUAL.
 6. ALL PLANTING SHALL BE INSTALLED IN ACCORDANCE WITH THE CITY OF COLUMBIA LANDSCAPE MAINTENANCE MANUAL.
 7. ALL PLANTING SHALL BE INSTALLED IN ACCORDANCE WITH THE CITY OF COLUMBIA LANDSCAPE MAINTENANCE MANUAL.
 8. ALL PLANTING SHALL BE INSTALLED IN ACCORDANCE WITH THE CITY OF COLUMBIA LANDSCAPE MAINTENANCE MANUAL.
 9. ALL PLANTING SHALL BE INSTALLED IN ACCORDANCE WITH THE CITY OF COLUMBIA LANDSCAPE MAINTENANCE MANUAL.
 10. ALL PLANTING SHALL BE INSTALLED IN ACCORDANCE WITH THE CITY OF COLUMBIA LANDSCAPE MAINTENANCE MANUAL.

LANDSCAPE LEGEND

	LANDSCAPE LIGHTING
	LANDSCAPE PLANTING
	LANDSCAPE MATERIALS

LANDSCAPE CURTAIN WALL

1	2	3	4	5	6	7	8	9	10	11	12	13	14	15	16	17	18	19	20	21	22	23	24	25	26	27	28	29	30	31	32	33	34	35	36	37	38	39	40	41	42	43	44	45	46	47	48	49	50	51	52	53	54	55	56	57	58	59	60	61	62	63	64	65	66	67	68	69	70	71	72	73	74	75	76	77	78	79	80	81	82	83	84	85	86	87	88	89	90	91	92	93	94	95	96	97	98	99	100
---	---	---	---	---	---	---	---	---	----	----	----	----	----	----	----	----	----	----	----	----	----	----	----	----	----	----	----	----	----	----	----	----	----	----	----	----	----	----	----	----	----	----	----	----	----	----	----	----	----	----	----	----	----	----	----	----	----	----	----	----	----	----	----	----	----	----	----	----	----	----	----	----	----	----	----	----	----	----	----	----	----	----	----	----	----	----	----	----	----	----	----	----	----	----	----	----	----	----	-----

ROAD CURBLINE CURTAIN WALL

1	2	3	4	5	6	7	8	9	10	11	12	13	14	15	16	17	18	19	20	21	22	23	24	25	26	27	28	29	30	31	32	33	34	35	36	37	38	39	40	41	42	43	44	45	46	47	48	49	50	51	52	53	54	55	56	57	58	59	60	61	62	63	64	65	66	67	68	69	70	71	72	73	74	75	76	77	78	79	80	81	82	83	84	85	86	87	88	89	90	91	92	93	94	95	96	97	98	99	100
---	---	---	---	---	---	---	---	---	----	----	----	----	----	----	----	----	----	----	----	----	----	----	----	----	----	----	----	----	----	----	----	----	----	----	----	----	----	----	----	----	----	----	----	----	----	----	----	----	----	----	----	----	----	----	----	----	----	----	----	----	----	----	----	----	----	----	----	----	----	----	----	----	----	----	----	----	----	----	----	----	----	----	----	----	----	----	----	----	----	----	----	----	----	----	----	----	----	----	-----

NOTES:
 1. ALL PLANTING SHALL BE INSTALLED IN ACCORDANCE WITH THE CITY OF COLUMBIA LANDSCAPE MAINTENANCE MANUAL.
 2. ALL PLANTING SHALL BE INSTALLED IN ACCORDANCE WITH THE CITY OF COLUMBIA LANDSCAPE MAINTENANCE MANUAL.
 3. ALL PLANTING SHALL BE INSTALLED IN ACCORDANCE WITH THE CITY OF COLUMBIA LANDSCAPE MAINTENANCE MANUAL.
 4. ALL PLANTING SHALL BE INSTALLED IN ACCORDANCE WITH THE CITY OF COLUMBIA LANDSCAPE MAINTENANCE MANUAL.
 5. ALL PLANTING SHALL BE INSTALLED IN ACCORDANCE WITH THE CITY OF COLUMBIA LANDSCAPE MAINTENANCE MANUAL.
 6. ALL PLANTING SHALL BE INSTALLED IN ACCORDANCE WITH THE CITY OF COLUMBIA LANDSCAPE MAINTENANCE MANUAL.
 7. ALL PLANTING SHALL BE INSTALLED IN ACCORDANCE WITH THE CITY OF COLUMBIA LANDSCAPE MAINTENANCE MANUAL.
 8. ALL PLANTING SHALL BE INSTALLED IN ACCORDANCE WITH THE CITY OF COLUMBIA LANDSCAPE MAINTENANCE MANUAL.
 9. ALL PLANTING SHALL BE INSTALLED IN ACCORDANCE WITH THE CITY OF COLUMBIA LANDSCAPE MAINTENANCE MANUAL.
 10. ALL PLANTING SHALL BE INSTALLED IN ACCORDANCE WITH THE CITY OF COLUMBIA LANDSCAPE MAINTENANCE MANUAL.