

ORDINANCE NO. 2004-060

Annexing 409 Lost Creek Drive (Lot 19, Lost Creek Plantation),
Richland County TMS #05100-03-89 (portion)

WHEREAS, a proper petition has been filed with the City Council by one hundred (100%)
per cent of the property owners of the within described property under the provisions of South
Carolina Code Ann. Section 5-3-150; and,

WHEREAS, it appears to City Council that the annexation of the property would be in
the best interest of the property owners and the City of Columbia; NOW, THEREFORE,

BE IT ORDAINED by the Mayor and Council of the City of Columbia, South Carolina, this
21st day of July, 2004, that the property described herein is hereby annexed to and becomes
part of the City of Columbia effective immediately. This property shall be zoned RS-1.

PROPERTY DESCRIPTION: See attached EXHIBIT A
Richland County TMS NO.: 05100-03-89 (portion)

Also included in the territory hereby annexed are all contiguous portions of all public rights of
way, streets and highways.

Requested by:

MAYOR

Approved by:

City Manager

Approved as to form:

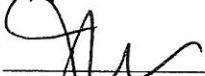
City Attorney

ATTEST:

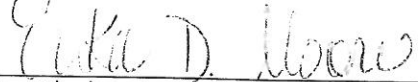
City Clerk

Introduced: 7/14/2004
Final Reading: 7/21/2004

ORIGINAL
STAMPED IN RED

EXHIBIT A
PROPERTY DESCRIPTION
ORDINANCE NO.: 2004-060

All that certain piece, parcel or lot of land, with improvements thereon, if any, situate, lying and being near the City of Columbia, in the County of Richland, State of South Carolina, being shown and delineated on Richland County Tax Map Sheet 05100, Block 03, Lot 89 (portion). Said parcel having such boundaries and measurements as are shown on said map.

MEMORANDUM

Office of the City Manager

LED

TO: Department Heads

FROM: *CPA* Charles P. Austin, Sr., City Manager

DATE: April 28, 2004

TO BE COMPLETED BY
DEVELOPMENT DIRECTOR:

County Zoning:
Proposed City Zoning:
Proposed Use: residential

RE: **Property Address:** 409 Lost Creek Drive (Lot 19, Lost Creek Plantation)
Richland County TMS: 05100-03-89 (portion)
Owner(s): Gregory D. Stoddard **Current Use:** vacant
Reason for Annexation: Contiguous; water service **City District:** 1

The City Attorney advises that the above referenced property has been offered for annexation. Attached please find a map or drawing reflecting the property. You are directed to forward your comments and/or recommendations regarding the issue of whether to annex or not to the Planning Department. The Planning Department will compile your comments for City Council consideration.

Time is of the essence and you must act promptly with regard to this matter. Planning Department staff will see to it that this matter is placed on the Planning Commission's agenda. Planning Department staff will notify the City Attorney of the Planning Commission's zoning recommendation by forwarding a copy of this form, completed, as soon as the Planning Commission has met.

Attachments

- | | |
|-------------------------------------------------------------|----------------------------------------|
| cc: David Johnson, Engineering Director | John Dooley, Utilities Director |
| Marc Mylott, Zoning Administrator | Cathy Alexander, Finance Director |
| Rick Semon, Community Dev. Admin. | Donny Phipps, Building Official |
| S. Allison Baker, Parks and Recreation Director | Missy Gentry, Public Services Director |
| Janet LaSchuma, Business License Admin. | J.R. Swisher, Acting Chief of Police |
| Sonya Covington, Water Customer Service | Judy Spell, 911 Communications |
| Nathaniel Land, Deputy Planning Director | Office of the Fire Chief |
| Tawana Shine, Accounting | Ted Morgan, Water Distribution |
| Skip Hudson, Community Planner | Denny Daniels, Engineering |
| James Johnson, Utilities | Fire Department |
| Howard Boyd, Engineering | Tony Westmoreland, Engineering |
| Mamie Gibbs, Engineering | Lloyd Brown, Water Distribution |
| Carolyn Wilson, Police Planning & Research Analyst | |
| Wendy Brawn, South Carolina Electric & Gas | |
| Marlin C. Henderson, Richland County Solid Waste Collection | |
| Alfreda Tindall, Richland County 911 Addressing Coordinator | |

Planning Commission Zoning Recommendation: RS-1 (zoning classification) approved (approved/denied)
 on June 7, 2004 (date)
[Signature]
 (Signature)

Owner: Greg J. Stoddard

Address: 409 Lost Creek Drive
(Lot 19, Lost Creek Plantation)

TMS No.: 05100-03-89 (portion)

Proposed Use of Property: residential

Purpose of Annexation: water

Council District: 1

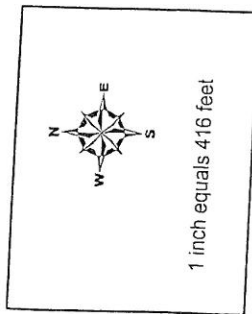

City of Columbia - Department of Engineering
Data represented on this map or plan is the
product of compilation, as produced by others.
It is provided for informational purposes only
and the City of Columbia makes no
representation as to its accuracy. Its use
without field verification is at the sole risk
of the user.

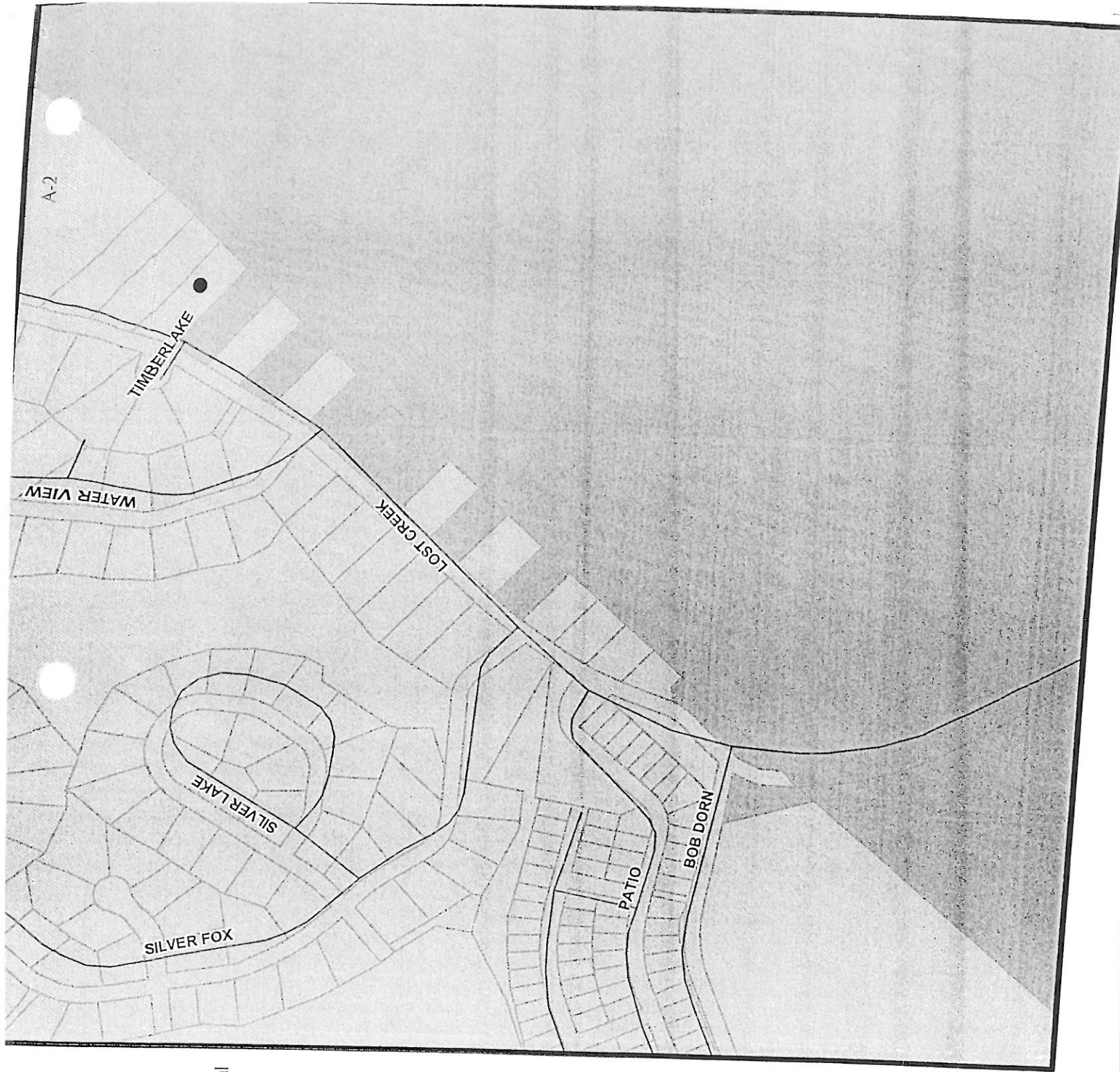

A-2

STATE OF SOUTH CAROLINA)
)
COUNTY OF RICHLAND)

PETITION FOR ANNEXATION

The undersigned, being the owner(s) of the property described below hereby petition(s) the Mayor and City Council for annexation to the City of Columbia, South Carolina pursuant to S.C. Code Ann. Section 5-3-150, 1976, as amended.

Property Description: All that certain piece, parcel or lot of land, with improvements thereon, if any, situate, lying and being near the City of Columbia, in the County of Richland, State of South Carolina, and being shown and delineated on Richland County Tax Map Sheet 05100 Block 03, Lot 89 (portion). Said parcel having such boundaries and measurements as are shown on said tax map sheet.

Richland County TMS: 05100-03-89 (portion)

Property Address: 409 Lost Creek Drive
(Lot 19, Lost Creek Plantation)

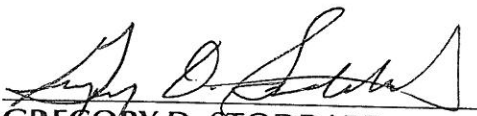
GREGORY D. STODDARD

Date: 4-23-04