

ORDINANCE NO. 2005-109

Annexing 198.95 +/- acres known as 7743 Garners Ferry Road;
7749 Garners Ferry Road and W/S Pineview Road Extension
Richland County TMS #16216-01-05; 19100-06-01; 19100-06-06;
19100-06-08 and 19100-06-09

WHEREAS, a proper petition has been filed with the City Council by one hundred (100%)
per cent of the property owners of the within described property under the provisions of South
Carolina Code Ann. Section 5-3-150; and,

WHEREAS, it appears to City Council that the annexation of the property would be in the
best interest of the property owners and the City of Columbia; NOW, THEREFORE,

BE IT ORDAINED by the Mayor and Council of the City of Columbia, South Carolina,
this 16th day of November, 2005, that the property described herein is hereby annexed to and
becomes part of the City of Columbia effective April 15, 2006. This property shall be
zoned PUD.

PROPERTY DESCRIPTION: See attached EXHIBIT A
Richland County TMS NO.: 16216-01-05; 19100-06-01; 19100-06-06;
19100-06-08 and 19100-06-09

Also included in the territory hereby annexed are all contiguous portions of all public rights of
way, streets and highways.

Requested by:

MAYOR

Approved by:

City Manager

Approved as to form:

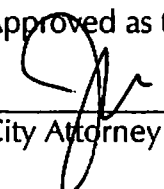
City Attorney

ATTEST:

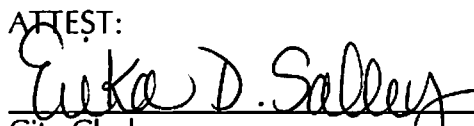
City Clerk

Introduced: 11/9/2005
Final Reading: 11/16/2005

ORIGINAL
STAMPED IN REC

EXHIBIT A
PROPERTY DESCRIPTION
ORDINANCE NO.: 2005-109

All those certain pieces, parcels or lots of land, with improvements thereon, if any, situate, lying and being near the City of Columbia, in the County of Richland, State of South Carolina, being shown and delineated on Richland County Tax Map Sheet 16216, Block 01, Lot 05; Sheet 19100, Block 06, Lot 01; Sheet 19100, Block 06, Lot 06; Sheet 19100, Block 06, Lot 08 and Sheet 19100, Block 06, Lot 09. Said parcels having such boundaries and measurements as are shown on said map.

MEMORANDUM

Office of the City Manager

TO: Department Heads

FROM: Charles P. Austin, Sr., City Manager

DATE: September 9, 2005

RE: **Property Address:** 7743 & 7749 Garners Ferry Rd, and W/S Pineview Rd Ext. (198.95 acres)
Richland County TMS: 16216-01-05; 19100-06-01, 06, 08, & 09
Owner(s): The BDF Limited Partnership, Alfred F. Burnside, and Zelle B. Burnside
Current Use: Agricultural **Current County Zoning:** D-1
Proposed Use: Mixed-Use **Proposed City Zoning:** PUD
Reason for Annexation: Contiguous; water service
City Council District: 4

The Planning Department advises that the above referenced property has been offered for annexation. Attached, please find a map or drawing reflecting the property. You are directed to forward your comments and/or recommendations regarding the issue of whether to annex or not to the Planning Department. The Planning Department will compile your comments for City Council consideration.

Time is of the essence and you must act promptly with regard to this matter. Planning Department staff will see to it that this matter is placed on the Planning Commission's agenda. Planning Department staff will notify the City Attorney of the Planning Commission's zoning recommendation by forwarding a copy of this form, completed, as soon as the Planning Commission has met.

/swh
 Attachments

- | | |
|---|--|
| cc: John Dooley, Utilities Director | Shahid Khan, Engineering |
| Marc Mylott, Development Services Director | Cathy Alexander, Finance Director |
| Rick Semon, Community Dev. Admin. | Office of the Building Official |
| S. Allison Baker, Parks and Recreation Director | Missy Gentry, Public Services Director |
| Janet LaSchuma, Business License Admin. | H. Dean Crisp, Chief of Police |
| Sonya Covington, Water Customer Service | Judy Spell, 911 Communications |
| James Meggs, City Attorney | Bradley Anderson, Fire Chief |
| Tawana Shine, Accounting | Ted Morgan, Water Distribution |
| Skip Hudson, Community Planner | Denny Daniels, Engineering |
| James Johnson, Utilities | Joseph Floyd, Fire Department |
| Howard Boyd, Engineering | Lloyd Brown, Water Distribution |
| Andrew Livengood, Zoning | Susan Leitner, Engineering |
| Carolyn Wilson, Police Planning & Research | Mid Carolina Electric Cooperative |
| Wendy Brawn, South Carolina Electric & Gas | |
| Marlin C. Henderson, Richland County Solid Waste Collection | |
| Alfreda Tindall, Richland County 911 Addressing Coordinator | |

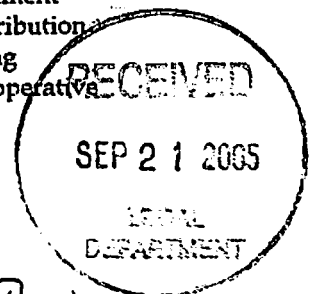

Planning Commission Zoning Recommendation: PUD-LS (Zoning classification)
8-0 (Approved/Denied)
 on 9/19/05 (mm/dd/yyyy)

 (Signature)

7.8 acres Garners Ferry Road Annexation with Rezoning of portion from Richland County D-1 to C-3

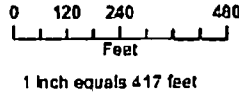

COLUMBIA
A Capital Place To Be

Planning & Zoning Department
Zoning Division

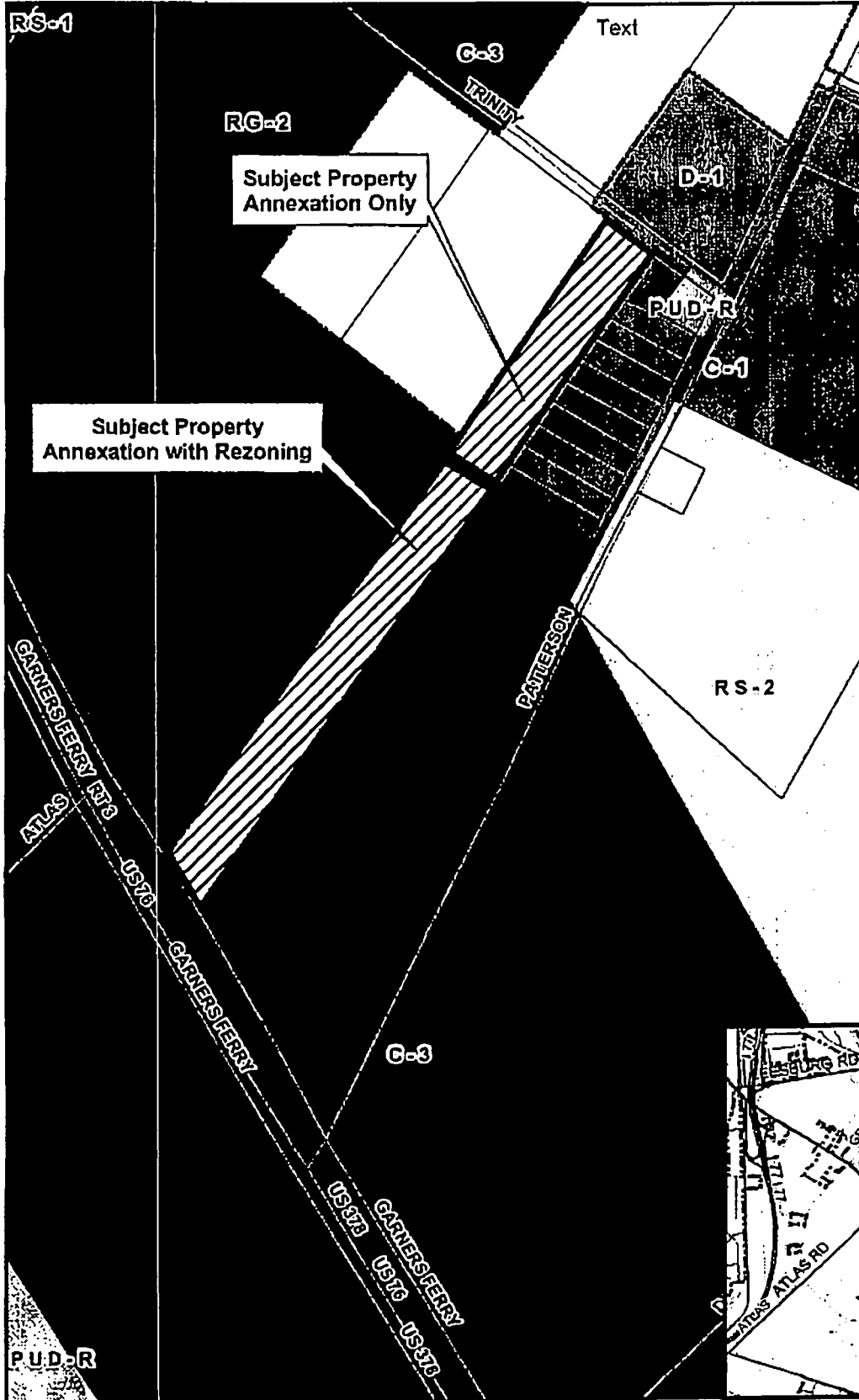

LEGEND

- Street Centerlines
- City Limits
- Parcels
- Zoning Districts**
- D-1
- RS-1
- RS-1A
- RS-1B
- RS-2
- RS-3
- RD
- RG-1
- RG-1A
- RG-2
- RG-3
- UTD
- C-1
- C-2
- C-3
- C-3A
- C-4
- C-5
- M-1
- M-2
- PUD-R
- PUD-C
- PUD-LS (Harbison)
- Out of City

ORIGINAL PREPARATION/DATE:

This map was prepared by:
Andrew Livongood
Planning Commission
September 12, 2005

REVISION NUMBER/DATE:
None

DISCLAIMER:
The City of Columbia Department of Engineering and Department of Planning and Zoning data represented on this map or plan is the product of compilation, as produced by others. It is provided for informational purposes only and the City of Columbia makes no representation as to its accuracy. Its use without field verification is at the sole risk of the user.

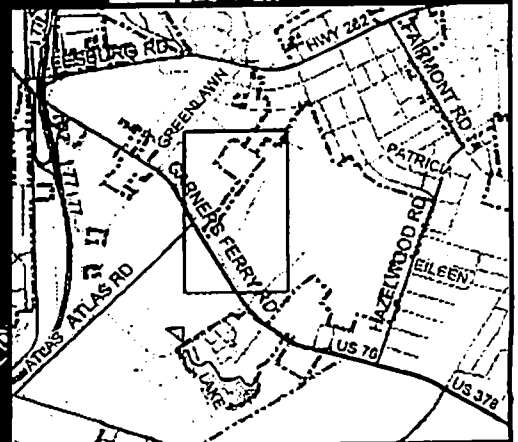

STATE OF SOUTH CAROLINA)
)
COUNTY OF RICHLAND)

PETITION FOR ANNEXATION

The undersigned, being the owner of the property described below hereby petitions the Mayor and City Council for annexation to the City of Columbia, South Carolina pursuant to S.C. Code Ann. Section 5-3-150, 1976, as amended.

Property Description: All that certain piece, parcel or lot of land, with improvements thereon, if any, situate, lying and being near the City of Columbia, in the County of Richland, State of South Carolina, and being shown and delineated as PARCEL "D" (containing 4.07 acres), on a Boundary Plat prepared for John W. & Alfred F. Burnside by Palmetto Engineering & Surveying Co., Inc., dated December, 2, 1986, last revised September 11, 1989, and recorded in the Office of the Register of Deeds for Richland County, South Carolina on October 19, 1989 in Plat Book 52, page 8061. Reference is carved to said Boundary Plat for a more complete metes and bounds description of said PARCEL "D".

Richland County TMS: 19100-06-01

Property Address: 7743 Garners Ferry Road

ZELLE B. BURNSIDE

Date: 9/9/05

**MUNICIPAL BOUNDARIES OF THE CITY OF COLUMBIA
PROPOSED ANNEXATION**

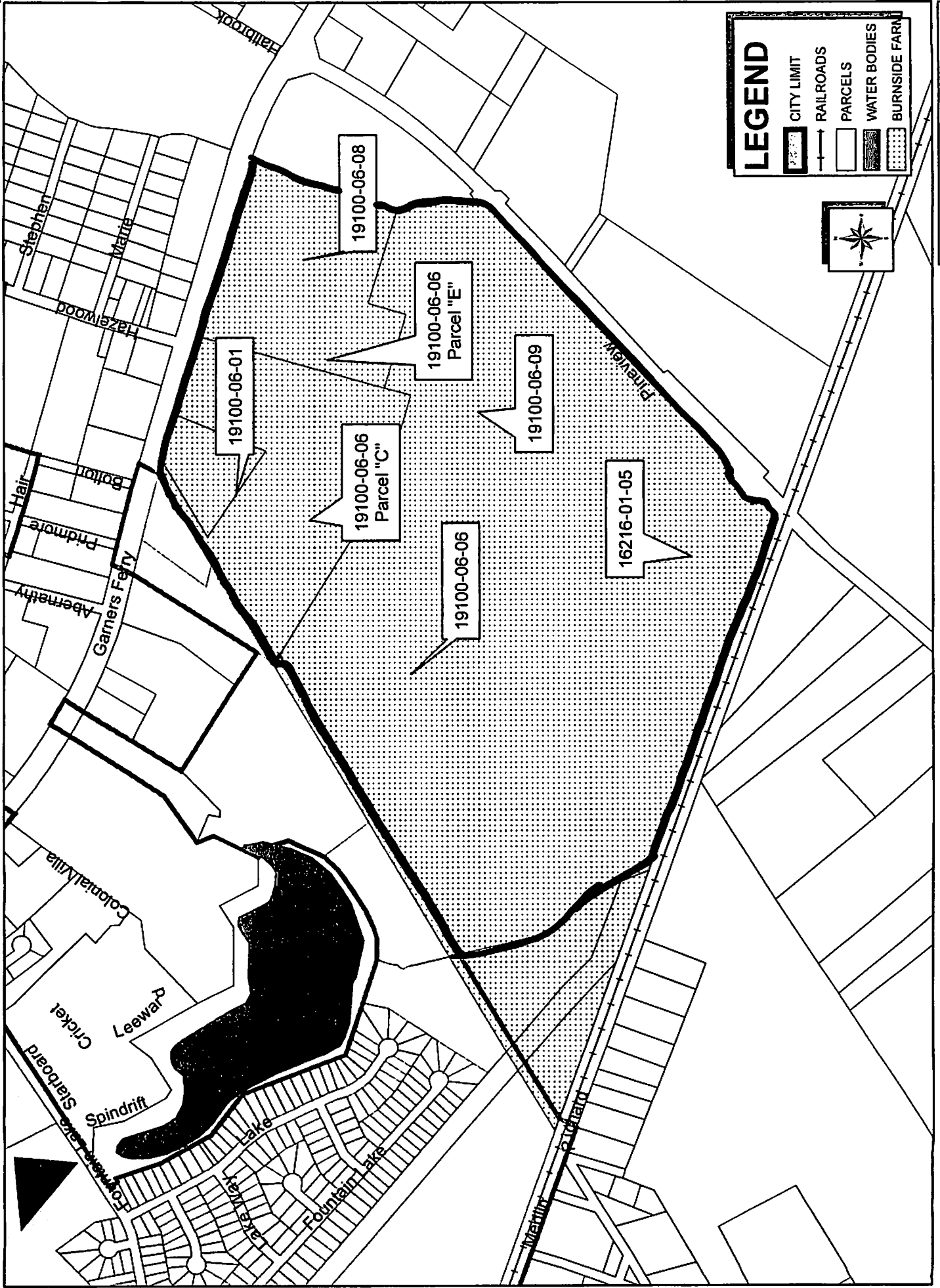

Map provided by the City of Columbia Planning Department. SVM 090803.
Disclaimer: Some parcels as represented may not be accurate. Refer to Richland County Tax Assessor for updated parcel information.