

ORDINANCE NO. 2005-117

Annexing 54.217 acres N/S Old Percival Road and  
17.23 acres S/S I-20 at Old Percival Road, Richland County TMS 22607-01-05;  
22608-01-01 and 22608-01-02

WHEREAS, a proper petition has been filed with the City Council by one hundred (100%)  
per cent of the property owners of the within described property under the provisions of South  
Carolina Code Ann. Section 5-3-150; and,

WHEREAS, it appears to City Council that the annexation of the property would be in the  
best interest of the property owners and the City of Columbia; NOW, THEREFORE,

BE IT ORDAINED by the Mayor and Council of the City of Columbia, South Carolina, this  
11th day of January, 2006, that the property described herein is hereby annexed to and  
becomes part of the City of Columbia effective April 15, 2006. This property shall be zoned  
RG-1.

PROPERTY DESCRIPTION: See attached EXHIBIT A  
Richland County TMS NO.: 22607-01-05; 22608-01-01 and 22608-01-02

Also included in the territory hereby annexed are all contiguous portions of all public rights of  
way, streets and highways.

Requested by:

  
MAYOR

Approved by:

  
City Manager

Approved as to form:

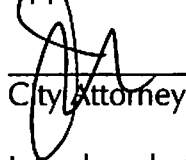
  
City Attorney

ATTEST:

  
City Clerk

Introduced: 12/14/2005  
Final Reading: 1/11/2006

ORIGINAL  
STAMPED IN REC

**EXHIBIT A**  
**PROPERTY DESCRIPTION**  
**ORDINANCE NO.: 2005-117**

All those certain pieces, parcels or lots of land, with improvements thereon, if any, situate, lying and being near the City of Columbia, in the County of Richland, State of South Carolina, being shown and delineated on Richland County Tax Map Sheet 22601, Block 01, Lot 05, Sheet 22608, Block 01, Lot 01 and Sheet 22608, Block 01, Lot 02. Said parcels having such boundaries and measurements as are shown on said map.

# MEMORANDUM

## Office of the City Manager

TO: Department Heads  
FROM: *CMAE* Charles P. Austin, Sr., City Manager  
DATE: August 16, 2005

TO BE COMPLETED BY  
DEVELOPMENT DIRECTOR:  
County Zoning: *RG-1 / R-5*  
Proposed City Zoning:  
Proposed Use: *SF / T-200*

RE: Property Address: 54.217 acres N/S Old Percival Road and 17.23 acres S/S/ I-20 at Old Percival Road  
Richland County TMS: 22607-01-05; 22608-01-01 and 22608-01-02  
Owner(s): Allen Edgerton, et al., and Thomas O. Milliken, et al.  
Current Use: vacant  
Reason for Annexation: Contiguous; water  
City District: 4

The City Attorney advises that the above referenced property has been offered for annexation. Attached please find a map or drawing reflecting the property. You are directed to forward your comments and/or recommendations regarding the issue of whether to annex or not to the Planning Department. The Planning Department will compile your comments for City Council consideration.

Time is of the essence and you must act promptly with regard to this matter. Planning Department staff will see to it that this matter is placed on the Planning Commission's agenda. Planning Department staff will notify the City Attorney of the Planning Commission's zoning recommendation by forwarding a copy of this form, completed, as soon as the Planning Commission has met.

### Attachments

cc: John Dooley, Utilities Director  
Marc Mylott, Zoning Administrator  
Rick Semon, Community Dev. Admin.  
S. Allison Baker, Parks and Recreation Director  
Janet LaSchuma, Business License Admin.  
Sonya Covington, Water Customer Service  
Nathaniel Land, Deputy Planning Director  
Tawana Shine, Accounting  
Skip Hudson, Community Planner  
James Johnson, Utilities  
Howard Boyd, Engineering  
Andrew Livengood, Zoning  
Carolyn Wilson, Police Planning & Research  
Wendy Brawn, South Carolina Electric & Gas  
Marlin C. Henderson, Richland County Solid Waste Collection  
Alfreda Tindall, Richland County 911 Addressing Coordinator

Shahid Khan, Engineering  
Cathy Alexander, Finance Director  
Office of the Building Official  
Missy Gentry, Public Services Director  
H. Dean Crisp, Chief of Police  
Judy Spell, 911 Communications  
Bradley Anderson, Fire Chief  
Ted Morgan, Water Distribution  
Denny Daniels, Engineering  
Joseph Floyd, Fire Department  
Lloyd Brown, Water Distribution  
Susan Leitner, Engineering  
Mid Carolina Electric Cooperative

Planning Commission Zoning Recommendation: RG-1 (zoning classification) 80 (approved/denied)  
on 10/13/05 (date)  
*[Signature]*  
(Signature)

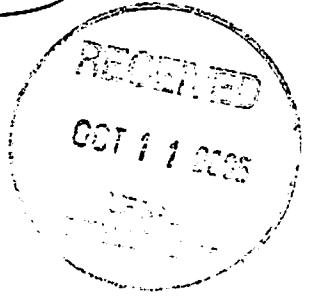

# MEMORANDUM

## Office of the City Manager

TO: Department Heads  
FROM: *CMAE* Charles P. Austin, Sr., City Manager  
DATE: August 16, 2005

TO BE COMPLETED BY  
DEVELOPMENT DIRECTOR:  
County Zoning: *RG-1*  
Proposed City Zoning: *7-1*  
Proposed Use: *SF*

RE: Property Address: 54.217 acres N/S Old Percival Road and 17.23 acres S/S/ I-20 at Old Percival Road  
Richland County TMS: 22607-01-05; 22608-01-01 and 22608-01-02  
Owner(s): Allen Edgerton, et al., and Thomas O. Milliken, et al.  
Current Use: vacant  
Reason for Annexation: Contiguous; water  
City District: 4

The City Attorney advises that the above referenced property has been offered for annexation. Attached please find a map or drawing reflecting the property. You are directed to forward your comments and/or recommendations regarding the issue of whether to annex or not to the Planning Department. The Planning Department will compile your comments for City Council consideration.

Time is of the essence and you must act promptly with regard to this matter. Planning Department staff will see to it that this matter is placed on the Planning Commission's agenda. Planning Department staff will notify the City Attorney of the Planning Commission's zoning recommendation by forwarding a copy of this form, completed, as soon as the Planning Commission has met.

### Attachments

cc: John Dooley, Utilities Director  
Marc Mylott, Zoning Administrator  
Rick Semon, Community Dev. Admin.  
S. Allison Baker, Parks and Recreation Director  
Janet LaSchuma, Business License Admin.  
Sonya Covington, Water Customer Service  
Nathaniel Land, Deputy Planning Director  
Tawana Shine, Accounting  
Skip Hudson, Community Planner  
James Johnson, Utilities  
Howard Boyd, Engineering  
Andrew Livengood, Zoning  
Carolyn Wilson, Police Planning & Research  
Wendy Brawn, South Carolina Electric & Gas  
Marlin C. Henderson, Richland County Solid Waste Collection  
Alfreda Tindall, Richland County 911 Addressing Coordinator

Shahid Khan, Engineering  
Cathy Alexander, Finance Director  
Office of the Building Official  
Missy Gentry, Public Services Director  
H. Dean Crisp, Chief of Police  
Judy Spell, 911 Communications  
Bradley Anderson, Fire Chief  
Ted Morgan, Water Distribution  
Denny Daniels, Engineering  
Joseph Floyd, Fire Department  
Lloyd Brown, Water Distribution  
Susan Leitner, Engineering  
Mid Carolina Electric Cooperative

Planning Commission Zoning Recommendation: RG-1 (zoning classification) 6-2 (approved/denied)  
on 10/13/05 (date)  
[Signature]  
(Signature)

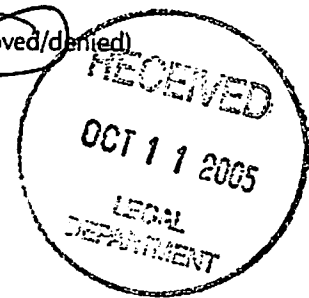

# CITY OF COLUMBIA

Address: 54.217 acres  
N/S Old Percival Road

TMS: 22607-01-05

Proposed Use of Property: residential

Purpose of Annexation: water

Council District: 4

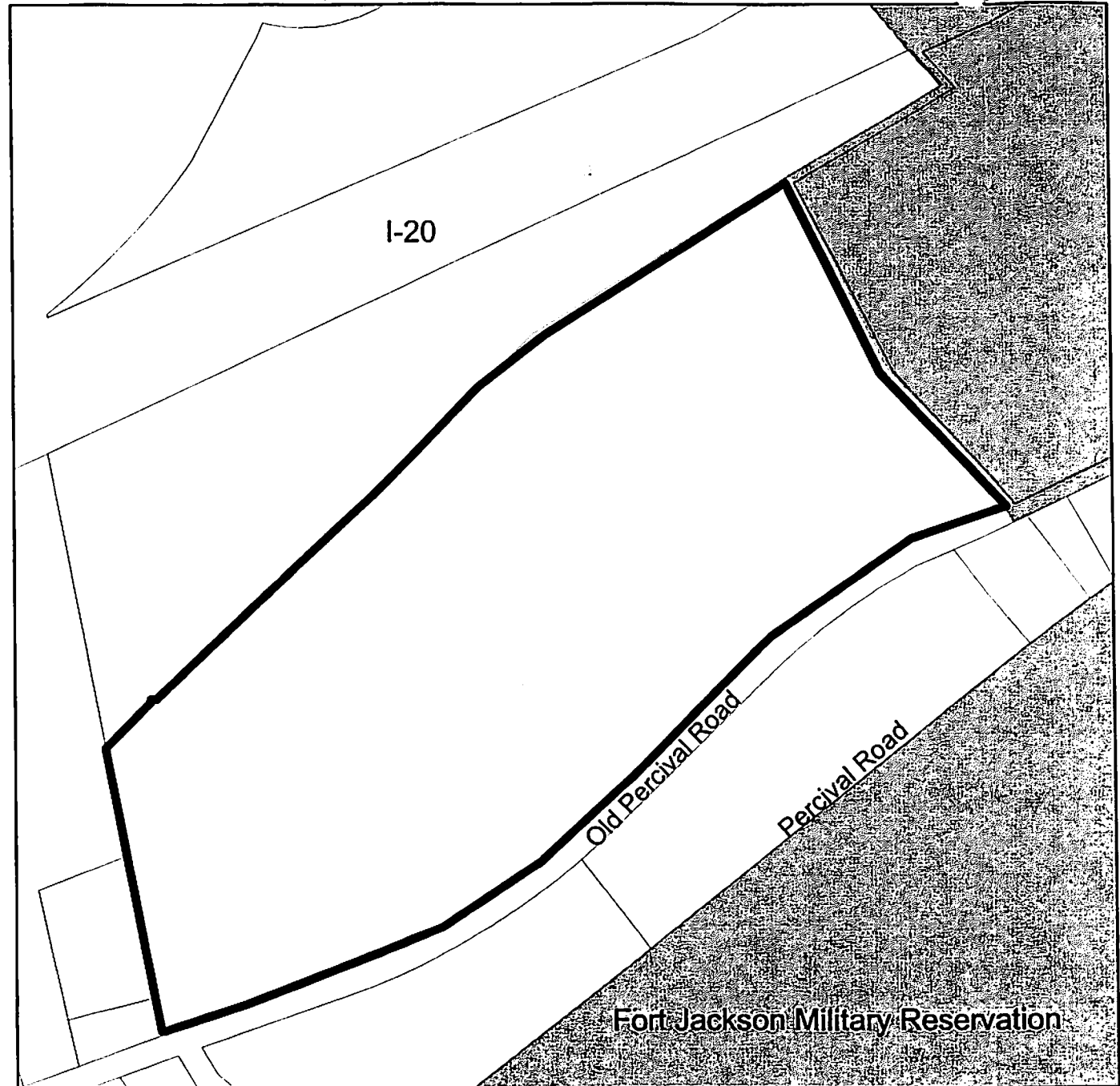

City of Columbia - Department of Engineering  
Data represented on this map or plan is the product of compilation, as produced by others. It is provided for informational purposes only and the City of Columbia makes no representation as to its accuracy. Its use without field verification is at the sole risk of the user.

DEAN B. SMITH  
PLANNING ENGINEER  
1000 14th St. N.E.  
WASHINGTON, D.C.



THOMAS B. MILLWATER

THOMAS B. MILLWATER

ATTORNEY AT LAW

54.209 ACRES  
(CONTAINS 2 (TWO) LOTS)  
(SEE RECORD)

THIS PLAN IS A PART OF A SURVEY MADE BY DEAN B. SMITH, PLANNING ENGINEER, AND THOMAS B. MILLWATER, ATTORNEY AT LAW, FOR THE PURPOSE OF DIVIDING THE PROPERTY OF MARtha ALLEN EDGERTON AND DOROTHY B. ALLEN, APPROXIMATELY 11 MILES NORTHEAST OF COLUMBIA, SC, INTO TWO (2) LOTS. THE TOTAL AREA OF THE PROPERTY IS 54.209 ACRES. THE PROPERTY IS LOCATED IN RICHLAND COUNTY, SOUTH CAROLINA. THE SURVEY WAS MADE ON APRIL 15, 1972. THE PLAN IS SUBJECT TO THE RECORDS OF THE COUNTY CLERK OF RICHLAND COUNTY, SOUTH CAROLINA.

PROPERTY SURVEYED FOR  
**MARtha ALLEN EDGERTON  
AND DOROTHY B. ALLEN**  
APPROXIMATELY 11 MILES NORTHEAST OF COLUMBIA, SC  
IN RICHLAND COUNTY

APPROVED FOR RECORDING  
ON December 14, 1972  
Attest: *[Signature]*  
Clerk

SCALE: 1" = 100'  
GRAPHIC SCALE

D. P. HARRIS & SONS, INC. - ENGINEERS & SURVEYORS - COLUMBIA, S.C. 29204

-666-

# CITY OF COLUMBIA

Address: 17.23 acres  
S/S I-20 at Old Percival Road

TMS: 22608-01-01 and 22608-01-02

Proposed Use of Property: residential

Purpose of Annexation: water

Council District: 4



City of Columbia - Department of Engineering  
Data represented on this map or plan is the product  
of compilation, as produced by others. It is provided  
for informational purposes only and the City of  
Columbia makes no representation as to its accuracy.  
Use without field verification is at the sole risk of the user.

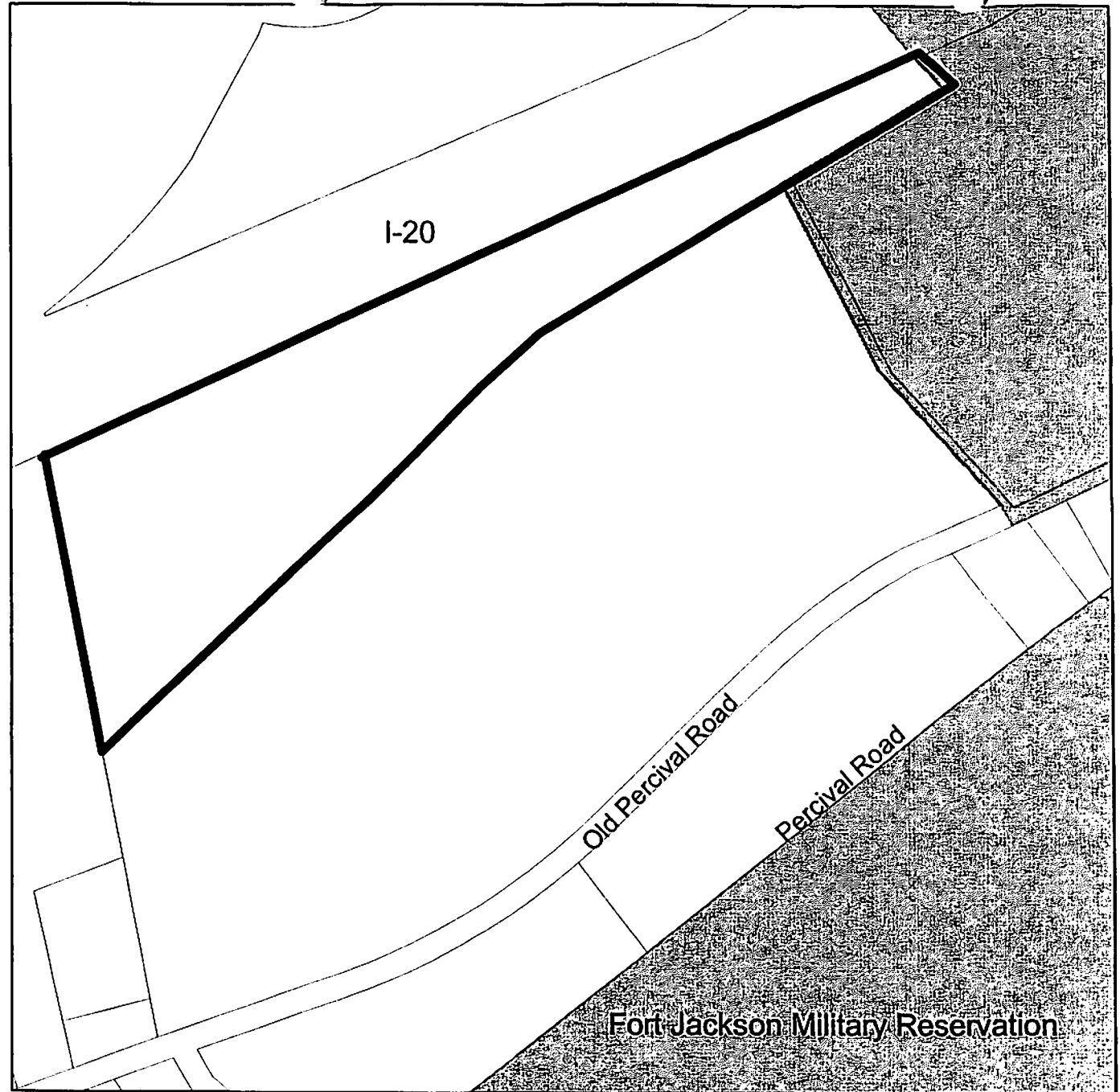





From: 803 325 2141 Page: 9/11 Date: 8/2/2005 8:47:14 PM

06/28/2005 14:52 FAX 737 4250

COLUMBIA CITY ATTORNEY

002

STATE OF SOUTH CAROLINA )  
 )  
COUNTY OF RICHLAND ) PETITION FOR ANNEXATION

The undersigned, being the owner(s) of the property described below hereby petition(s) the Mayor and City Council for annexation to the City of Columbia, South Carolina pursuant to S.C. Code Ann. Section 5-3-150, 1976, as amended.

Property Description: All that certain piece, parcel or lot of land, with improvements thereon, if any, situate, lying and being near the City of Columbia, in the County of Richland, State of South Carolina, and being shown and delineated as Richland County Tax Map Sheet 22607 Block 01, Lot 05. Said parcel having such boundaries and measurements as are shown on said map.

Richland County TMS: 22607-01-05

Property Address: 54.217 acres  
N/S Old Percival Road

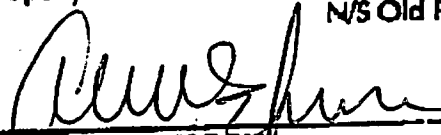
  
\_\_\_\_\_  
ALLEN W. EDGERTON

Date: 10 Aug 2005

\_\_\_\_\_  
DOROTHY H. EDGERTON

Date: \_\_\_\_\_

\_\_\_\_\_  
FREDERICK W. EDGERTON

Date: \_\_\_\_\_

\_\_\_\_\_  
DOROTHY B. ALLEN

Date: \_\_\_\_\_

From: 803 325 2141 Page: 9/11 Date: 8/2/2005 8:47:14 PM

08/25/2005 14:52 FAX 737 4250

COLUMBIA CITY ATTORNEY

002

STATE OF SOUTH CAROLINA  
COUNTY OF RICHLAND

PETITION FOR ANNEXATION

The undersigned, being the owner(s) of the property described below hereby petition(s) the Mayor and City Council for annexation to the City of Columbia, South Carolina pursuant to S.C. Code Ann. Section 5-3-150, 1976, as amended.

Property Description: All that certain piece, parcel or lot of land, with improvements thereon, if any, situate, lying and being near the City of Columbia, in the County of Richland, State of South Carolina, and being shown and delineated as Richland County Tax Map Sheet 22607 Block 01, Lot 05. Said parcel having such boundaries and measurements as are shown on said map.

Richland County TMS: 22607-01-05

Property Address: 54.217 acres  
N/S Old Percival Road

ALLEN W. EDGERTON

Date: \_\_\_\_\_



DOROTHY H. EDGERTON

Date: 10 Aug 05

FREDERICK W. EDGERTON

Date: \_\_\_\_\_

*Dorothy B. Allen*  
DOROTHY B. ALLEN

Date: 10 Aug 05

From: 803 325 2 41 Page: 9/11 Date: 8/2/2005 8:47:14 PM

08/25/2005 14:58 FAX 737 4250

COLUMBIA CITY ATTORNEY

002

STATE OF SOUTH CAROLINA )  
 )  
 COUNTY OF RICHLAND )      PETITION FOR ANNEXATION

The undersigned, being the owner(s) of the property described below hereby petition(s) the Mayor and City Council for annexation to the City of Columbia, South Carolina pursuant to S.C. Code Ann. Section 5-3-150, 1976, as amended.

Property Description: All that certain piece, parcel or lot of land, with improvements thereon, if any, situate, lying and being near the City of Columbia, in the County of Richland, State of South Carolina, and being shown and delineated as Richland County Tax Map Sheet 22607 Block C1, Lot 05. Said parcel having such boundaries and measurements as are shown on said map.

Richland County TMS: 22607-01-05

Property Address: 54.217 acres  
 N/5 Old Percival Road

\_\_\_\_\_  
 ALLEN W. EDGERTON      Date: \_\_\_\_\_

\_\_\_\_\_  
 DOROTHY H. EDGERTON      Date: \_\_\_\_\_

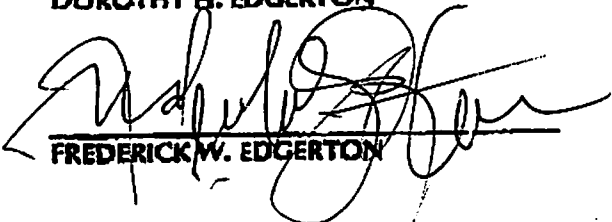
  
 \_\_\_\_\_  
 FREDERICK W. EDGERTON      Date: 10 AUG 05

\_\_\_\_\_  
 DOROTHY B. ALLEN      Date: \_\_\_\_\_

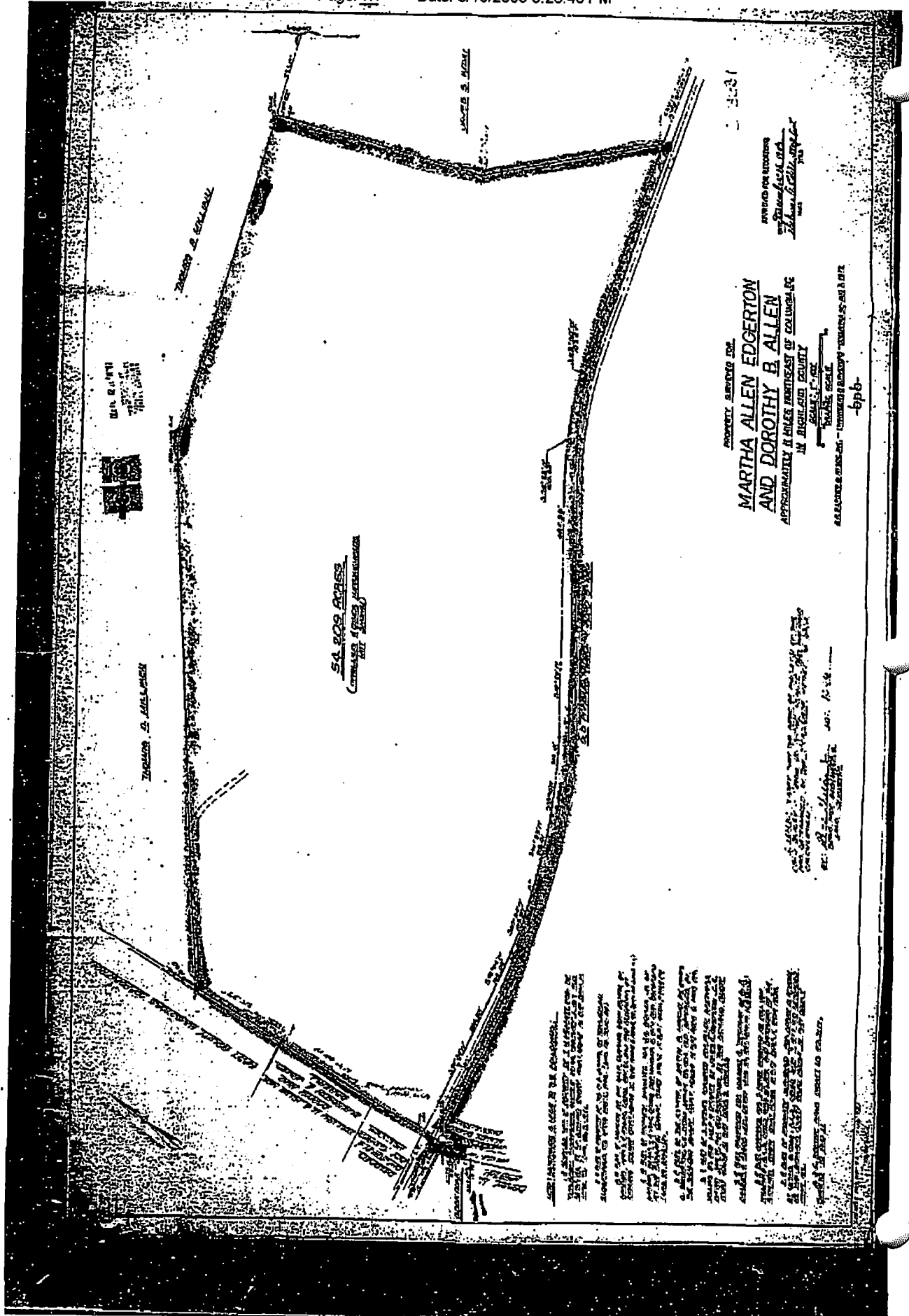

W.D. BARTON  
Surveyor

THOMAS D. ALLEN TRACT

54.200 ACRES  
Containing a Greenhouse

JAMES S. MOYAL

THOMAS D. ALLEN TRACT

THIS INSTRUMENT IS MADE IN WITNESS WHEREOF, the undersigned, the said THOMAS D. ALLEN, has hereunto set his hand and seal of office, at the City of Columbia, South Carolina, this 10th day of August, 2005.

THOMAS D. ALLEN  
Surveyor

PROPERTY SURVEY FOR  
**MARTHA ALLEN EDGERTON  
 AND DOROTHY B. ALLEN**  
 APPROXIMATELY 16 ACRES EAST OF COLUMBIA  
 IN RICHLAND COUNTY

APPROVED FOR RECORDING  
 BY THE CLERK OF THE  
 SUPERIOR COURT

APPROVED FOR RECORDING - RICHLAND COUNTY, SOUTH CAROLINA

-bpb-

# CITY OF COLUMBIA

Address: 54.217 acres  
N/S Old Percival Road

TMS: 22607-01-05

Proposed Use of Property: residential

Purpose of Annexation: water

Council District: 4



City of Columbia - Department of Engineering  
Data represented on this map or plan is the product  
of compilation, as produced by others. It is provided  
for informational purposes only and the City of  
Columbia makes no representation as to its accuracy.  
Its use without field verification is at the sole risk of the user.

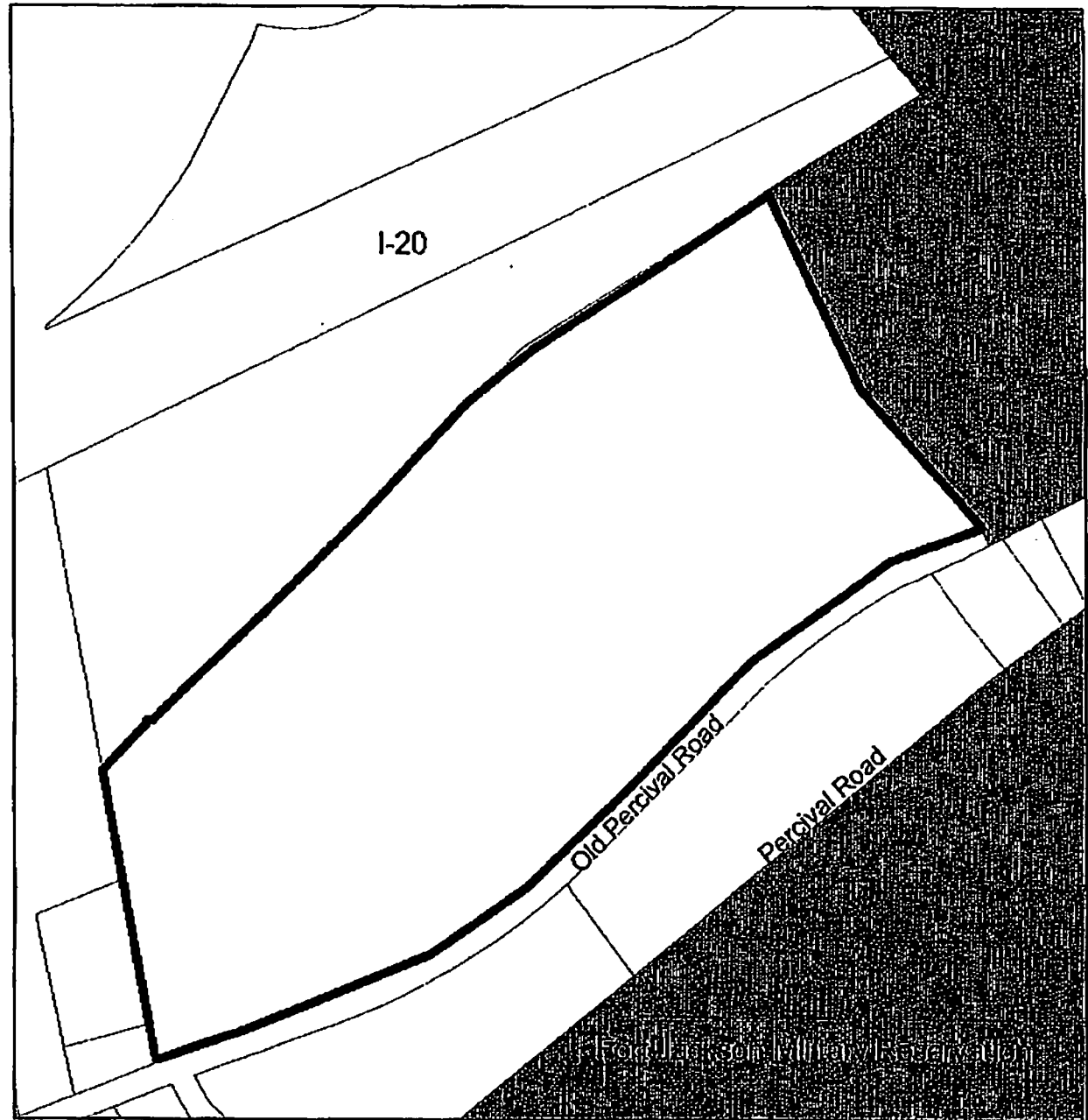

STATE OF SOUTH CAROLINA )  
 ) PETITION FOR ANNEXATION  
COUNTY OF RICHLAND )

The undersigned, being the owner(s) of the property described below hereby petition(s) the Mayor and City Council for annexation to the City of Columbia, South Carolina pursuant to S.C. Code Ann. Section 5-3-150, 1976, as amended.

Property Description: All those certain pieces, parcels or lots of land, with improvements thereon, if any, situate, lying and being near the City of Columbia, in the County of Richland, State of South Carolina, and being shown and delineated as Richland County Tax Map Sheet 22608 Block 01, Lot 01 and Sheet 22608, Block 01, Lot 02. Said parcels having such boundaries and measurements as are shown on said map.

Richland County TMS: 22608-01-01 and 22608-01-02

Property Address: S/S I-20 at Old Percival Road

  
THOMAS O. MILLIKEN

Date: 8-10-05

  
THOMAS S. GLAZEBROOK, JR.

Date: 8/10/05

MALANUK INVESTMENT PARTNERSHIP

BY:   
ROBERT MALANUK  
(Print or Type Name)

Date: 8-10-05

ITS: President

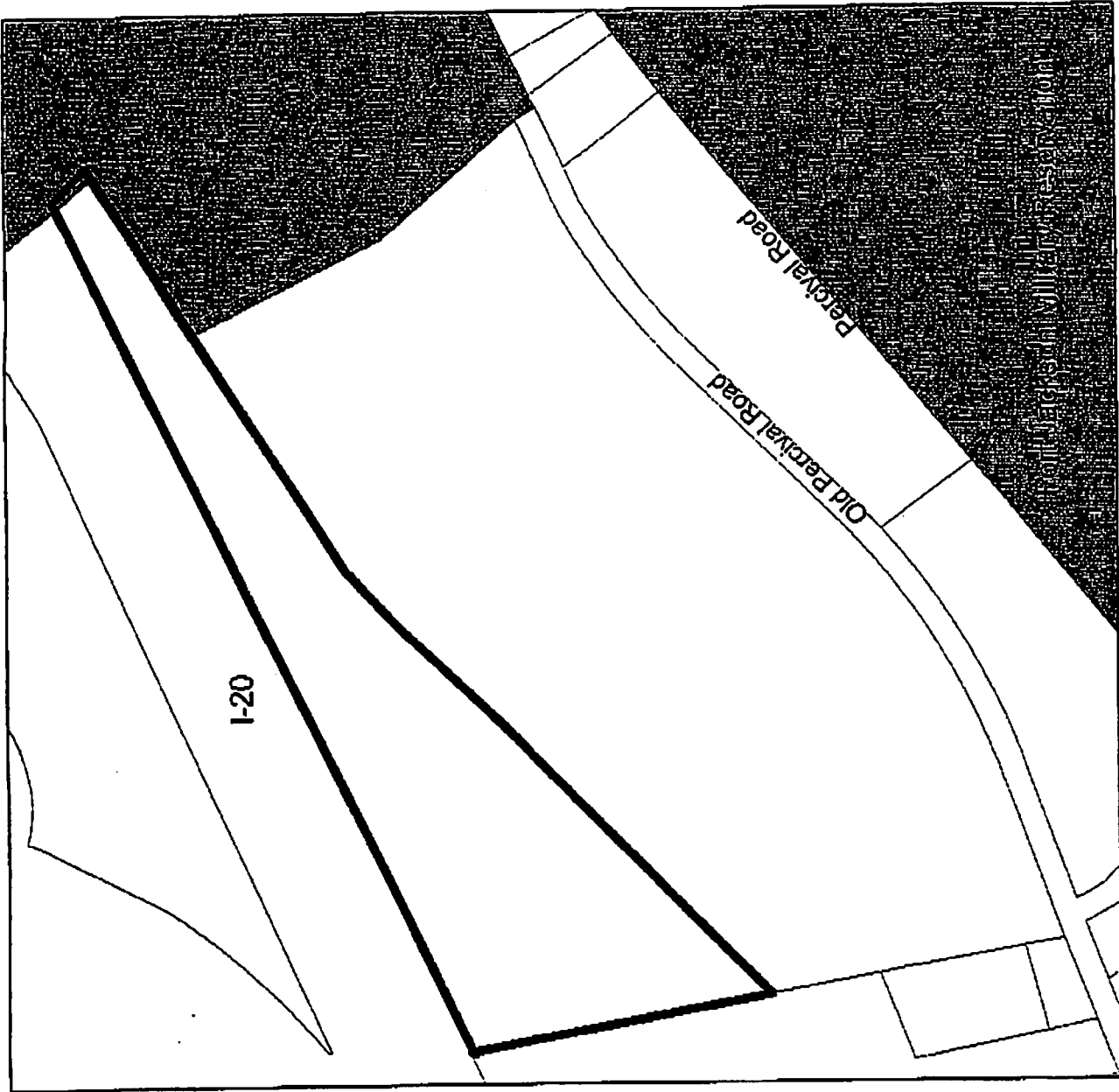

# CITY OF COLUMBIA

Address: 17.23 acres  
S/S I-20 at Old Percival Road

TMS: 22608-01-01 and 22608-01-02

Proposed Use of Property: residential

Purpose of Annexation: water

Council District: 4

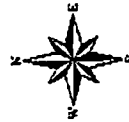

City of Columbia - Department of Engineering  
 Data represented on this map or plan is the product  
 of compilation, as produced by others. It is provided  
 for informational purposes only and the City of  
 Columbia makes no representation as to its accuracy.  
 Use without field verification is at the sole risk of the user.

