

ORDINANCE NO.: 2018-005

Granting an Easement to South Carolina Electric and Gas Company (SCE&G) along a Portion of City-Owned Property Identified as 1900 Calhoun Street, Richland County TMS#11404-05-01 for Relocation of a Transmission Line for the Bull Street Development Project; CF#250-426

ORIGINAL
STAMPED IN RED

WHEREAS, South Carolina Electric & Gas Company (SCE&G) has made a request for an easement along the subject City-owned property for relocation of a transmission line for the Bull Street Development project; and,

WHEREAS, the plans for the new transmission line have been reviewed and approved by the Department of Engineering and there are no conflicts with existing utilities, planned City utilities or the structures and improvements on the subject property; NOW, THEREFORE,

BE IT ORDAINED by the Mayor and City Council of the City of Columbia, South Carolina this 18th day of September, 2018, for and in consideration of the sum of One and No/100 (\$1.00) Dollar, each to the other paid, the City Manager is hereby authorized to execute an easement on behalf of the City of Columbia to **SOUTH CAROLINA ELECTRIC & GAS COMPANY** for ingress, egress, installation and maintenance of street lights and appurtenances along the subject properties.

The referenced easement is shown on a drawing prepared for "Relocation of the Lyles-Uptown 115 kV; Lyles-Calhoun Street Section Crossing Property of the City of Columbia", sheet 1 of 1, dated December 9, 2015, last revised November 2, 2016, Project #PB - 09177 - 60304, and being on file in the office of the Department of Engineering under City file reference #250-426. A copy of said drawing being attached hereto and made a part hereof as Exhibit "A".

Requested by:

Assistant City Manager Shealy



Mayor

Approved by:



City Manager

Approved as to form:



City Attorney

ATTEST:



City Clerk

Introduced: 9/4/2018
Final Reading: 9/18/2018

ORDINANCE NO.: 2018-005
SCE&G PROJECT# PB - 09177 - 60304
PROJECT NAME: RELOCATION OF TRANSMISSION LINE;
LYLES - UPTOWN 115 kV; CALHOUN STREET SECTION

EXHIBIT "A"

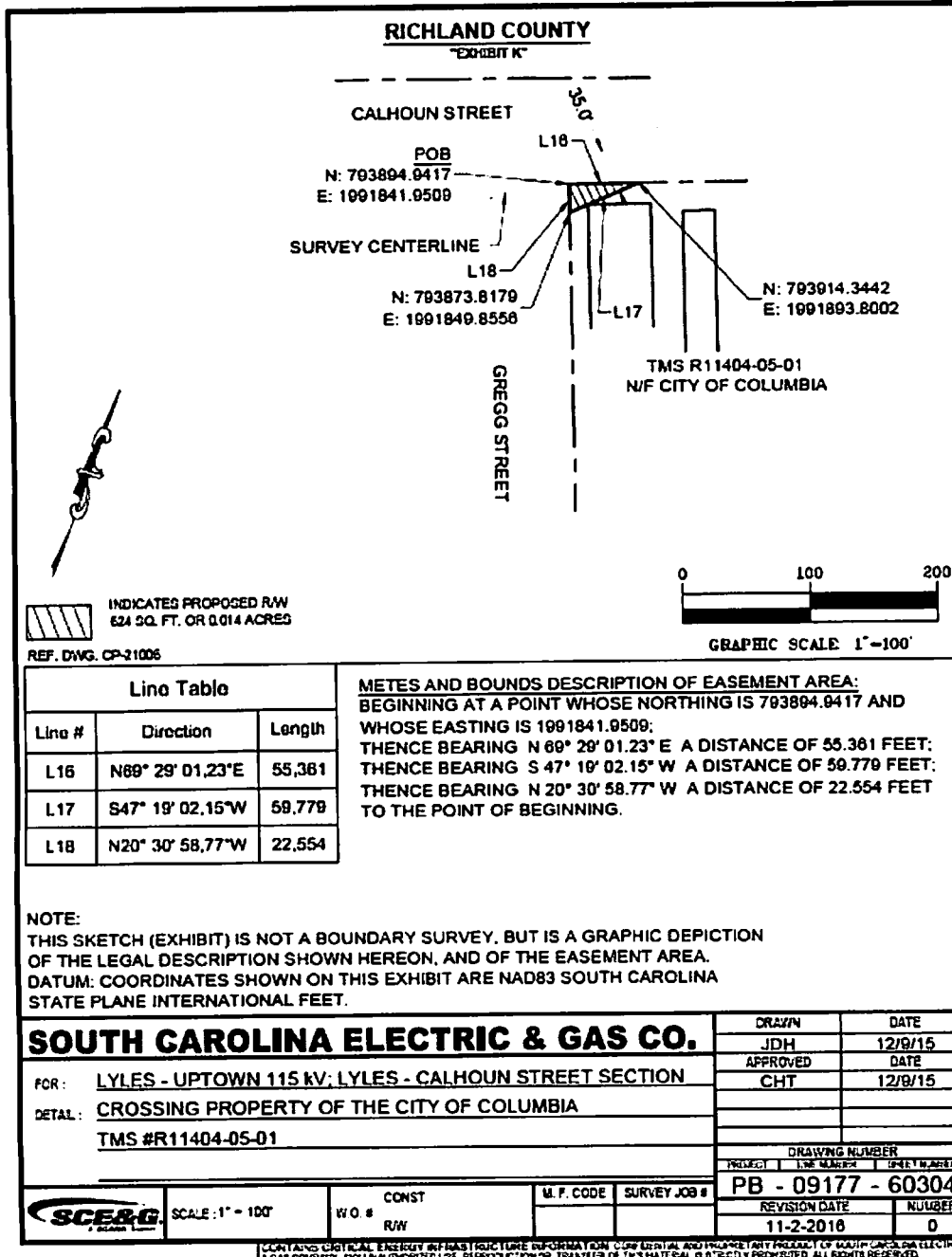

CF#250-426