

RESOLUTION R-2009-046

**RELEASE AND ABANDONMENT OF A PORTION OF THE CITY'S EXISTING 20'  
SANITARY SEWER EASEMENT ALONG RICHLAND COUNTY TMS#07413-03-01 (PORTION);  
4500 WILLIAMSBURG DRIVE; LOT 5, BLOCK G, RIVERVIEW TERRACE; CF#50-79A**

WHEREAS, a 20' sanitary sewer easement was granted to the City of Columbia from Marvin B. Chitwood and E. Ellison Walker over an existing 18" sanitary sewer outfall line that extended through a portion of Riverview Terrace, Lots 5, 4, 3, 2 and 1 in Block G on March 30, 1963 and recorded in the Office of the Register of Deeds for Richland County on April 5, 1963 in Deed Book 352, Page 432; and

WHEREAS, subsequently a portion of the sanitary sewer outfall line was relocated beginning at a manhole on Lot 5, Block G, Riverview Terrace and extending along a portion of said Lot 5 and Williamsburg Drive to a manhole near the northern property corner of Lot 2, Block G. The new sanitary sewer line (Line H-H) and easements were conveyed to the City of Columbia by Marvin B. Chitwood and E. Ellison Walker by deed dated June 26, 1963 and recorded in the Office of the Register of Deeds for Richland County on July 1, 1963 in Deed Book 359, Page 421; and

WHEREAS, the City Engineer has determined that the abandoned portion of the sanitary sewer outfall line provides no services to the adjacent properties and is no longer needed; NOW, THEREFORE,

BE IT RESOLVED by the Mayor and City Council this 5th day of August, 2009, for and in consideration of the sum of One (\$1.00) Dollar, each to the other paid, the receipt of which is hereby acknowledged, the City Manager is hereby authorized to execute a release and abandonment instrument from the City of Columbia that remises, releases and forever quitclaims unto the CLARENCE SMITH or current owners of the subject property, his heirs, successors and assigns, that portion of the City's existing 20' sanitary sewer easement along Lot 5, Block G, Riverview Terrace, being more clearly shown on the drawing prepared by the City of Columbia, Department of Utilities & Engineering, dated May 7, 2009, sheet 4 of 4, being attached hereto and made a part hereof as Exhibit "A".

Said drawing also being on file in the Department of Utilities and Engineering under file reference #50-79A.

Requested by:  
Utilities and Engineering Department

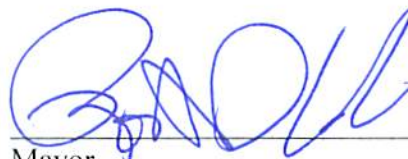
  
\_\_\_\_\_  
Mayor

Approved by:  
  
\_\_\_\_\_  
Interim City Manager

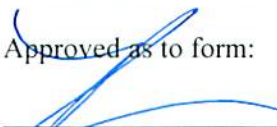
Approved as to form:  
  
\_\_\_\_\_  
City Attorney

ATTEST:  
  
\_\_\_\_\_  
City Clerk

Introduced 8/5/2009

Final Reading 8/5/2009

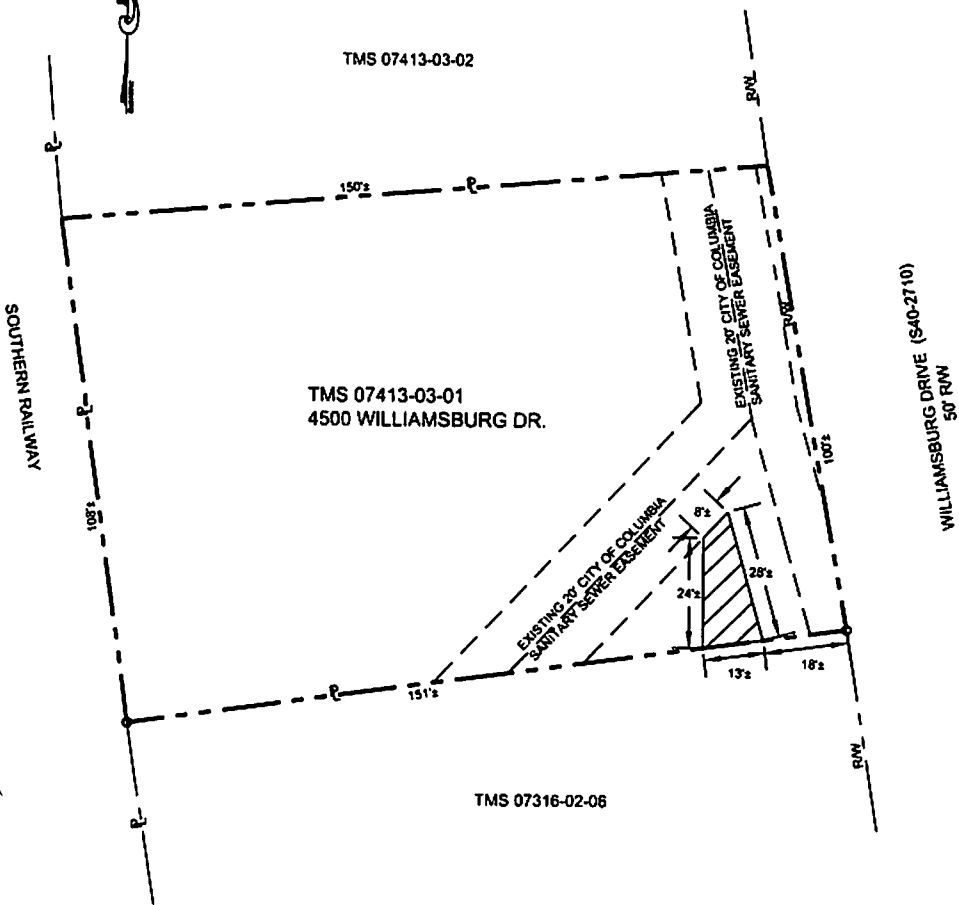

DRAWING BASED ON COMPILATIONS ONLY.  
 NO PROPERTY SURVEY PERFORMED.  
 REFERENCE:  
 (1) RICHLAND COUNTY TMS 07413; 2009 EDITION  
 (2) SANITARY SEWER SYSTEM FOR RIVERVIEW  
 TERRACE; CF# 50-79

N/F  
 CLARENCE SMITH  
 4415 WILLIAMSBURG DR.  
 COLUMBIA, SC 29203  
 TMS 07413-03-01  
 PERMANENT EASEMENT=  
 0.005 ACRES

CF# 50-79A

CITY OF COLUMBIA DEPARTMENT OF UTILITIES & ENGINEERING COLUMBIA, SOUTH CAROLINA		
SCALE: NTS	APPROVED BY:	DRAWN BY:
DATE: 5/07/09		JPM
ABANDONMENT OF 20' EASEMENT FOR THE ABANDONED SANITARY SEWER LINE ALONG LOTS ON WILLIAMSBURG DR.		
PROJECT NO.:	DWG.No. 4 OF 4	
REVISION NO.:	DATE:	

56 RiverView Terrace  
 09060953 R-2009-046