

**RESOLUTION NO.: R-2018-055**

*Authorizing Acceptance and Dedication of streets known as a portion of Allan's Mill Drive, Beardmore Court, Calabash Lane, Peppercorn Lane and a portion of Sorrel Tree Drive in Allan's Mill Subdivision, Phase 1 to the City of Columbia, Richland County TMS#22608-01-08 (Portion); CF# 296-02*

ORIGINAL  
STAMPED IN RED

WHEREAS, the referenced streets are located in the City limits of Columbia and are identified as a portion of Allan's Mill Drive, Beardmore Court, Calabash Lane and a portion of Sorrel Tree Drive. The approval of the development plans for Allan's Mill Subdivision, Phase 1 included dedication of the aforesaid streets to the City of Columbia; and,

WHEREAS, the Construction Management Division has inspected the streets on the said property and found that they were constructed in compliance with the City's ordinances and regulations and recommends approval for acceptance; NOW, THEREFORE,

BE IT RESOLVED by the Mayor and City Council of the City of Columbia, South Carolina this day 19th day of June, 2018 that the City of Columbia accepts dedication of the aforesaid streets known as a portion of Allan's Mill Drive, Beardmore Court, Calabash Lane, Peppercorn Lane and a portion of Sorrel Tree Drive located in Allan's Mill Subdivision, Phase 1.

Allan's Mill Subdivision is located off of Old Percival Road and adjacent to Sweetwater Subdivision, Phase 1 at Smallwood in District No. 2 and was annexed into City limits on June 1, 1973. The said streets are located as shown on a final plat of Allan's Mill Subdivision, Phase 1, dated October 19, 2016 and being on file in the office of the Department of Engineering, City of Columbia, South Carolina under City file reference #296-02. A copy of said plat being attached hereto and made a part hereof as Exhibit "A".

Requested by:

Assistant City Manager Shealy

  
MAYOR

Approved by:

  
Cheryl Wilson  
City Manager

Approved as to form:

  
City Attorney

ATTEST:

  
Erika D. Meow  
City Clerk

Introduced: 6/19/2018  
Final Reading: 6/19/2018

**ALLAN'S MILL SUBDIVISION PHASE I**  
**LEXINGTON INVESTMENT GROUP, LLC**

PLANNED BY: LEXINGTON INVESTMENT GROUP, LLC  
 ENGINEER: [Name]  
 DATE: [Date]



THIS PLAN IS THE PROPERTY OF LEXINGTON INVESTMENT GROUP, LLC. IT IS TO BE USED ONLY FOR THE PROJECT AND AREA DESCRIBED HEREON. ANY REPRODUCTION OR USE OF THIS PLAN WITHOUT THE WRITTEN CONSENT OF LEXINGTON INVESTMENT GROUP, LLC IS STRICTLY PROHIBITED.

THE PLANNED DEVELOPMENT OF THIS PROJECT IS SUBJECT TO THE APPROVAL OF THE LOCAL GOVERNMENT AND THE STATE DEPARTMENT OF TRANSPORTATION. THE PLANNED DEVELOPMENT IS SUBJECT TO THE APPROVAL OF THE LOCAL GOVERNMENT AND THE STATE DEPARTMENT OF TRANSPORTATION.

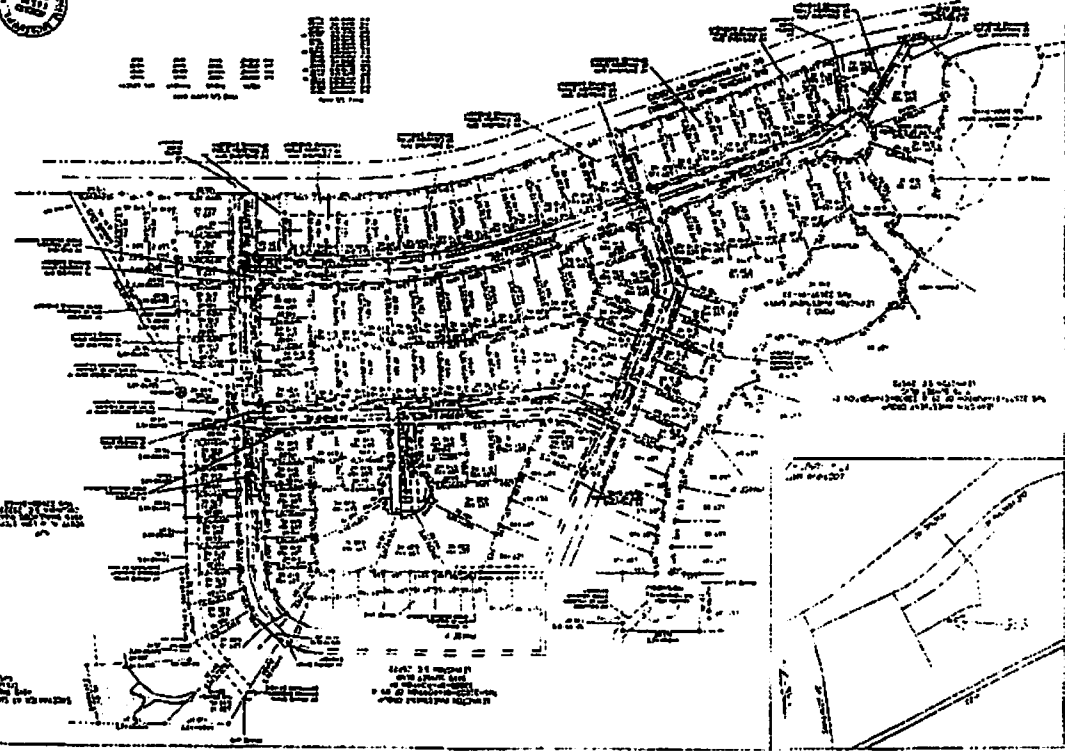
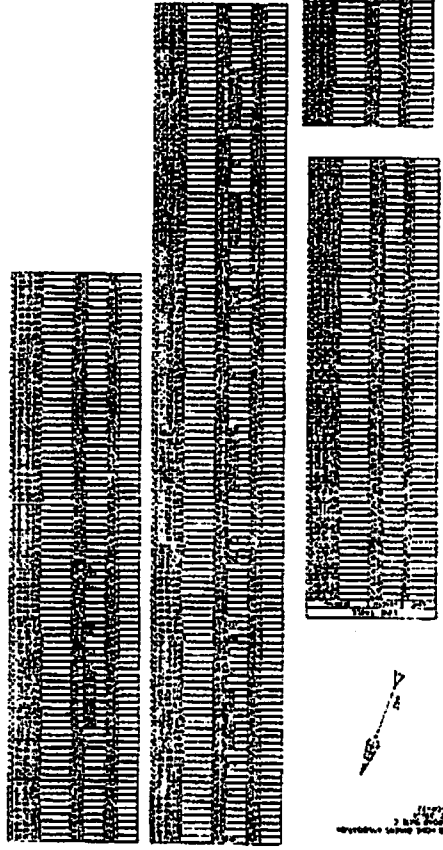

**EXHIBIT A**