

ORIGINAL
STAMPED IN RED

RESOLUTION NO.: R-2018-091

*Authorizing the City Manager to execute a Release of Parking Restrictions
Between the City of Columbia and Devine District Residential, LLC for property known as
0.72 acres and 0.56 acres on northwestern corner of Maple Street and Devine Street*

BE IT RESOLVED by the Mayor and City Council this 18th day of September, 2018, that the City Manager is hereby authorized to execute the attached Release of Parking Restrictions, or on a form approved by the City Attorney, between the City of Columbia and Devine District Residential, LLC for property known as 0.72 acres and 0.56 acres on northwestern corner of Maple Street and Devine Street.

Requested by:

Assistant City Manager Gentry



Mayor

Approved by:



City Manager

Approved as to form:



City Attorney

ATTEST:



City Clerk

Introduced: 9/18/2018

Final Reading: 9/18/2018

EXHIBIT A

All that piece, parcel or lot of land, situate, lying and being on the north side of Lee Street near its intersection with Maple Street, in the Shandon section of the City of Columbia, County of Richland, State of South Carolina, containing 0.72 acres, and being more particularly shown and delineated on a plat of same prepared by Cox and Dinkins, Inc., Engineers-Surveyors, said lot being more particularly described as follows, to wit: BEGINNING at an iron 104 feet S 89 degrees 53 minutes W from the northwest corner of the intersection of Maple and Lee Streets; thence running S 89 degrees 53 minutes W for a distance of 166.74 feet to an iron; thence turning and running N 00 degrees 7 minutes W for a distance of 207.4 feet to an iron; thence turning and running N 89 degrees 42 minutes E for a distance of 135.84 feet to an iron; thence turning and running S 00 degrees 14 minutes W for a distance of 103.47 feet to an iron; thence turning and running N 89 degrees 49 minutes E for a distance of 31.76 feet to an iron; thence turning and running due south for a distance of 104.43 feet to the iron at the point of BEGINNING; be all measurements a little more or less. The plat above referred to is recorded in the BMC Office for Richland County in Plat Book 50 at page 1914.

EXHIBIT B

All that piece, parcel or lot of land located at the north-western corner of the intersection of Devine and Maple Streets, in the Shandon section of the City of Columbia, County of Richland, State of South Carolina, containing 0.56 acre, and being more particularly shown and delineated on a plat of same prepared for Leon S. Goodall by Cox and Dinkins, Inc., Registered Land Surveyors, on January 21, 1965; said lot being more particularly described as follows, to wit: BEGINNING at an iron at the northwest corner of Devine and Maple Streets and thence running N 82 degrees 47 minutes W for a distance of 164.50 feet to an iron; thence turning and running N 7 degrees 11 minutes E for a distance of 147.76 feet to an iron; thence turning and running S 82 degrees 45 minutes E for a distance of 164.57 feet to an iron; thence turning and running S 7 degrees 13 minutes W for a distance of 147.69 feet to the iron at the point of BEGINNING; be all measurements a little more or less. The plat referred to above is recorded in the RMC Office for Richland County in Plat Book 50 at page 1933.

EXHIBIT D

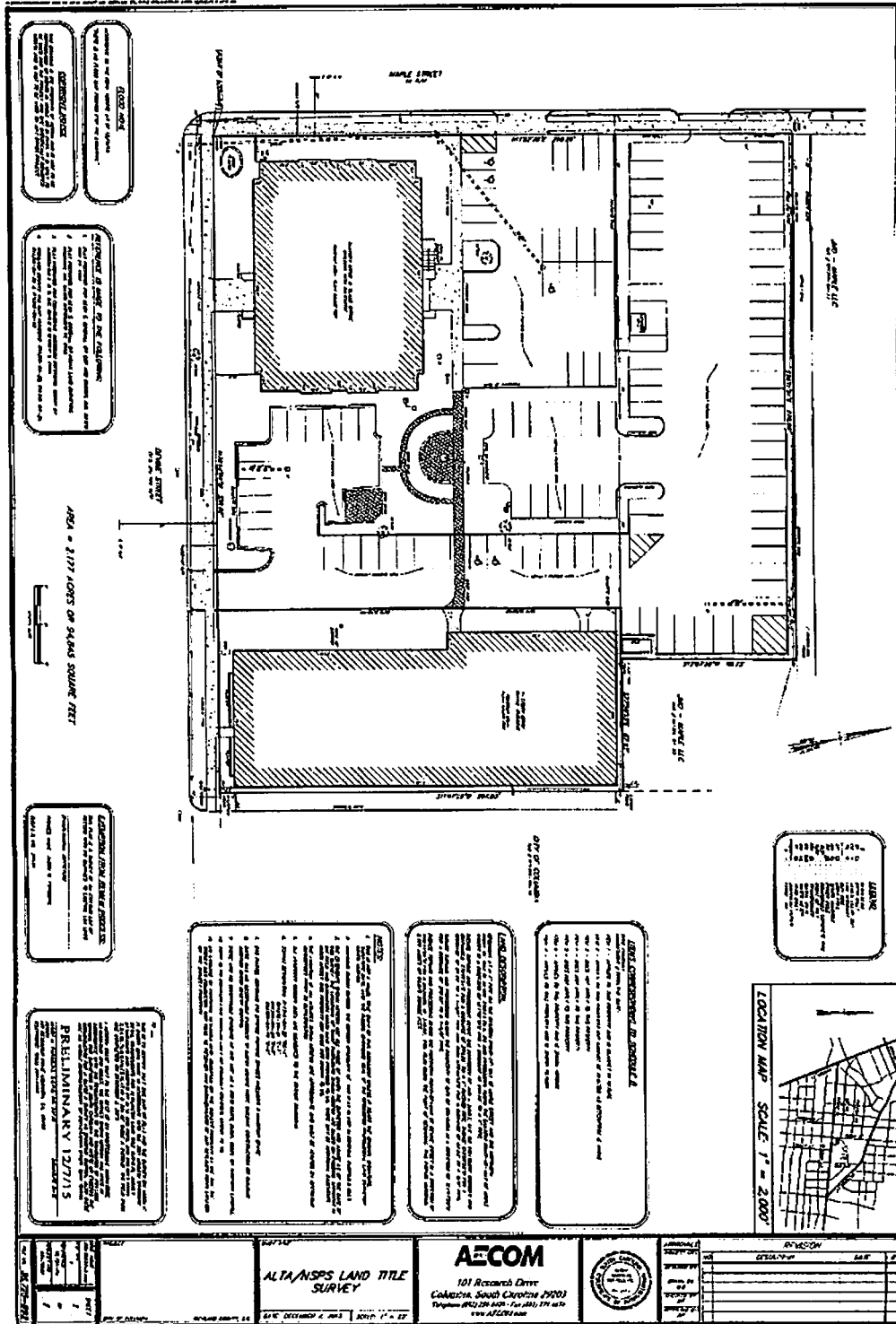

GENERAL NOTES

1. ALL DIMENSIONS ARE IN FEET AND INCHES.
2. FINISHES ARE AS NOTED.
3. SEE SPECIFICATIONS FOR MATERIALS AND METHODS OF CONSTRUCTION.
4. THE CONTRACTOR SHALL BE RESPONSIBLE FOR OBTAINING ALL NECESSARY PERMITS AND APPROVALS.
5. THE CONTRACTOR SHALL MAINTAIN ACCESS TO ALL ADJACENT PROPERTIES AT ALL TIMES.
6. THE CONTRACTOR SHALL PROTECT ALL EXISTING UTILITIES AND STRUCTURES.
7. THE CONTRACTOR SHALL MAINTAIN THE EXISTING CURBS AND SIDEWALKS.
8. THE CONTRACTOR SHALL MAINTAIN THE EXISTING DRIVEWAYS AND PAVEMENT.
9. THE CONTRACTOR SHALL MAINTAIN THE EXISTING LANDSCAPING.
10. THE CONTRACTOR SHALL MAINTAIN THE EXISTING UTILITIES AND STRUCTURES.

GENERAL NOTES

1. ALL DIMENSIONS ARE IN FEET AND INCHES.
2. FINISHES ARE AS NOTED.
3. SEE SPECIFICATIONS FOR MATERIALS AND METHODS OF CONSTRUCTION.
4. THE CONTRACTOR SHALL BE RESPONSIBLE FOR OBTAINING ALL NECESSARY PERMITS AND APPROVALS.
5. THE CONTRACTOR SHALL MAINTAIN ACCESS TO ALL ADJACENT PROPERTIES AT ALL TIMES.
6. THE CONTRACTOR SHALL PROTECT ALL EXISTING UTILITIES AND STRUCTURES.
7. THE CONTRACTOR SHALL MAINTAIN THE EXISTING CURBS AND SIDEWALKS.
8. THE CONTRACTOR SHALL MAINTAIN THE EXISTING DRIVEWAYS AND PAVEMENT.
9. THE CONTRACTOR SHALL MAINTAIN THE EXISTING LANDSCAPING.
10. THE CONTRACTOR SHALL MAINTAIN THE EXISTING UTILITIES AND STRUCTURES.

GENERAL NOTES

1. ALL DIMENSIONS ARE IN FEET AND INCHES.
2. FINISHES ARE AS NOTED.
3. SEE SPECIFICATIONS FOR MATERIALS AND METHODS OF CONSTRUCTION.
4. THE CONTRACTOR SHALL BE RESPONSIBLE FOR OBTAINING ALL NECESSARY PERMITS AND APPROVALS.
5. THE CONTRACTOR SHALL MAINTAIN ACCESS TO ALL ADJACENT PROPERTIES AT ALL TIMES.
6. THE CONTRACTOR SHALL PROTECT ALL EXISTING UTILITIES AND STRUCTURES.
7. THE CONTRACTOR SHALL MAINTAIN THE EXISTING CURBS AND SIDEWALKS.
8. THE CONTRACTOR SHALL MAINTAIN THE EXISTING DRIVEWAYS AND PAVEMENT.
9. THE CONTRACTOR SHALL MAINTAIN THE EXISTING LANDSCAPING.
10. THE CONTRACTOR SHALL MAINTAIN THE EXISTING UTILITIES AND STRUCTURES.

GENERAL NOTES

1. ALL DIMENSIONS ARE IN FEET AND INCHES.
2. FINISHES ARE AS NOTED.
3. SEE SPECIFICATIONS FOR MATERIALS AND METHODS OF CONSTRUCTION.
4. THE CONTRACTOR SHALL BE RESPONSIBLE FOR OBTAINING ALL NECESSARY PERMITS AND APPROVALS.
5. THE CONTRACTOR SHALL MAINTAIN ACCESS TO ALL ADJACENT PROPERTIES AT ALL TIMES.
6. THE CONTRACTOR SHALL PROTECT ALL EXISTING UTILITIES AND STRUCTURES.
7. THE CONTRACTOR SHALL MAINTAIN THE EXISTING CURBS AND SIDEWALKS.
8. THE CONTRACTOR SHALL MAINTAIN THE EXISTING DRIVEWAYS AND PAVEMENT.
9. THE CONTRACTOR SHALL MAINTAIN THE EXISTING LANDSCAPING.
10. THE CONTRACTOR SHALL MAINTAIN THE EXISTING UTILITIES AND STRUCTURES.

PRELIMINARY 12/7/15

THIS DRAWING IS A PRELIMINARY DRAWING AND IS NOT TO BE USED FOR CONSTRUCTION. IT IS SUBJECT TO CHANGE WITHOUT NOTICE. THE CONTRACTOR SHALL BE RESPONSIBLE FOR OBTAINING ALL NECESSARY PERMITS AND APPROVALS.

GENERAL NOTES

1. ALL DIMENSIONS ARE IN FEET AND INCHES.
2. FINISHES ARE AS NOTED.
3. SEE SPECIFICATIONS FOR MATERIALS AND METHODS OF CONSTRUCTION.
4. THE CONTRACTOR SHALL BE RESPONSIBLE FOR OBTAINING ALL NECESSARY PERMITS AND APPROVALS.
5. THE CONTRACTOR SHALL MAINTAIN ACCESS TO ALL ADJACENT PROPERTIES AT ALL TIMES.
6. THE CONTRACTOR SHALL PROTECT ALL EXISTING UTILITIES AND STRUCTURES.
7. THE CONTRACTOR SHALL MAINTAIN THE EXISTING CURBS AND SIDEWALKS.
8. THE CONTRACTOR SHALL MAINTAIN THE EXISTING DRIVEWAYS AND PAVEMENT.
9. THE CONTRACTOR SHALL MAINTAIN THE EXISTING LANDSCAPING.
10. THE CONTRACTOR SHALL MAINTAIN THE EXISTING UTILITIES AND STRUCTURES.

GENERAL NOTES

1. ALL DIMENSIONS ARE IN FEET AND INCHES.
2. FINISHES ARE AS NOTED.
3. SEE SPECIFICATIONS FOR MATERIALS AND METHODS OF CONSTRUCTION.
4. THE CONTRACTOR SHALL BE RESPONSIBLE FOR OBTAINING ALL NECESSARY PERMITS AND APPROVALS.
5. THE CONTRACTOR SHALL MAINTAIN ACCESS TO ALL ADJACENT PROPERTIES AT ALL TIMES.
6. THE CONTRACTOR SHALL PROTECT ALL EXISTING UTILITIES AND STRUCTURES.
7. THE CONTRACTOR SHALL MAINTAIN THE EXISTING CURBS AND SIDEWALKS.
8. THE CONTRACTOR SHALL MAINTAIN THE EXISTING DRIVEWAYS AND PAVEMENT.
9. THE CONTRACTOR SHALL MAINTAIN THE EXISTING LANDSCAPING.
10. THE CONTRACTOR SHALL MAINTAIN THE EXISTING UTILITIES AND STRUCTURES.

GENERAL NOTES

1. ALL DIMENSIONS ARE IN FEET AND INCHES.
2. FINISHES ARE AS NOTED.
3. SEE SPECIFICATIONS FOR MATERIALS AND METHODS OF CONSTRUCTION.
4. THE CONTRACTOR SHALL BE RESPONSIBLE FOR OBTAINING ALL NECESSARY PERMITS AND APPROVALS.
5. THE CONTRACTOR SHALL MAINTAIN ACCESS TO ALL ADJACENT PROPERTIES AT ALL TIMES.
6. THE CONTRACTOR SHALL PROTECT ALL EXISTING UTILITIES AND STRUCTURES.
7. THE CONTRACTOR SHALL MAINTAIN THE EXISTING CURBS AND SIDEWALKS.
8. THE CONTRACTOR SHALL MAINTAIN THE EXISTING DRIVEWAYS AND PAVEMENT.
9. THE CONTRACTOR SHALL MAINTAIN THE EXISTING LANDSCAPING.
10. THE CONTRACTOR SHALL MAINTAIN THE EXISTING UTILITIES AND STRUCTURES.



<p>ALTA/NSPS LAND TITLE SURVEY</p> <p>101 Research Drive Columbia, South Carolina 29203 Telephone (803) 291-4000 - Fax (803) 291-4000 www.ALTA.com</p>	<p>AECOM</p>		<p>BY: <u> </u> DATE: <u> </u></p>	
			<p>SCALE: 1" = 2,000'</p>	<p>DATE: <u> </u></p>