

RESOLUTION NO.: R-2018-115

Authorizing the City Manager to execute a Purchase Agreement for Bulk Water to Stonegate Subdivision between the City of Columbia and Carolina Water Service

BE IT RESOLVED by the Mayor and City Council this 8th day of January, 2019, that the City Manager is authorized to execute the attached Purchase Agreement for Bulk Water to Stonegate Subdivision, or on a form approved by the City Attorney, between the City of Columbia and Carolina Water Service, Inc.

Requested by:

Assistant City Manager Shealy



Mayor

Approved by:



City Manager

Approved as to form:



City Attorney

ATTEST:



City Clerk

Introduced: 1/8/2019

Final Reading: 1/8/2019

ORIGINAL
STAMPED IN RED

EXHIBIT A
SERVICE AREA

Parcel

Stonegate Service Area

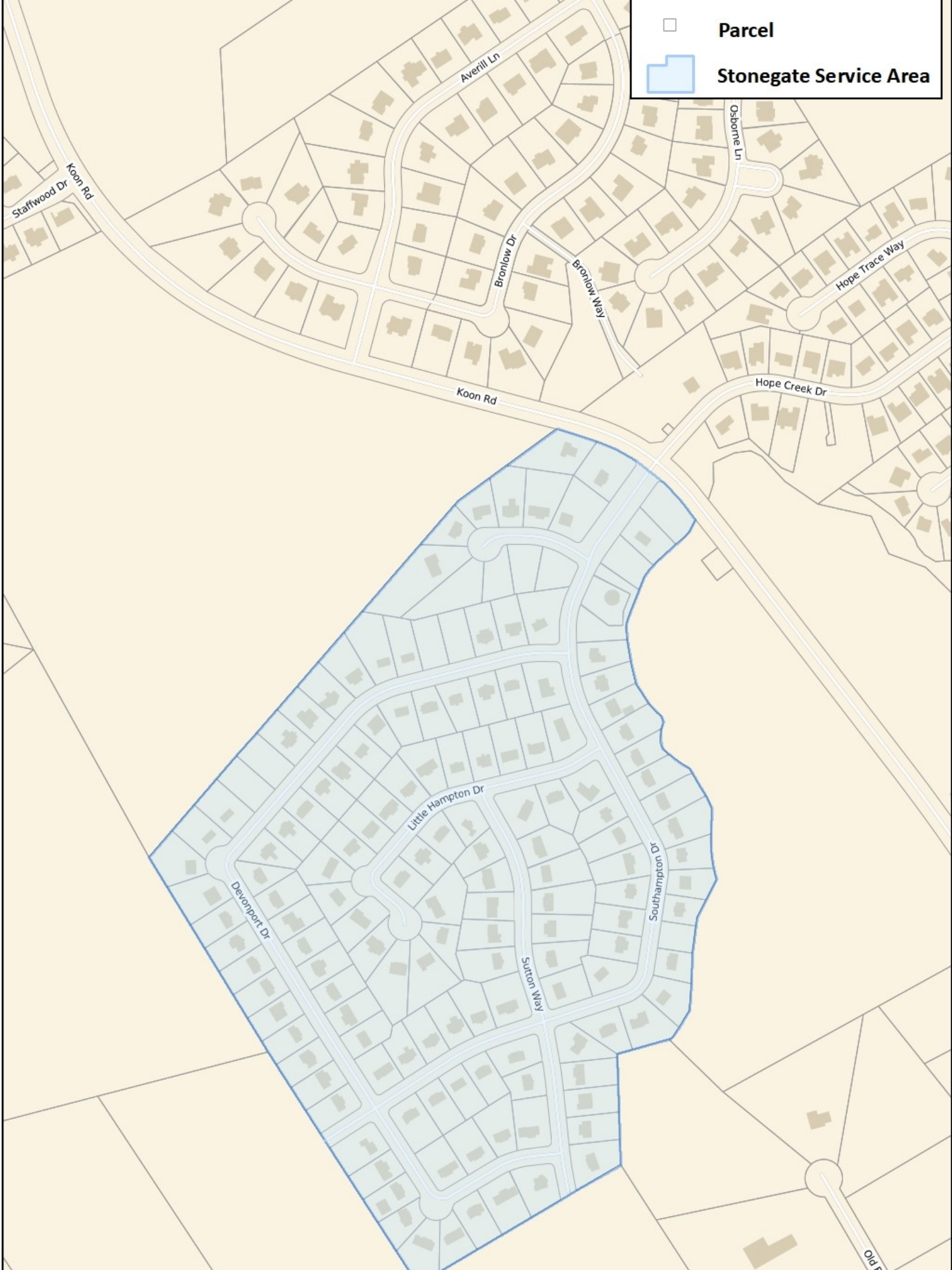
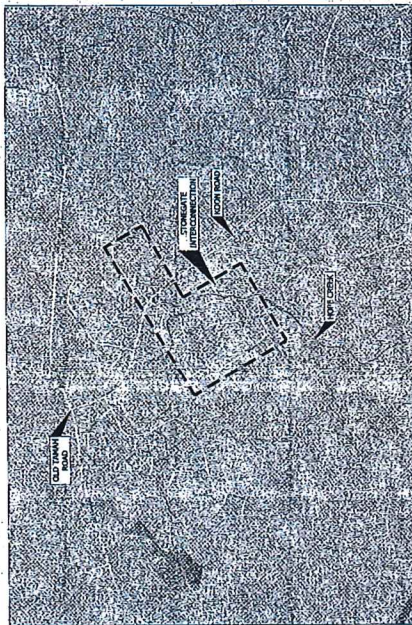

EXHIBIT B

APPROVED CONSTRUCTION PLANS

STONEGATE WATER SYSTEM INTERCONNECTION IN RICHLAND COUNTY, SOUTH CAROLINA

WK DICKSON PROJECT NO: 20170068.00.CA



LOCATION MAP
1" = 1000'

CAROLINA WATER SERVICE, INC.
BOB GILROY, VICE PRESIDENT
150 FOSTER BROTHERS DRIVE
WEST COLUMBIA, SC 29172
TELEPHONE NUMBER: (803) 796-2313



NOTICE TO CONTRACTOR
THE CONTRACTOR SHALL BE RESPONSIBLE FOR LOCATING ALL UNDERGROUND UTILITIES (PUBLIC OR PRIVATE) THAT MAY EXIST AND CHANGING ON THE PLANS OR NOT. CALL 811 OR 1-800-721-7871 A MINIMUM OF 72 HOURS PRIOR TO DIGGING OR EXCAVATING. REPAIRS TO ANY UTILITY DAMAGED RESULTING FROM THE CONTRACTOR'S ACTIVITIES SHALL BE THE RESPONSIBILITY OF THE CONTRACTOR.

CAROLINA WATER SERVICE, INC.
150 FOSTER BROTHERS DRIVE
WEST COLUMBIA, SC 29172
PHONE: (803) 796-2313
FAX: (803) 796-2311



WK DICKSON
community infrastructure consultants

REV. RECORD	DATE	DESCRIPTION

REV. RECORD	DATE	DESCRIPTION



APPROVED
CITY OF COLUMBIA
UTILITIES & ENGINEERING
DEPARTMENT

SCANNED

Sheet Number	Sheet Title
00	COVER
01	GENERAL NOTES & LEGEND
02	WATER DISTRIBUTION SYSTEM
03	PROPOSED IMPROVEMENTS PLAN
04	PROPOSED INTERCONNECTION
05	INTERFERING
06	WATER DETAILS
07	SITE DETAILS

DRAWING STATUS: SUBMITTAL TO CITY OF COLUMBIA ENGINEERING

<p>PROJECT NAME: STONEGATE WATER SYSTEM INTERCONNECTION</p> <p>COVER</p>	<p>DRAWING NUMBER: C0</p> <p>DATE: 2/28/2018</p>	<p>WPK PROJECT: 20170068.00.CA</p> <p>DATE: NOV 2017</p> <p>PROJECT NO: 20170068.00.CA</p> <p>DATE: NOV 2017</p>
--	--	--

WK DICKSON PROJECT NO: 20170068.00.CA
 File CP# 345-06
 COPYRIGHT © WK DICKSON & CO., INC. ALL RIGHTS RESERVED. REPRODUCTION OR USE OF THE CONTENT OF THIS DOCUMENT, WITHOUT WRITTEN CONSENT OF WK DICKSON & CO., INC. IS PROHIBITED. ONLY COPIES FROM THE ORIGINAL, APPROVED PROJECT SHALL BE CONSIDERED TO BE VALID. THIS COPIES.



DATE	DESCRIPTION

PROJECT NAME: STONEGATE WATER SYSTEM INTERCONNECTION
 DRAWING TITLE: STONEGATE WATER SYSTEM INTERCONNECTION
 GENERAL NOTES & LEGEND

SCALE: 1" = 10'-0"
 DATE: 11/15/2017
 DRAWING NUMBER: C1
 WPD PROJ. NO.: 2017008001CA

DRIVING STATUS: SUBMITTAL TO CITY OF COLUMBIA ENGINEERING

SCANNED

APPROVED
 CITY OF COLUMBIA
 UTILITIES & ENGINEERING
 DEPARTMENT

- SERVICE NOTES:**
1. PROPERTY INFORMATION AND DOCUMENTS: PROPERTY PLOT, RECORDS & C.O.C. DATED 11/14/2017.
 2. ALL UTILITIES SHOWN ARE BASED ON THE LATEST AVAILABLE RECORDS THAT ARE AVAILABLE AND NOT NEARER THE LIMITS OF THE PROPERTY. INCLUDES BUT NOT LIMITED TO: WATER, GAS, ELECTRIC, TELEPHONE, AND CABLE TELEVISION.
 3. VERIFY ALL UTILITIES BEFORE CONSTRUCTION.
 4. CONSTRUCTION SHALL BE IN ACCORDANCE WITH THE CITY OF COLUMBIA UTILITIES DEPARTMENT STANDARDS AND SPECIFICATIONS.
 5. ALL UTILITIES SHALL BE PROTECTED AND MAINTAINED AT ALL TIMES. ANY DAMAGE TO UTILITIES SHALL BE REPAIRED AT THE CONTRACTOR'S EXPENSE.
 6. THE CONTRACTOR SHALL BE RESPONSIBLE FOR OBTAINING ALL NECESSARY PERMITS AND APPROVALS FROM THE CITY OF COLUMBIA UTILITIES DEPARTMENT.

SEEDING SCHEDULE:

1. SEEDING SHALL BE COMPLETED WITHIN THE SPECIFIED TIME FRAME.
2. SEEDING SHALL BE DONE AT THE PROPER TIME OF YEAR TO ENSURE PROPER GROWTH.
3. ALL SEEDING SHALL BE DONE IN ACCORDANCE WITH THE CITY OF COLUMBIA UTILITIES DEPARTMENT STANDARDS AND SPECIFICATIONS.
4. THE CONTRACTOR SHALL BE RESPONSIBLE FOR OBTAINING ALL NECESSARY PERMITS AND APPROVALS FROM THE CITY OF COLUMBIA UTILITIES DEPARTMENT.
5. SEEDING SHALL BE DONE IN ACCORDANCE WITH THE CITY OF COLUMBIA UTILITIES DEPARTMENT STANDARDS AND SPECIFICATIONS.
6. THE CONTRACTOR SHALL BE RESPONSIBLE FOR OBTAINING ALL NECESSARY PERMITS AND APPROVALS FROM THE CITY OF COLUMBIA UTILITIES DEPARTMENT.
7. SEEDING SHALL BE DONE IN ACCORDANCE WITH THE CITY OF COLUMBIA UTILITIES DEPARTMENT STANDARDS AND SPECIFICATIONS.
8. THE CONTRACTOR SHALL BE RESPONSIBLE FOR OBTAINING ALL NECESSARY PERMITS AND APPROVALS FROM THE CITY OF COLUMBIA UTILITIES DEPARTMENT.
9. SEEDING SHALL BE DONE IN ACCORDANCE WITH THE CITY OF COLUMBIA UTILITIES DEPARTMENT STANDARDS AND SPECIFICATIONS.
10. THE CONTRACTOR SHALL BE RESPONSIBLE FOR OBTAINING ALL NECESSARY PERMITS AND APPROVALS FROM THE CITY OF COLUMBIA UTILITIES DEPARTMENT.
11. SEEDING SHALL BE DONE IN ACCORDANCE WITH THE CITY OF COLUMBIA UTILITIES DEPARTMENT STANDARDS AND SPECIFICATIONS.
12. THE CONTRACTOR SHALL BE RESPONSIBLE FOR OBTAINING ALL NECESSARY PERMITS AND APPROVALS FROM THE CITY OF COLUMBIA UTILITIES DEPARTMENT.
13. SEEDING SHALL BE DONE IN ACCORDANCE WITH THE CITY OF COLUMBIA UTILITIES DEPARTMENT STANDARDS AND SPECIFICATIONS.
14. THE CONTRACTOR SHALL BE RESPONSIBLE FOR OBTAINING ALL NECESSARY PERMITS AND APPROVALS FROM THE CITY OF COLUMBIA UTILITIES DEPARTMENT.
15. SEEDING SHALL BE DONE IN ACCORDANCE WITH THE CITY OF COLUMBIA UTILITIES DEPARTMENT STANDARDS AND SPECIFICATIONS.
16. THE CONTRACTOR SHALL BE RESPONSIBLE FOR OBTAINING ALL NECESSARY PERMITS AND APPROVALS FROM THE CITY OF COLUMBIA UTILITIES DEPARTMENT.
17. SEEDING SHALL BE DONE IN ACCORDANCE WITH THE CITY OF COLUMBIA UTILITIES DEPARTMENT STANDARDS AND SPECIFICATIONS.
18. THE CONTRACTOR SHALL BE RESPONSIBLE FOR OBTAINING ALL NECESSARY PERMITS AND APPROVALS FROM THE CITY OF COLUMBIA UTILITIES DEPARTMENT.
19. SEEDING SHALL BE DONE IN ACCORDANCE WITH THE CITY OF COLUMBIA UTILITIES DEPARTMENT STANDARDS AND SPECIFICATIONS.
20. THE CONTRACTOR SHALL BE RESPONSIBLE FOR OBTAINING ALL NECESSARY PERMITS AND APPROVALS FROM THE CITY OF COLUMBIA UTILITIES DEPARTMENT.

SEEDING SCHEDULE:	SEEDING SCHEDULE:
1. SEEDING SHALL BE COMPLETED WITHIN THE SPECIFIED TIME FRAME.	1. SEEDING SHALL BE COMPLETED WITHIN THE SPECIFIED TIME FRAME.
2. SEEDING SHALL BE DONE AT THE PROPER TIME OF YEAR TO ENSURE PROPER GROWTH.	2. SEEDING SHALL BE DONE AT THE PROPER TIME OF YEAR TO ENSURE PROPER GROWTH.
3. ALL SEEDING SHALL BE DONE IN ACCORDANCE WITH THE CITY OF COLUMBIA UTILITIES DEPARTMENT STANDARDS AND SPECIFICATIONS.	3. ALL SEEDING SHALL BE DONE IN ACCORDANCE WITH THE CITY OF COLUMBIA UTILITIES DEPARTMENT STANDARDS AND SPECIFICATIONS.
4. THE CONTRACTOR SHALL BE RESPONSIBLE FOR OBTAINING ALL NECESSARY PERMITS AND APPROVALS FROM THE CITY OF COLUMBIA UTILITIES DEPARTMENT.	4. THE CONTRACTOR SHALL BE RESPONSIBLE FOR OBTAINING ALL NECESSARY PERMITS AND APPROVALS FROM THE CITY OF COLUMBIA UTILITIES DEPARTMENT.
5. SEEDING SHALL BE DONE IN ACCORDANCE WITH THE CITY OF COLUMBIA UTILITIES DEPARTMENT STANDARDS AND SPECIFICATIONS.	5. SEEDING SHALL BE DONE IN ACCORDANCE WITH THE CITY OF COLUMBIA UTILITIES DEPARTMENT STANDARDS AND SPECIFICATIONS.
6. THE CONTRACTOR SHALL BE RESPONSIBLE FOR OBTAINING ALL NECESSARY PERMITS AND APPROVALS FROM THE CITY OF COLUMBIA UTILITIES DEPARTMENT.	6. THE CONTRACTOR SHALL BE RESPONSIBLE FOR OBTAINING ALL NECESSARY PERMITS AND APPROVALS FROM THE CITY OF COLUMBIA UTILITIES DEPARTMENT.
7. SEEDING SHALL BE DONE IN ACCORDANCE WITH THE CITY OF COLUMBIA UTILITIES DEPARTMENT STANDARDS AND SPECIFICATIONS.	7. SEEDING SHALL BE DONE IN ACCORDANCE WITH THE CITY OF COLUMBIA UTILITIES DEPARTMENT STANDARDS AND SPECIFICATIONS.
8. THE CONTRACTOR SHALL BE RESPONSIBLE FOR OBTAINING ALL NECESSARY PERMITS AND APPROVALS FROM THE CITY OF COLUMBIA UTILITIES DEPARTMENT.	8. THE CONTRACTOR SHALL BE RESPONSIBLE FOR OBTAINING ALL NECESSARY PERMITS AND APPROVALS FROM THE CITY OF COLUMBIA UTILITIES DEPARTMENT.
9. SEEDING SHALL BE DONE IN ACCORDANCE WITH THE CITY OF COLUMBIA UTILITIES DEPARTMENT STANDARDS AND SPECIFICATIONS.	9. SEEDING SHALL BE DONE IN ACCORDANCE WITH THE CITY OF COLUMBIA UTILITIES DEPARTMENT STANDARDS AND SPECIFICATIONS.
10. THE CONTRACTOR SHALL BE RESPONSIBLE FOR OBTAINING ALL NECESSARY PERMITS AND APPROVALS FROM THE CITY OF COLUMBIA UTILITIES DEPARTMENT.	10. THE CONTRACTOR SHALL BE RESPONSIBLE FOR OBTAINING ALL NECESSARY PERMITS AND APPROVALS FROM THE CITY OF COLUMBIA UTILITIES DEPARTMENT.
11. SEEDING SHALL BE DONE IN ACCORDANCE WITH THE CITY OF COLUMBIA UTILITIES DEPARTMENT STANDARDS AND SPECIFICATIONS.	11. SEEDING SHALL BE DONE IN ACCORDANCE WITH THE CITY OF COLUMBIA UTILITIES DEPARTMENT STANDARDS AND SPECIFICATIONS.
12. THE CONTRACTOR SHALL BE RESPONSIBLE FOR OBTAINING ALL NECESSARY PERMITS AND APPROVALS FROM THE CITY OF COLUMBIA UTILITIES DEPARTMENT.	12. THE CONTRACTOR SHALL BE RESPONSIBLE FOR OBTAINING ALL NECESSARY PERMITS AND APPROVALS FROM THE CITY OF COLUMBIA UTILITIES DEPARTMENT.
13. SEEDING SHALL BE DONE IN ACCORDANCE WITH THE CITY OF COLUMBIA UTILITIES DEPARTMENT STANDARDS AND SPECIFICATIONS.	13. SEEDING SHALL BE DONE IN ACCORDANCE WITH THE CITY OF COLUMBIA UTILITIES DEPARTMENT STANDARDS AND SPECIFICATIONS.
14. THE CONTRACTOR SHALL BE RESPONSIBLE FOR OBTAINING ALL NECESSARY PERMITS AND APPROVALS FROM THE CITY OF COLUMBIA UTILITIES DEPARTMENT.	14. THE CONTRACTOR SHALL BE RESPONSIBLE FOR OBTAINING ALL NECESSARY PERMITS AND APPROVALS FROM THE CITY OF COLUMBIA UTILITIES DEPARTMENT.
15. SEEDING SHALL BE DONE IN ACCORDANCE WITH THE CITY OF COLUMBIA UTILITIES DEPARTMENT STANDARDS AND SPECIFICATIONS.	15. SEEDING SHALL BE DONE IN ACCORDANCE WITH THE CITY OF COLUMBIA UTILITIES DEPARTMENT STANDARDS AND SPECIFICATIONS.
16. THE CONTRACTOR SHALL BE RESPONSIBLE FOR OBTAINING ALL NECESSARY PERMITS AND APPROVALS FROM THE CITY OF COLUMBIA UTILITIES DEPARTMENT.	16. THE CONTRACTOR SHALL BE RESPONSIBLE FOR OBTAINING ALL NECESSARY PERMITS AND APPROVALS FROM THE CITY OF COLUMBIA UTILITIES DEPARTMENT.
17. SEEDING SHALL BE DONE IN ACCORDANCE WITH THE CITY OF COLUMBIA UTILITIES DEPARTMENT STANDARDS AND SPECIFICATIONS.	17. SEEDING SHALL BE DONE IN ACCORDANCE WITH THE CITY OF COLUMBIA UTILITIES DEPARTMENT STANDARDS AND SPECIFICATIONS.
18. THE CONTRACTOR SHALL BE RESPONSIBLE FOR OBTAINING ALL NECESSARY PERMITS AND APPROVALS FROM THE CITY OF COLUMBIA UTILITIES DEPARTMENT.	18. THE CONTRACTOR SHALL BE RESPONSIBLE FOR OBTAINING ALL NECESSARY PERMITS AND APPROVALS FROM THE CITY OF COLUMBIA UTILITIES DEPARTMENT.
19. SEEDING SHALL BE DONE IN ACCORDANCE WITH THE CITY OF COLUMBIA UTILITIES DEPARTMENT STANDARDS AND SPECIFICATIONS.	19. SEEDING SHALL BE DONE IN ACCORDANCE WITH THE CITY OF COLUMBIA UTILITIES DEPARTMENT STANDARDS AND SPECIFICATIONS.
20. THE CONTRACTOR SHALL BE RESPONSIBLE FOR OBTAINING ALL NECESSARY PERMITS AND APPROVALS FROM THE CITY OF COLUMBIA UTILITIES DEPARTMENT.	20. THE CONTRACTOR SHALL BE RESPONSIBLE FOR OBTAINING ALL NECESSARY PERMITS AND APPROVALS FROM THE CITY OF COLUMBIA UTILITIES DEPARTMENT.





WICKSON
ENGINEERING & ARCHITECTURE
1300 MAIN STREET
COLUMBIA, SC 29201
PH: 803-733-8888
WWW.WICKSONENR.COM



NO.	DATE	REVISION

PROJECT NAME: STONEGATE WATER SYSTEM INTERCONNECTION
DRAWING TITLE: WATER DISTRIBUTION SYSTEM
DESIGNED BY: CAROLINA WATER SERVICE, INC.
SCALE: AS SHOWN
DATE: 12/27/2017
DRAWING NUMBER: C2
WFO PROJ. NO.: 20170089.00.CA

SCANNED DRAWING - SUBMITTAL TO CITY OF COLUMBIA ENGINEERING DEPARTMENT

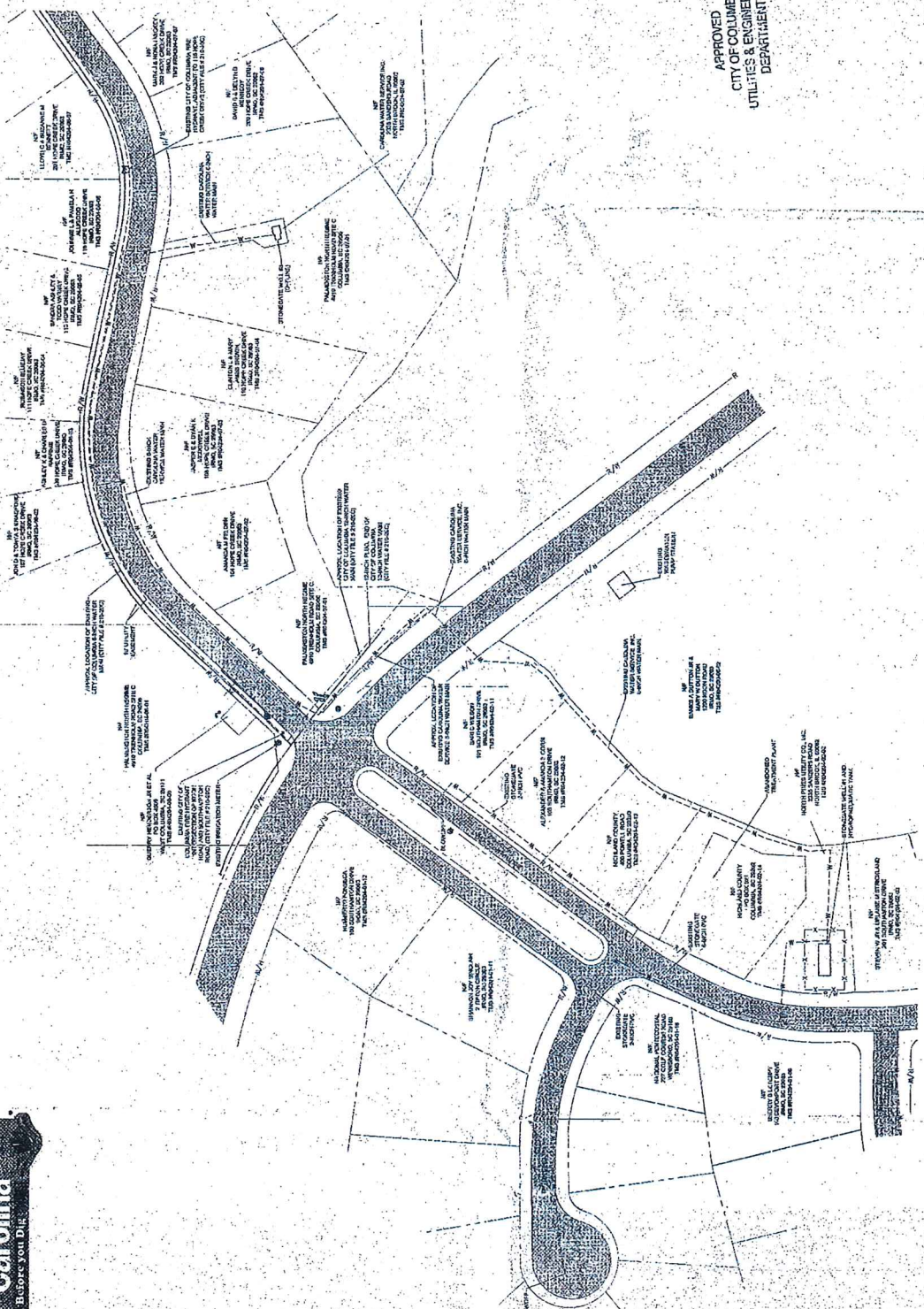

WATER DISTRIBUTION SYSTEM
SCALE: 1"=30'

- NOTES**
1. PROJECT SITE PLAN INFORMATION BASED UPON INFORMATION OBTAINED FROM THE LEXINGTON COUNTY, SOUTH CAROLINA RECORD DRAWINGS PROVIDED BY THE CITY OF COLUMBIA, SOUTH CAROLINA, AND IS SUBJECT TO THE RECORD DRAWINGS PROVIDED BY THE CITY OF COLUMBIA, SOUTH CAROLINA.
 2. CONTRACTOR SHALL VERIFY LOCATION & ELEVATIONS OF ALL EXISTING UTILITIES WITHIN THE PROJECT AREA PRIOR TO CONSTRUCTION AND SHALL NOTIFY THE ENGINEER IMMEDIATELY IF ANY DISCREPANCIES OR ADDITIONAL CONFLICTING UTILITIES ARE FOUND.
 3. OTHER UTILITY CROSSINGS MAY EXIST THAT ARE NOT SHOWN ON THIS PLAN. ANY DAMAGE TO EXISTING UNDERGROUND UTILITIES SHALL BE REPAIRED AT THE CONTRACTOR'S EXPENSE.
 4. THE CONTRACTOR SHALL BE RESPONSIBLE FOR OBTAINING ALL NECESSARY PERMITS AND RECORDS FROM THE CITY OF COLUMBIA, SOUTH CAROLINA.



NO.	DATE	DESCRIPTION

PROJECT NAME: STONEGATE WATER SYSTEM INTERCONNECTION
 FOR CAROLINA WATER SERVICE, INC.
 FORKLAND COUNTY, SOUTH CAROLINA
 DRAWING TITLE: PROPOSED IMPROVEMENTS PLAN

PROJ. NO.: 20170068.00.CA
 SHEET NO.: C3
 DATE: 11/15/2017
 DRAWING NUMBER: 20170068.00.CA

DRIVING STATUS - SUBMITTAL TO CITY OF COLUMBIA ENGINEERING

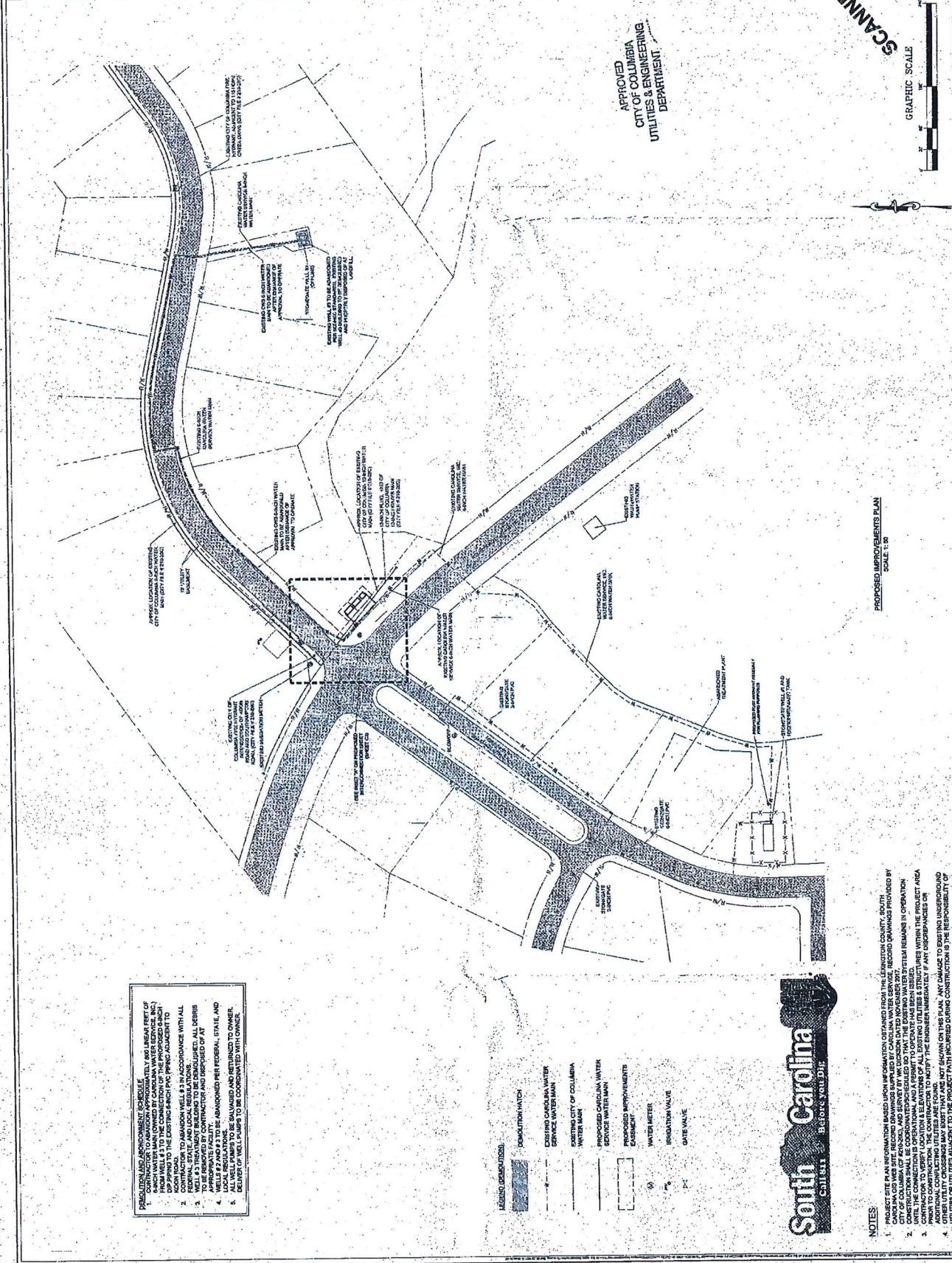

APPROVED
 CITY OF COLUMBIA
 UTILITIES & ENGINEERING
 DEPARTMENT



PROPOSED IMPROVEMENTS PLAN
 SCALE: 1" = 30'

1. PERMITTING AND APPROVEMENTS FOR THE CONTRACTOR TO ABANDON APPROXIMATELY 600 LINEAR FEET OF EXISTING 12" DIA. WATER MAIN AND TO CONNECT TO THE PROPOSED 8" DIA. PVC PIPE ADJACENT TO THE EXISTING 8" DIA. PVC PIPE ADJACENT TO THE CONTRACTOR TO ABANDON WELL #3 IN ACCORDANCE WITH ALL CITY OF COLUMBIA REQUIREMENTS. ALL DEBRIS TO BE REMOVED BY CONTRACTOR AND DISPOSED OF AT THE CONTRACTOR'S EXPENSE.
2. WELLS #2 AND #3 TO BE ABANDONED PER FEDERAL, STATE, AND LOCAL REGULATIONS AND RETURNED TO OWNER. DELIVERY OF WELL PUMPS TO BE COORDINATED WITH OWNER.

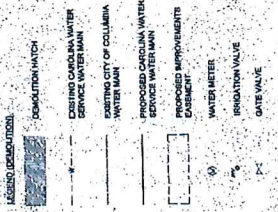

NOTES:
 1. PROJECT SITE PLAN AND ALL INFORMATION OBTAINED FROM THE ENGINEER COUNTY, SOUTH CAROLINA, IS PROVIDED AS IS. THE ENGINEER DOES NOT WARRANT THE ACCURACY OF THE INFORMATION PROVIDED BY THE CITY OF COLUMBIA, SOUTH CAROLINA, AND SURVEY BY THE ENGINEER. THE ENGINEER SHALL NOT BE RESPONSIBLE FOR ANY DAMAGE TO EXISTING UNDERGROUND UTILITIES OR TO ANY OTHER UTILITIES REMAINING IN OPERATION UNTIL THE CONSTRUCTION IS OPERATIONAL AND A PERMIT TO OPERATE HAS BEEN ISSUED BY THE CITY OF COLUMBIA, SOUTH CAROLINA. THE ENGINEER SHALL NOT BE RESPONSIBLE FOR ANY DISCREPANCIES OR ADDITIONAL CONTACTING UTILITIES ARE FOUND.
 2. THE CONTRACTOR SHALL BE RESPONSIBLE FOR OBTAINING ALL NECESSARY PERMITS AND APPROVALS FROM THE CITY OF COLUMBIA, SOUTH CAROLINA, AND ANY OTHER AGENCIES.
 3. THE CONTRACTOR SHALL BE RESPONSIBLE FOR OBTAINING ALL NECESSARY PERMITS AND APPROVALS FROM THE CITY OF COLUMBIA, SOUTH CAROLINA, AND ANY OTHER AGENCIES.
 4. THE CONTRACTOR SHALL BE RESPONSIBLE FOR OBTAINING ALL NECESSARY PERMITS AND APPROVALS FROM THE CITY OF COLUMBIA, SOUTH CAROLINA, AND ANY OTHER AGENCIES.



NO.	DATE	DESCRIPTION

PROJECT NAME: STONEGATE WATER SYSTEM INTERCONNECTION
 DRAWING TITLE: PROPOSED INTERCONNECTION
 CAROLINA WATER SERVICE, INC.
 RICHMOND COUNTY, SOUTH CAROLINA

SCALE: 1" = 40'-0"
 SHEET NO.: 04
 PROJECT NO.: 20170068.00.CA
 DRAWING NUMBER: 04

DRIVING STATUS: SUBMITTAL TO CITY OF COLUMBIA ENGINEERING

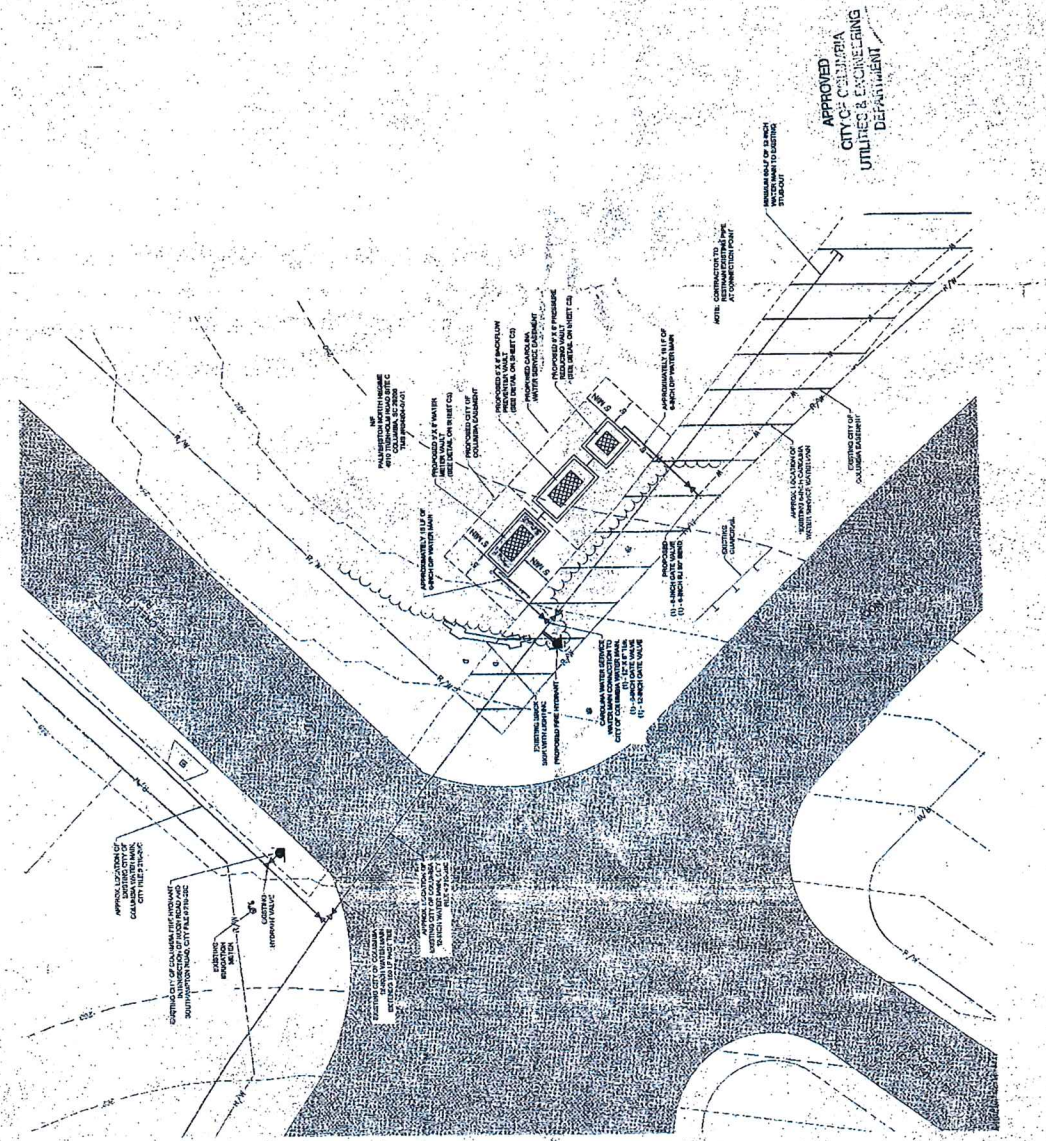

APPROVED
 CITY OF COLUMBIA
 UTILITIES & ENGINEERING
 Department

GRAPHIC SCALE
 1" = 40'-0"

PROPOSED INTERCONNECTION
 SCALE 1" = 40'-0"

- PROPOSED IMPROVEMENTS:**
- ONE (1) 8" x 8" BACKFLOW PREVENTER VAULT WITH 36" x 48" ACCESS HATCH.
 - ONE (1) 8" x 8" BACKFLOW PREVENTER VAULT WITH 36" x 48" ACCESS HATCH.
 - ONE (1) 3" x 3" PRESSURE REDUCING VAULT WITH 36" x 48" ACCESS HATCH.
 - TWO (2) 3" x 3" VALVES FIRST OF EACH SIDE WATER MAIN.
 - TWO (2) 3" x 3" DATE VALVES.
 - ONE (1) 12" x 12" TIE.
 - TWO (2) 3" x 3" BRIDGES.
 - BACKFLOW PREVENTER DEVICE WITH 36" x 48" ACCESS HATCH.
 - BACKFLOW PREVENTER DEVICE WITH 36" x 48" ACCESS HATCH.
 - REGULATED INFLUENCE VALVING.

- ADJACENT EASEMENTS:**
- HOPE CREEK DRIVE - 10'-0" WIDE.
 - SOUTH HAMPTON DRIVE - 10'-0" WIDE.

- LEGEND:**
- EXISTING CAROLINA WATER SERVICE WATER MAIN
 - EXISTING CITY OF COLUMBIA WATER MAIN
 - PROPOSED CAROLINA WATER SERVICE WATER MAIN
 - PROPOSED IMPROVEMENTS
 - WATER METER
 - IRIGATION VALVE
 - DATE VALVE



NOTES:

- PROJECT SITE PLAN IMPROVEMENTS SHOWN ARE BASED ON DATA OBTAINED FROM THE RICHMOND COUNTY, SOUTH CAROLINA WATER SERVICE. RECORD DRAWINGS PROVIDED BY THE RICHMOND COUNTY, SOUTH CAROLINA WATER SERVICE AND SURVEY OF THE CITY OF COLUMBIA, SOUTH CAROLINA, SHALL BE USED TO VERIFY THE LOCATION AND DEPTH OF ALL EXISTING WATER MAINS. THE CONTRACTOR SHALL BE RESPONSIBLE FOR VERIFYING THE LOCATION AND DEPTH OF ALL EXISTING WATER MAINS. THE CONTRACTOR SHALL BE RESPONSIBLE FOR VERIFYING THE LOCATION AND DEPTH OF ALL EXISTING WATER MAINS.
- THE CONTRACTOR SHALL BE RESPONSIBLE FOR VERIFYING THE LOCATION AND DEPTH OF ALL EXISTING WATER MAINS. THE CONTRACTOR SHALL BE RESPONSIBLE FOR VERIFYING THE LOCATION AND DEPTH OF ALL EXISTING WATER MAINS.
- THE CONTRACTOR SHALL BE RESPONSIBLE FOR VERIFYING THE LOCATION AND DEPTH OF ALL EXISTING WATER MAINS. THE CONTRACTOR SHALL BE RESPONSIBLE FOR VERIFYING THE LOCATION AND DEPTH OF ALL EXISTING WATER MAINS.
- THE CONTRACTOR SHALL BE RESPONSIBLE FOR VERIFYING THE LOCATION AND DEPTH OF ALL EXISTING WATER MAINS. THE CONTRACTOR SHALL BE RESPONSIBLE FOR VERIFYING THE LOCATION AND DEPTH OF ALL EXISTING WATER MAINS.



NO.	DATE	DESCRIPTION

PROJECT NAME: STONEGATE WATER SYSTEM INTERCONNECTION
 PROJECT TITLE: CAMQUINA WATER SERVICE, INC.
 RICHLAND COUNTY, SOUTH CAROLINA
 SITE DETAIL

SCALE: 1/8"=1'-0"
 DRAWING NUMBER: C6
 WPD PROJ. NO.: 20170068.00.CA

SCANNED DRAWING STATUS - SUBMITTAL TO CITY OF COLUMBIA ENGINEERING

CITY OF COLUMBIA
 UTILITIES & ENGINEERING
 COLUMBIA, SOUTH CAROLINA

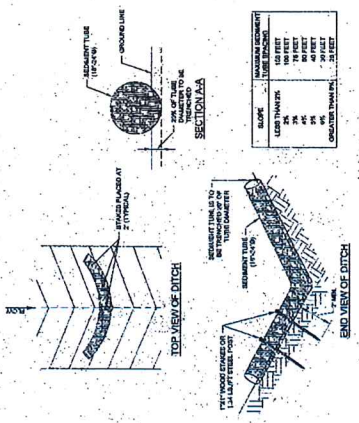

SEDIMENT TUBE DITCH APPLICATION DETAIL
 1. THE SEDIMENT TUBE DITCH SHALL BE INSTALLED IN ACCORDANCE WITH THE FOLLOWING NOTES.
 2. THE SEDIMENT TUBE DITCH SHALL BE INSTALLED IN A TRENCH 18 INCHES DEEP AND 18 INCHES WIDE.
 3. THE SEDIMENT TUBE DITCH SHALL BE INSTALLED IN A TRENCH 18 INCHES DEEP AND 18 INCHES WIDE.
 4. THE SEDIMENT TUBE DITCH SHALL BE INSTALLED IN A TRENCH 18 INCHES DEEP AND 18 INCHES WIDE.
 5. THE SEDIMENT TUBE DITCH SHALL BE INSTALLED IN A TRENCH 18 INCHES DEEP AND 18 INCHES WIDE.
 6. THE SEDIMENT TUBE DITCH SHALL BE INSTALLED IN A TRENCH 18 INCHES DEEP AND 18 INCHES WIDE.
 7. THE SEDIMENT TUBE DITCH SHALL BE INSTALLED IN A TRENCH 18 INCHES DEEP AND 18 INCHES WIDE.
 8. THE SEDIMENT TUBE DITCH SHALL BE INSTALLED IN A TRENCH 18 INCHES DEEP AND 18 INCHES WIDE.

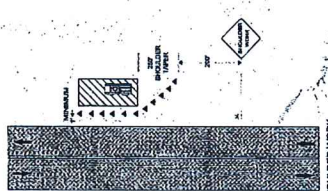

STANDARD CURB (SHORT-TERM STATIONARY - 1 TO 2 HOURS)
 1. THE STANDARD CURB SHALL BE INSTALLED IN ACCORDANCE WITH THE FOLLOWING NOTES.
 2. THE STANDARD CURB SHALL BE INSTALLED IN A TRENCH 18 INCHES DEEP AND 18 INCHES WIDE.
 3. THE STANDARD CURB SHALL BE INSTALLED IN A TRENCH 18 INCHES DEEP AND 18 INCHES WIDE.
 4. THE STANDARD CURB SHALL BE INSTALLED IN A TRENCH 18 INCHES DEEP AND 18 INCHES WIDE.
 5. THE STANDARD CURB SHALL BE INSTALLED IN A TRENCH 18 INCHES DEEP AND 18 INCHES WIDE.
 6. THE STANDARD CURB SHALL BE INSTALLED IN A TRENCH 18 INCHES DEEP AND 18 INCHES WIDE.
 7. THE STANDARD CURB SHALL BE INSTALLED IN A TRENCH 18 INCHES DEEP AND 18 INCHES WIDE.
 8. THE STANDARD CURB SHALL BE INSTALLED IN A TRENCH 18 INCHES DEEP AND 18 INCHES WIDE.

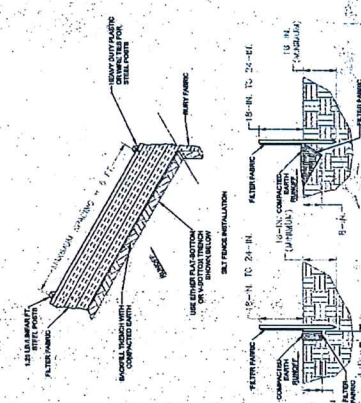

STANDARD CURB FENCE DETAIL
 1. THE STANDARD CURB FENCE SHALL BE INSTALLED IN ACCORDANCE WITH THE FOLLOWING NOTES.
 2. THE STANDARD CURB FENCE SHALL BE INSTALLED IN A TRENCH 18 INCHES DEEP AND 18 INCHES WIDE.
 3. THE STANDARD CURB FENCE SHALL BE INSTALLED IN A TRENCH 18 INCHES DEEP AND 18 INCHES WIDE.
 4. THE STANDARD CURB FENCE SHALL BE INSTALLED IN A TRENCH 18 INCHES DEEP AND 18 INCHES WIDE.
 5. THE STANDARD CURB FENCE SHALL BE INSTALLED IN A TRENCH 18 INCHES DEEP AND 18 INCHES WIDE.
 6. THE STANDARD CURB FENCE SHALL BE INSTALLED IN A TRENCH 18 INCHES DEEP AND 18 INCHES WIDE.
 7. THE STANDARD CURB FENCE SHALL BE INSTALLED IN A TRENCH 18 INCHES DEEP AND 18 INCHES WIDE.
 8. THE STANDARD CURB FENCE SHALL BE INSTALLED IN A TRENCH 18 INCHES DEEP AND 18 INCHES WIDE.

APPENDIX A
RATE SHEET

ORDINANCE NO.: 2018-027

Amending the 1998 Code of Ordinances of the City of Columbia, South Carolina, Chapter 23, Utilities and Engineering, Article V, Water and Sewer Rates, Sec. 23-143 Water service rates and Sec. 23-149 Sewer service rates (a) and (b)

BE IT ORDAINED by the Mayor and Council this 19th day of June, 2018, that the 1998 Code of Ordinances of the City of Columbia, South Carolina, Chapter 23, Utilities and Engineering, Article V, Water and Sewer Rates, Sec. 23-143 Water service rates and Sec. 23-149 Sewer service rates (a) and (b), are amended to read as follows:

Sec. 23-143. Water service rates.

Generally. Except as otherwise provided by contract, monthly water service charges shall be as follows:

Monthly Water Use (cubic feet)	Meter Size (inches)	In City	Out of City
Minimum--300	3/4"	7.58	12.90
	1"	12.67	21.53
	1.5"	18.97	32.25
	2"	30.35	51.60
	3"	60.71	103.20
	4"	94.85	161.25
	6"	189.94	322.89
	8"	303.53	516.00
	10"	602.66	1024.52

Additional charge per 100 cubic feet

Volumetric Charges are based on the customer category.

Monthly Water Use (cubic feet)	In City	Out of City
Residential:		
Next 9,700	2.72	4.63
Next 90,000	2.59	4.40
Over 100,000	2.45	4.16
Irrigation:		
Next 9,700	4.63	7.87
Next 90,000	4.40	7.49
Over 100,000	4.16	7.08
All others:		
Next 9,700	2.59	4.40
Next 90,000	2.45	4.16
Over 100,000	2.29	3.90

ORIGINAL
STAMPED IN RED

ORIGINAL
STAMPED IN RED

Sec. 23-149. Sewer service rates.

(a) Generally. Except as otherwise provided by contract, the monthly sewer service charge shall be as follows:

Size of Meter (inches)	Monthly Sewer Service Charge	
	In City	Out of City
5/8	7.58	12.90
1	7.58	12.90
1½	7.58	12.90
2	12.14	20.63
3	24.28	41.27
4	37.94	64.49
6	75.88	129.00
8	121.42	206.40
10	189.71	322.50

Monthly Water Use (cubic feet)	Monthly Sewer Service Charge	
	In City	Out of City
Each 100 cubic feet	3.94	6.71

(b) Consumers using water cooling towers for air conditioning. Consumers using water cooling towers for air conditioning systems shall be given a credit of 30 cubic feet per ton per month during the service periods commencing in the months of April through October. The minimum charge shall be:

Size of Meter (inches)	In City	Out of City
5/8	12.30	15.65
1	17.35	22.91
1½	22.38	30.17
2	32.46	44.65
3	52.60	73.67
4	92.88	131.69
6	193.58	276.76
8	274.13	392.82
10	603.90	867.93

(c) Limitation on charge on single-family residences. Maximum sewer charge on single-family residences during the service periods commencing in the months of April through October will be 1,400 cubic feet.

(d) Apartments and trailer parks. Sewer rates for apartment buildings and trailer parks shall be the base rate of a single-family residence per dwelling unit plus a base fee based on meter connection size plus the rate per 100 cubic feet as reflected by water consumption.

(e) Hotels, motels, dormitories and roominghouses. Sewer rates for hotels, motels, dormitories and roominghouses shall be one-half the base rate of a single-family residence per room plus a base fee based on meter connection size plus the rate per 100 cubic feet as reflected by water consumption.

(f) Contaminated groundwater. Separate meters for discharges of contaminated groundwater are required. In city or out of city customers discharging contaminated ground water shall pay the out of city base monthly sewer service charge times one and one-half plus the out of city monthly sewer service charge for each 100 cubic feet times one and one-half.

This ordinance is effective as of July 1, 2018.

Requested by:

Mayor and City Council _____



Mayor

Approved by:



City Manager

Approved as to form:



City Attorney

ATTEST:



City Clerk

Public Hearing: 6/5/2018

Introduced: 6/5/2018

Final Reading: 6/19/2018

ORIGINAL
STAMPED IN RED