

RESOLUTION NO.: R-2019-041

Authorizing the Purchase of approximately 11.64 acres on the western side of Gills Creek Parkway at Pelham Drive; Richland County TMS#13712-02-46 from Franklyn D. Owen, III, et al for a Stormwater Utility Site; CF#250-433

ORIGINAL
STAMPED IN RED

WHEREAS, the subject property is located between two parcels owned by the City of Columbia on the western side of Gills Creek Parkway at Pelham Drive. After completing a study of the Gills Creek stormwater basin and responding to complaints made by area property owners, the City's Engineering and Stormwater Divisions have reviewed the conditions of the stormwater system in this area and determined that the best solution would be for the City to purchase the subject property and create a stormwater utility site; and,

WHEREAS, the property owners agreed to the proposal for the City to acquire the subject property for the negotiated value of Thirty Thousand and No/100 (\$30,000.00) Dollars. The property is described as 11.64 acres in the deed to the current owners, but is shown as 8.72 acres on the plat from a field survey. The current owners will convey to the City all property owned by them and identified as Richland County Tax Map Number 13712-02-46; and,

WHEREAS, approval is recommended by the Director of Engineering; NOW, THEREFORE,

BE IT RESOLVED by the Mayor and City Council of the City of Columbia, South Carolina this 7th day of May, 2019, that for and in consideration of the sum of Thirty Thousand and No/100 (\$30,000.00) Dollars, the City Manager is hereby authorized to execute all closing documents necessary and pre-approved by the City Attorney to consummate the acquisition by the City of Columbia of all property owned by the current owners along the western side of Gills Creek Parkway at Pelham Drive and identified as Richland County Tax Map Number 13712-02-46 to be used as a stormwater utility site.

The referenced property is shown on a plat dated January 4, 2013, prepared by the City of Columbia, David S. Sharpe, S.C. R.L.S. #10509, for the City of Columbia, South Carolina and being on file in the office of the Department of Engineering, City of Columbia, South Carolina under file reference #250-433. A copy of said plat being attached hereto and made a part hereof as Exhibit "A".

(Funding Source: 5534202-638305)

Requested by:

Assistant City Manager Shealy



Mayor

Approved by:



City Manager

Approved as to form:



City Attorney

ATTEST:

City Clerk

Introduced: 5/7/2019
Final Reading: 5/7/2019

RESOLUTION NO.: R-2019-041
EXHIBIT "A"



LOCATION MAP
1" = 1000'

Point	Northing	Easting
1	782012.0	211721.0
2	782012.0	211721.0
3	782012.0	211721.0
4	782012.0	211721.0
5	782012.0	211721.0
6	782012.0	211721.0
7	782012.0	211721.0
8	782012.0	211721.0
9	782012.0	211721.0
10	782012.0	211721.0
11	782012.0	211721.0
12	782012.0	211721.0
13	782012.0	211721.0
14	782012.0	211721.0
15	782012.0	211721.0
16	782012.0	211721.0
17	782012.0	211721.0
18	782012.0	211721.0
19	782012.0	211721.0
20	782012.0	211721.0
21	782012.0	211721.0
22	782012.0	211721.0
23	782012.0	211721.0
24	782012.0	211721.0
25	782012.0	211721.0
26	782012.0	211721.0
27	782012.0	211721.0
28	782012.0	211721.0
29	782012.0	211721.0
30	782012.0	211721.0
31	782012.0	211721.0
32	782012.0	211721.0
33	782012.0	211721.0
34	782012.0	211721.0
35	782012.0	211721.0
36	782012.0	211721.0
37	782012.0	211721.0
38	782012.0	211721.0
39	782012.0	211721.0
40	782012.0	211721.0
41	782012.0	211721.0
42	782012.0	211721.0
43	782012.0	211721.0
44	782012.0	211721.0
45	782012.0	211721.0
46	782012.0	211721.0
47	782012.0	211721.0
48	782012.0	211721.0
49	782012.0	211721.0
50	782012.0	211721.0
51	782012.0	211721.0
52	782012.0	211721.0
53	782012.0	211721.0
54	782012.0	211721.0
55	782012.0	211721.0
56	782012.0	211721.0
57	782012.0	211721.0
58	782012.0	211721.0
59	782012.0	211721.0
60	782012.0	211721.0
61	782012.0	211721.0
62	782012.0	211721.0
63	782012.0	211721.0
64	782012.0	211721.0
65	782012.0	211721.0
66	782012.0	211721.0
67	782012.0	211721.0
68	782012.0	211721.0
69	782012.0	211721.0
70	782012.0	211721.0
71	782012.0	211721.0
72	782012.0	211721.0
73	782012.0	211721.0
74	782012.0	211721.0
75	782012.0	211721.0
76	782012.0	211721.0
77	782012.0	211721.0
78	782012.0	211721.0
79	782012.0	211721.0
80	782012.0	211721.0
81	782012.0	211721.0
82	782012.0	211721.0
83	782012.0	211721.0
84	782012.0	211721.0
85	782012.0	211721.0
86	782012.0	211721.0
87	782012.0	211721.0
88	782012.0	211721.0
89	782012.0	211721.0
90	782012.0	211721.0
91	782012.0	211721.0
92	782012.0	211721.0
93	782012.0	211721.0
94	782012.0	211721.0
95	782012.0	211721.0
96	782012.0	211721.0
97	782012.0	211721.0
98	782012.0	211721.0
99	782012.0	211721.0
100	782012.0	211721.0

PLAT PREPARED FOR
CITY OF COLUMBIA

LOCATED IN RICHLAND COUNTY, SOUTH CAROLINA

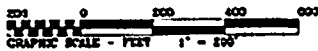

EXEMPTION FROM REVIEW PROCESS
This plat is a survey of an existing lot of record and no changes to existing lot data.

Registered Surveyor
David S. Sharpe, P.E.
S.C. #13187

ALL LOTS ARE 200' WIDE UNLESS OTHERWISE STATED

REFERENCE PLATS

1. PLAT PREPARED FOR VEDDELL INVESTMENT COMPANY BY DEL FLO & SMITH, INC. DATED MAY 29, 1972. CITY FILE NUMBER 16-93.
2. PLAT PREPARED FOR PELHAM & ASSOCIATES BY CIVIL ENGINEERING OF COLUMBIA DATED JULY 26, 1993 CITY FILE NUMBER 123-16.
3. PLAT PREPARED FOR THOMAS B. HOFFER, JR. BY HENNING ENGINEERING COMPANY DATED MAY 11, 1976 RECORDED IN PLAT BOOK 3 PAGE 230.
4. PLAT PREPARED FOR DR. AMBERG G. HAMILTON, JR. BY SP BARBER & ASSOCIATES DATED JUNE 29, 1943 RECORDED IN PLAT BOOK 31 PAGE 2693.
5. IMPROVEMENTS TO PELHAM DRIVE & COLLS CREEK PARKWAY BY SP BARBER & ASSOCIATES DATED JANUARY 16, 1987 CITY FILE NUMBER 123-16A.
6. CITY FILE NUMBER 160-25.
7. THE 13712-02-06.

THIS PROPERTY IS SUBJECT TO EASEMENTS, RESTRICTIONS, RIGHT OF WAY AND/OR ANY INFORMATION THAT MAY BE DISCOVERED IN A FULL AND COMPLETE TITLE SEARCH.

I HEREBY STATE THAT TO THE BEST OF MY KNOWLEDGE THAT THE ABOVE PROPERTY IS LOCATED IN A SPECIAL FLOOD HAZARD AREA ACCORDING TO FEMA MAP NO. 17070C0276, DATED SEPTEMBER 29, 2018. I HEREBY STATE THAT TO THE BEST OF MY KNOWLEDGE, INFORMATION AND BELIEF.

THE SURVEY SHOWN HEREON WAS MADE IN ACCORDANCE WITH THE REQUIREMENTS OF THE NATIONAL STANDARDS MANUAL FOR THE PRACTICE OF LAND SURVEYING IN SOUTH CAROLINA, SET BY THE BOARD OF SURVEYORS AND THE REQUIREMENTS FOR A CLASS 'B' SURVEY AS SPECIFIED THEREIN. ALSO THERE ARE NO VISIBLE ENCUMBRANCES OR PROJECTIONS OTHER THAN SHOWN.

DAVID S. SHARPE, SCLPS # 10039
DATE: JANUARY 4, 2019

SUBDIVISION PLAT
The Subdivision Plat shown herein has been found to comply with the City of Columbia Subdivision Ordinance and has been approved by recording in the Office of City Clerk and Clerk of Richland County, South Carolina. This approval shall be void if the recording is not approved by the Clerk of Richland County of the recording jurisdiction of the plat.

Date: 6-6-19
David S. Sharpe
Local Government Administrator
CITY OF COLUMBIA
100 13019 01-24

ROSEWOOD DRIVE CAT S-21

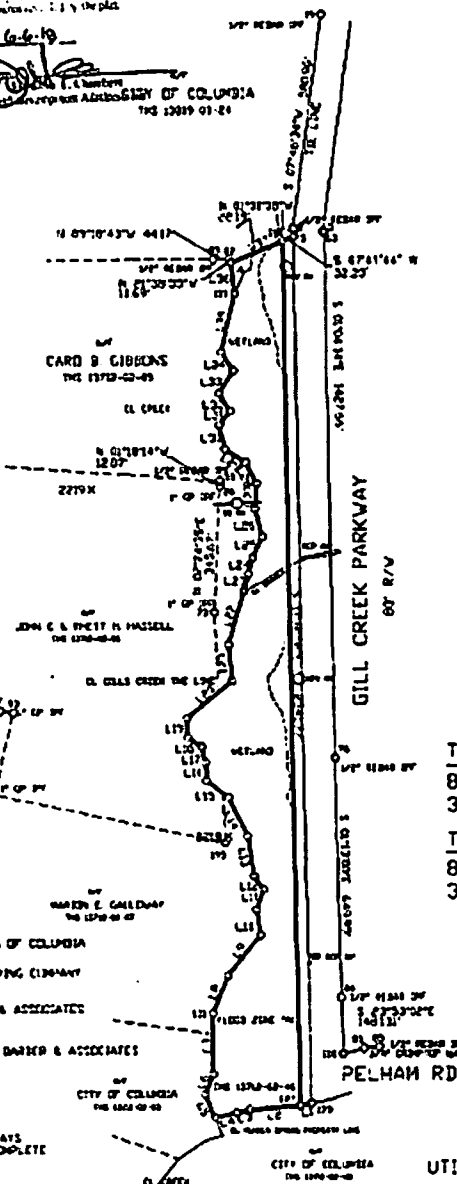
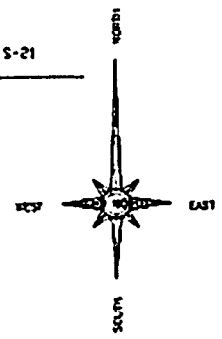

Course	Bearing	Distance
1	N 87°10'43" W	32.25'
2	S 87°10'43" W	170.42'
3	N 87°10'43" W	32.25'
4	S 87°10'43" W	170.42'
5	N 87°10'43" W	32.25'
6	S 87°10'43" W	170.42'
7	N 87°10'43" W	32.25'
8	S 87°10'43" W	170.42'
9	N 87°10'43" W	32.25'
10	S 87°10'43" W	170.42'
11	N 87°10'43" W	32.25'
12	S 87°10'43" W	170.42'
13	N 87°10'43" W	32.25'
14	S 87°10'43" W	170.42'
15	N 87°10'43" W	32.25'
16	S 87°10'43" W	170.42'
17	N 87°10'43" W	32.25'
18	S 87°10'43" W	170.42'
19	N 87°10'43" W	32.25'
20	S 87°10'43" W	170.42'
21	N 87°10'43" W	32.25'
22	S 87°10'43" W	170.42'
23	N 87°10'43" W	32.25'
24	S 87°10'43" W	170.42'
25	N 87°10'43" W	32.25'
26	S 87°10'43" W	170.42'
27	N 87°10'43" W	32.25'
28	S 87°10'43" W	170.42'
29	N 87°10'43" W	32.25'
30	S 87°10'43" W	170.42'
31	N 87°10'43" W	32.25'
32	S 87°10'43" W	170.42'
33	N 87°10'43" W	32.25'
34	S 87°10'43" W	170.42'
35	N 87°10'43" W	32.25'
36	S 87°10'43" W	170.42'
37	N 87°10'43" W	32.25'
38	S 87°10'43" W	170.42'
39	N 87°10'43" W	32.25'
40	S 87°10'43" W	170.42'
41	N 87°10'43" W	32.25'
42	S 87°10'43" W	170.42'
43	N 87°10'43" W	32.25'
44	S 87°10'43" W	170.42'
45	N 87°10'43" W	32.25'
46	S 87°10'43" W	170.42'
47	N 87°10'43" W	32.25'
48	S 87°10'43" W	170.42'
49	N 87°10'43" W	32.25'
50	S 87°10'43" W	170.42'
51	N 87°10'43" W	32.25'
52	S 87°10'43" W	170.42'
53	N 87°10'43" W	32.25'
54	S 87°10'43" W	170.42'
55	N 87°10'43" W	32.25'
56	S 87°10'43" W	170.42'
57	N 87°10'43" W	32.25'
58	S 87°10'43" W	170.42'
59	N 87°10'43" W	32.25'
60	S 87°10'43" W	170.42'
61	N 87°10'43" W	32.25'
62	S 87°10'43" W	170.42'
63	N 87°10'43" W	32.25'
64	S 87°10'43" W	170.42'
65	N 87°10'43" W	32.25'
66	S 87°10'43" W	170.42'
67	N 87°10'43" W	32.25'
68	S 87°10'43" W	170.42'
69	N 87°10'43" W	32.25'
70	S 87°10'43" W	170.42'
71	N 87°10'43" W	32.25'
72	S 87°10'43" W	170.42'
73	N 87°10'43" W	32.25'
74	S 87°10'43" W	170.42'
75	N 87°10'43" W	32.25'
76	S 87°10'43" W	170.42'
77	N 87°10'43" W	32.25'
78	S 87°10'43" W	170.42'
79	N 87°10'43" W	32.25'
80	S 87°10'43" W	170.42'
81	N 87°10'43" W	32.25'
82	S 87°10'43" W	170.42'
83	N 87°10'43" W	32.25'
84	S 87°10'43" W	170.42'
85	N 87°10'43" W	32.25'
86	S 87°10'43" W	170.42'
87	N 87°10'43" W	32.25'
88	S 87°10'43" W	170.42'
89	N 87°10'43" W	32.25'
90	S 87°10'43" W	170.42'
91	N 87°10'43" W	32.25'
92	S 87°10'43" W	170.42'
93	N 87°10'43" W	32.25'
94	S 87°10'43" W	170.42'
95	N 87°10'43" W	32.25'
96	S 87°10'43" W	170.42'
97	N 87°10'43" W	32.25'
98	S 87°10'43" W	170.42'
99	N 87°10'43" W	32.25'
100	S 87°10'43" W	170.42'

TOTAL AREA
8.72 ACRES
379,861.16 SQ. FT
TOTAL AREA WETLANDS
8.38 ACRES
356,510.55 SQ. FT

DEPARTMENT OF UTILITIES AND ENGINEERING

1136 WASHINGTON ST
PH: (803) 253-3400
COLUMBIA, SC 29201
FAX: 703-8177

COLUMBIA
A Capital Place To Be



CF# 250-433