

RESOLUTION NO.: R-2020-063

Release and Abandonment of a 20 SF (0.49' TO 0.51') Portion of the City's Existing 15' Water Line Easement along a portion of Richland County TMS#11301-20-17; 12 Cottonplace Lane; Lot 13, Cottonplace (formerly, Whaley Row Townhouses Phase 2); CF#291-21a

WHEREAS, the City of Columbia obtained a 15' water line easement along the subject property from Whaley Row, LLC, dated March 22, 2007 and recorded on April 11, 2007 in the office of the Register of Deeds for Richland County in Record Book R1301, page 3815; and,

WHEREAS, it has been discovered that a portion of the structure on the subject property encroaches within the fifteen (15') foot water line easement. The area has been inspected and it has determined that the release of a twenty (20') SF portion of the existing fifteen (15') foot water line easement will not impact the existing water line nor future maintenance and operation of the water line; and,

WHEREAS, a request has been made for release and abandonment of a twenty (20') SF portion of the existing fifteen (15') foot water line easement obtained on the subject property that is no longer necessary; NOW, THEREFORE,

BE IT RESOLVED by the Mayor and City Council this 16th day of June, 2020, for and in consideration of the sum of One and No/100 (\$1.00) Dollar, each to the other paid, the receipt of which is hereby acknowledged, the City Manager is hereby authorized to execute a release and abandonment instrument from the City of Columbia that remises, releases and forever quitclaims unto LILLIAN RHYNE STOWE or the current owner of the subject property, her successors and assigns, that a twenty (20') SF portion of the City of Columbia's existing fifteen (15') foot water line easement along 12 Cottonplace Lane and being more clearly shown by a cross-hatch pattern on drawing dated May 7, 2020, drawing 1 of 1, attached hereto and made a part hereof as Exhibit "A".

Said drawing also being on file in the office of the Department of Engineering under file reference #291-21A.

Requested by:

Assistant City Manager Shealy



Mayor

Approved by:



City Manager

Approved as to form:

T. A. Knox

City Attorney

ATTEST:



City Clerk

Introduced: 6/16/2020
Final Reading: 6/16/2020

ORIGINAL
STAMPED IN RED

RESOLUTION NO.: R-2020-063
EXHIBIT "A"

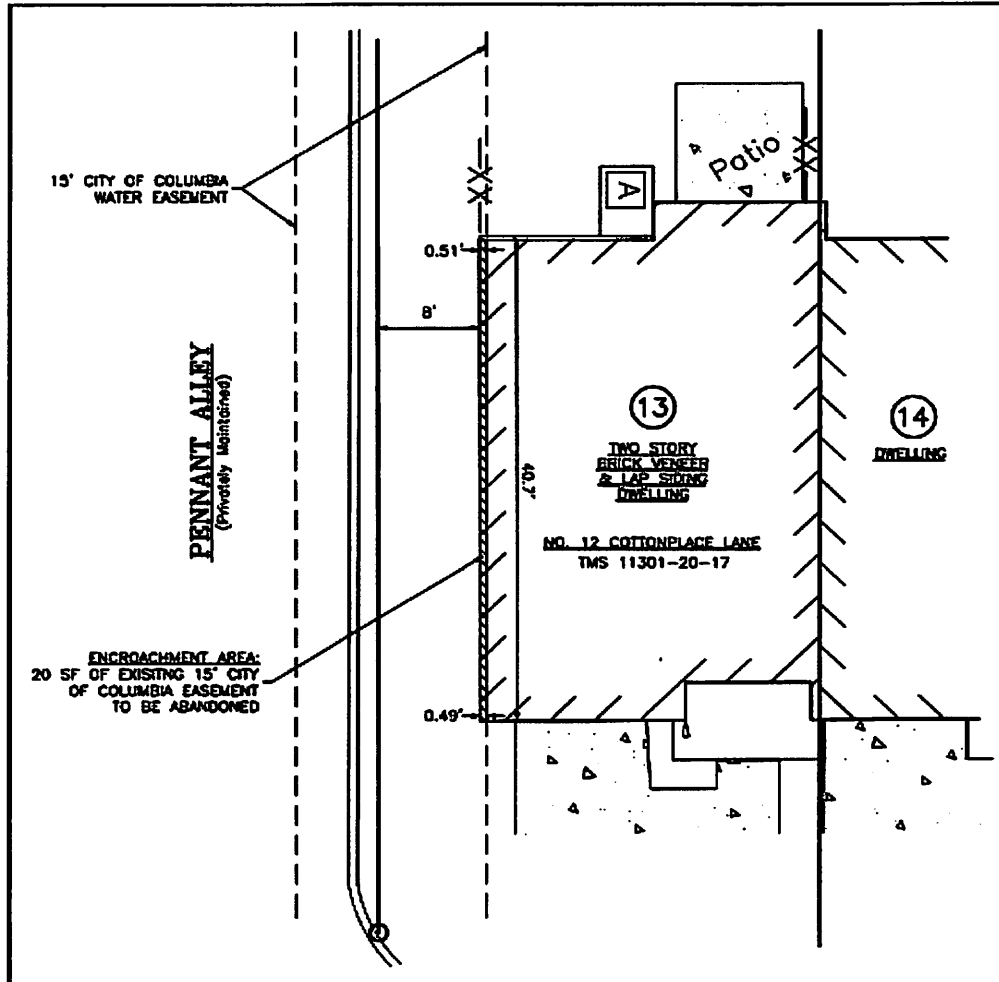

EASEMENT ENCROACHMENT MAP PREPARED FOR:
CITY OF COLUMBIA
DEPARTMENT OF ENGINEERING
RICHLAND COUNTY, COLUMBIA, SOUTH CAROLINA

DATE: MAY 7, 2020

PROJECT NAME: COTTONPLACE
(WHALEY ROW TOWNHOUSES)

SCALE: 1"=10'



JOB NO.: H03046B

REFERENCE:

FINAL SUBDIVISION PLAT OF WHALEY ROW PHASE I, BY INMAN LAND SURVEYING COMPANY, INC., DATED FEBRUARY 6, 2007, REVISED MARCH 13, 2007.

NOTES:

1. THIS PROPERTY IS POSSIBLY SUBJECT TO EASEMENTS AND RESTRICTIONS OF RECORD NOT SHOWN HEREON.
2. THIS PROPERTY MIGHT HAVE UNDERGROUND UTILITIES THAT ARE NOT VISIBLE AT THE SURFACE.
3. NO FLOOD ZONE INSPECTION AT THIS TIME.

INMAN LAND SURVEYING COMPANY, INC.

2223 BULL STREET COLUMBIA SOUTH CAROLINA 29201
PHONE 252-1797 FAX 252-1798

CF#291-21A

BOOK 268-58

S.F. 143 No. 14