

ORDINANCE NO. : 2017-046

Granting an encroachment to the University of South Carolina for the use of the right of way area of the 800 block of Sumter Street and 1300 block of Greene Street for installation and maintenance of curbing, guttering, landscaping, paving, bicycle lanes, irrigation and a raised median, adjacent to the School of Journalism at 800 Sumter Street and Preston College at 1323 Greene Street, Richland County TMS #11304-05-01 and 11303-05-01A

ORIGINAL
STAMPED IN RED

WHEREAS, the University of South Carolina (hereinafter "Grantee") desires to use a portion of the right of way areas of the Granting an encroachment to the University of South Carolina for the use of the right of way area of the 800 block of Sumter Street and 1300 block of Greene Street for installation and maintenance of curbing, guttering, landscaping, paving, bicycle lanes, irrigation, a raised median approximately (12') twelve feet in width (77') seventy-seven feet in length, concrete and brick paver crosswalk varying in width approximately (28') twenty-eight feet and (12') twelve feet approximately (80') eight feet in length, adjacent to the School of Journalism at 800 Sumter Street and Preston College at 1323 Greene Street, Richland County TMS #11304-05-01 and 11303-05-01A; as shown on the attached drawings; and,

WHEREAS, it appears that the encroachment will not interfere with the use of the medians or street for traffic, utility locations or other uses within the foreseeable future; NOW, THEREFORE,

BE IT ORDAINED by the Mayor and City Council of the City of Columbia, South Carolina, this 20th day of June, 2017, that Grantee is hereby granted the right to use the right of way areas of the Granting an encroachment to the University of South Carolina for the use of the right of way area of the 800 block of Sumter Street and 1300 block of Greene Street for installation and maintenance of curbing, guttering, landscaping, paving, bicycle lanes, irrigation, a raised median approximately (12') twelve feet in width (77') seventy-seven feet in length, concrete and brick paver crosswalk varying in width approximately (28') twenty-eight feet and (12') twelve feet approximately (80') eight feet in length, adjacent to the School of Journalism at 800 Sumter Street and Preston College at 1323 Greene Street, Richland County TMS #11304-05-01 and 11303-05-01A, as shown on the attached drawings.

ALL WORK SHALL COMPLY with the requirements of The City of Columbia, South Carolina Department of Transportation and Federal Emergency Management Agency (FEMA) now in existence or hereafter enacted. The materials and type of finish to be used are to be approved by the City Engineer prior to installation. Any damage to the street or sidewalk caused by construction shall be repaired to the satisfaction of the City Manager. Improvements within the encroachment shall be maintained by the grantee at no cost to the City in a manner approved by the City Manager.

PROVIDED FURTHER that the privilege granted hereby is subject to the Grantee complying with the following conditions, restrictions or limitations:

1. No item, including landscaping, shall be placed, planted or allowed to grow such that it creates a visual impediment to persons safely entering or exiting driveways or parking spaces, or to persons safely walking along the sidewalk. The City reserves the right to remove or cut any item located within the right of way which it deems to be a safety hazard.

ORIGINAL
STAMPED IN RED

2. Grantee is responsible for all maintenance of items approved by this ordinance for placement within the right of way area and assuring that all accessibility and ADA requirements are met and maintained.

3. All trees shall be protected and no large tree roots shall be removed from any existing trees, nor shall trees be located too close to streetlights.

4. Irrigation must be designed to avoid spraying walkways, sidewalks and streets and/or creating hazardous conditions upon the walkways, sidewalks and streets.

5. Dashed lines to be added to delineate the continuation of the bicycle lane to the cycle track.

PROVIDED FURTHER that the privilege granted hereby may be modified or terminated by Columbia City Council at any time without notice to the Grantee, its successors and assigns.

BE IT FURTHER ORDAINED that Grantee, in consideration of the above privilege, shall at its expense provide for protection and relocation of all utilities that might be within this area to the satisfaction of the City Manager.

Requested by:

Assistant City Manager Gentry



Mayor

Approved by:



City Manager

Approved as to form:



City Attorney

ATTEST:

City Clerk

Introduced: 6/13/2017

Final Reading: 6/20/2017

**CITY COUNCIL
ENCROACHMENT SUMMARY
2017-046**



**800 BLOCK OF SUMTER STREET AND 1300 BLOCK OF GREENE STREET
BICYCLE LANES, PAVERS, MEDIAN AND LANDSCAPING
ROADWAY IMPROVEMENTS
UNIVERSITY OF SOUTH CAROLINA**

Subject Property:	Right-of-way adjacent to 800 block of Sumter Street and 1300 block of Greene Street adjacent to the School of Journalism at 800 Sumter Street and Preston College at 1323 Greene Street, Richland County TMS #11304-05-01 and 11303-05-01A
Council District:	3
Proposal:	Installation and maintenance of curbing, guttering, landscaping, paving, bicycle lanes, irrigation and a raised median.
Applicant:	University of South Carolina
Staff Recommendation:	Approval

Detail:	<p>The applicant is requesting to an encroachment for the installation and maintenance of curbing, guttering, landscaping, paving, bicycle lanes, irrigation, a raised median approximately (12') twelve feet in width (77') seventy-seven feet in length, concrete and brick paver crosswalk varying in width approximately (28') twenty-eight feet and (12') twelve feet approximately (80') eight feet in length, adjacent to the School of Journalism at 800 Sumter Street and Preston College at 1323 Greene Street, as shown on the attached drawings.</p> <p>Conditions of the proposed encroachment are as follows:</p> <ol style="list-style-type: none"> 1. No item, including landscaping, shall be placed, planted or allowed to grow such that it creates a visual impediment to persons safely entering or exiting driveways or parking spaces, or to persons safely walking along the sidewalk. The City reserves the right to remove or cut any item located within the right of way which it deems to be a safety hazard. 2. Grantee is responsible for all maintenance of items approved by this ordinance for placement within the right of way area and assuring that all accessibility and ADA requirements are met and maintained. 3. All trees shall be protected and no large tree roots shall be removed from any existing trees, nor shall trees be located too close to streetlights. 4. Irrigation must be designed to avoid spraying walkways, sidewalks and streets and/or creating hazardous conditions upon the walkways, sidewalks and streets. 5. Dashed lines to be added to delineate the continuation of the bicycle lane to the cycle track.
----------------	---

CITY AGENCY COMMENTS FOR ENCROACHMENT	
Planning & Development Services	Recommend approval.

Streets	Recommend approval.
Utilities and Engineering	Recommend approval.
Traffic Engineering	Recommend approval.
Forestry	Recommend approval.
Land Development	Recommend approval.
Fire	Recommend approval.

City of Columbia

USC Sumter and Green St. Pedestrian Improvements

Thursday, June 01, 2017

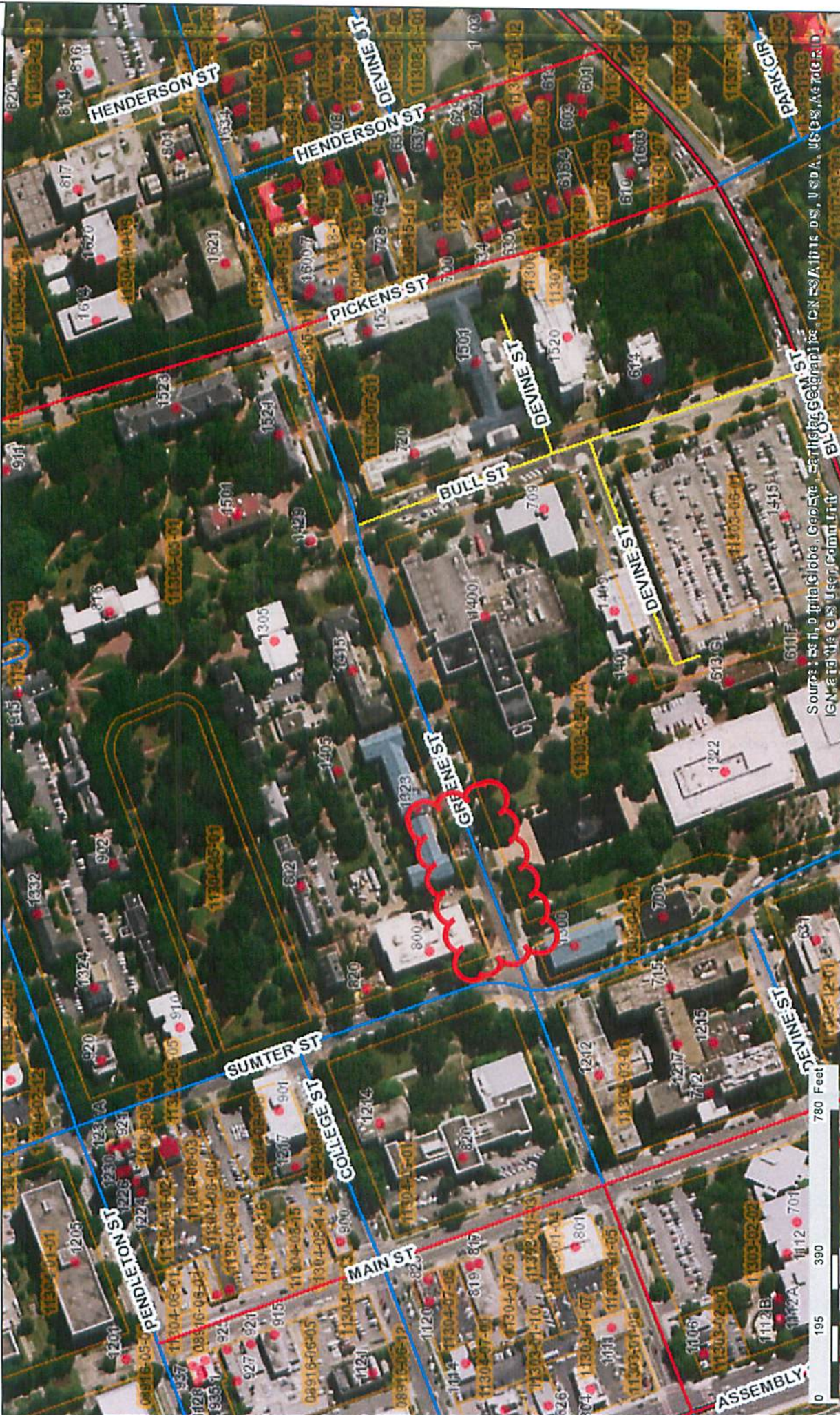

Source: Esri, DigitalGlobe, GeoEye, Earthstar Geographics, CNR Aero, USGS, AeroGRID, IGN, and the GIS User Community

CITY OF COLUMBIA GIS DATA DISCLAIMER

The City of Columbia GIS data represented on this map or plan is the product of compilation, as produced by others. It is provided for informational purposes only and the City of Columbia makes no representation as to its accuracy. Its use without field verification is at the sole risk of the user.



**REQUEST FOR A PERMANENT COMMERCIAL ENCROACHMENT ORDINANCE
(INCLUDING OUTDOOR DINING/LANDSCAPING/STUDENT HOUSING)**

For a continuing encroachment on any type of property in which the City has an interest (i.e., rights of way, tree zone, sidewalk, streets), the person or entity is required to have an encroachment ordinance enacted by City Council permitting the encroachment. Encroachment ordinances are required for but not limited to: irrigation systems; landscaping; fencing; walls; pavers; walkways; outdoor dining items (chairs, tables, umbrellas, etc.); awnings; bollards and directional signs (i.e., churches) Business signs are NOT permitted via an encroachment. Encroachments must comply with all existing City codes, rules and regulations, the Americans with Disabilities Act, if applicable, and are subject to review and approval by City staff. Enactment of the encroachment ordinance by a majority vote of City Council, which is a discretionary legislative act, is also required. ~~In order to obtain an encroachment ordinance from the City of Columbia, it will be necessary for the City of Columbia to be named as an additional insured on your insurance policy with limits being increased to \$600,000 as required by Sec. 11-71.~~ It is recommended that you contact your insurance provider to determine if it will name the City of Columbia as an additional insured prior to submitting your request for an encroachment ordinance. If you have any questions concerning these requirements, please contact Chip Timmons with Risk Management, (803) 733-8306 or catimmons@columbiasc.net.

Please complete and submit this form along with photographs and drawings or site plan drawn to scale (including a 8-1/2 x11) to Johnathan Chambers by e-mail at jechambers@columbiasc.net; fax at 803-343-8779; or mail to Johnathan Chambers, Development Services, POB 147 Columbia, SC 29217, for preparation of an encroachment ordinance. Copies to City departments should be directed to the contact person for that department as shown below.

All work shall comply with the requirements of the City of Columbia and South Carolina Department of Transportation now in existence or hereafter enacted. The materials and type of finish to be used are to be approved by the City Engineer prior to installation. Any damage to the street or sidewalk caused by construction shall be repaired to the satisfaction of the City Manager. Improvements within the encroachment shall be maintained by the grantee at no cost to the City in a manner approved by the City Manager. Property owned, operated and maintained by SCDOT shall comply with SCDOT encroachment requirements.

Date: June 20, 2016 Property Owner: University of South Carolina
 Applicant's Name if different from Property Owner: Emily Jones
 Contact Information: Telephone Number: 777-7592 Fax Number: _____
 Mailing address: 743 Greene Street Columbia SC 29208 E-mail address: efjones@fmc.sc.edu
 Business Name/Development Name for Encroachment: _____

Encroachment type: Wall Fence Columns Steps Irrigation System Landscaping Driveway Pavers Sidewalk/Walkway
 Planters Awning Underground Utilities Other: _____

Dimensions (height/width/length): See attached site plan for dimensions
 (i.e. 6'x42' wooden privacy fence;
 two 12'x4'x3' concrete steps)

Construction material: Concrete, asphalt, brick pavers

OUTDOOR DINING: The Fire Marshal's posted capacity allowed within the business at the time of enactment of the outdoor dining encroachment ordinance shall include the total number of patron seating approved for the outdoor dining encroachment area, if not already included in the posted capacity allowance, so that patrons relocating from inside to the outside or from outside to the inside do not cause the posted capacity to be exceeded.

Hours/days of operation for outdoor dining: _____
 Posted Maximum Capacity Allowance (inside/outside combined): _____ No. of chairs outdoors: _____ No. of Tables Outdoors: _____
 Do you serve: Wine Beer Liquor SCDOR ABL No.: _____ If not, do you intend to apply for an ABL license? _____

I acknowledge that the adjoining property owners and businesses have been contacted and approve the addition of outdoor dining at this location to include the service of beer, wine and/or liquor if applicable during the business hours noted above, and that any changes made to the business hours, use of the encroachment area or items allowed within the encroachment area will require an amendment to the encroachment ordinance.

Name/Title: _____
 Date: _____

I acknowledge that any changes made to the business, hours, use of the encroachment area, or items allowed within the encroachment area, to include obtaining a license to sell beer, wine and/or liquor will require an amendment to the encroachment ordinance.

Amy E. Stone
 Name/Title: _____
 Date: 6-23-16 AMY E. STONE
 SECRETARY, UNIVERSITY OF S.C.

The proposed ordinance will be sent to the requesting party and City offices for review and approval. Johnathan Chambers will compile the recommendations and forward them to the City Clerk for scheduling before City Council. This process may take from 30-90 days.

CONTACT	DEPARTMENT	PHONE	FAX	E-MAIL
Johnathan Chambers	Development Services (Land Development)	803-545-3333	803-343-8779	jechambers@columbiasc.net
John Fellows	Development Services (Planning)	803-545-3222	803-733-8647	jsfellows@columbiasc.net
Brian Cook	Development Services (Zoning)	803-545-3332	803-733-8647	kbcook@columbiasc.net
Jerry Thompson	Development Services (Building Inspections)	803-545-3420	803-733-8699	jthompson@columbiasc.net
Fanessa Pinckney	Development Services (Permits)	803-545-3420	803-733-8699	fcpinckney@columbiasc.net
Amy Moore	Development Services (Historic Preservation)	803-545-3222	803-733-8647	aemoore@columbiasc.net
Robert Harkins	Development Services (Plans Review)	803-545-3420	803-733-8647	rlharkins@columbiasc.net
Denny Daniels	Utilities & Engineering (Construction Management)	803-545-3400	803-988-8199	jddaniels@columbiasc.net
Robert Anderson	Public Works (Administration)	803-545-3780	803-733-8648	raanderson@columbiasc.net
Robert Sweat	Public Works (Street Division)	803-545-3790	803-545-3785	rgsweatt@columbiasc.net
David Brewer	Public Works (Traffic Engineering)	803-545-3850	803-733-8648	ddbrewer@columbiasc.net
Sara Hollar	Public Works (Forestry & Beautification)	803-545-3860	803-733-8648	sehollar@columbiasc.net
John Hooks	Public Works (Solid Waste)	803-545-3800	803-733-8648	jphooks@columbiasc.net
Chip Timmons	Risk Management	803-733-8306	803-733-8245	catimmons@columbiasc.net
David Koon	Fire Department	803-545-3701	803-401-8839	cdgkoon@columbiasc.net
John David Spade	Parking Services	803-545-3070	803-733-8523	spade@columbiasc.net

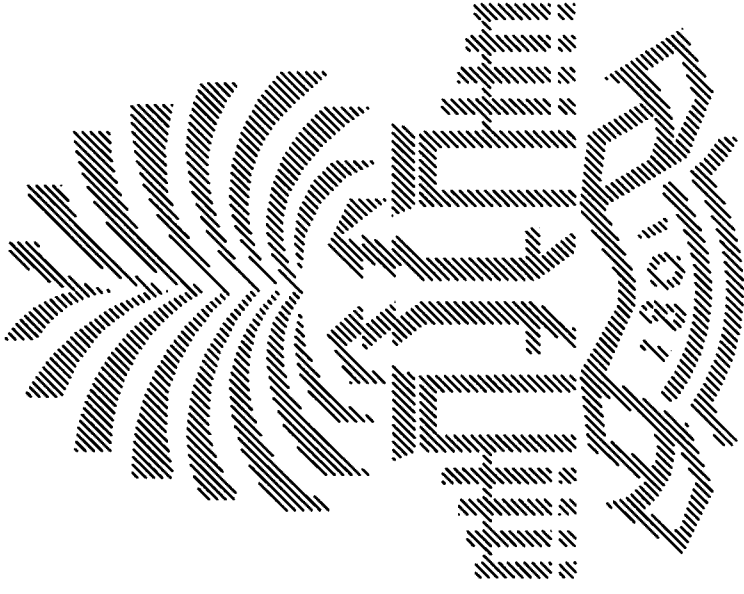

SITY OF SOUTH CAROLINA
MBIA, SOUTH CAROLINA

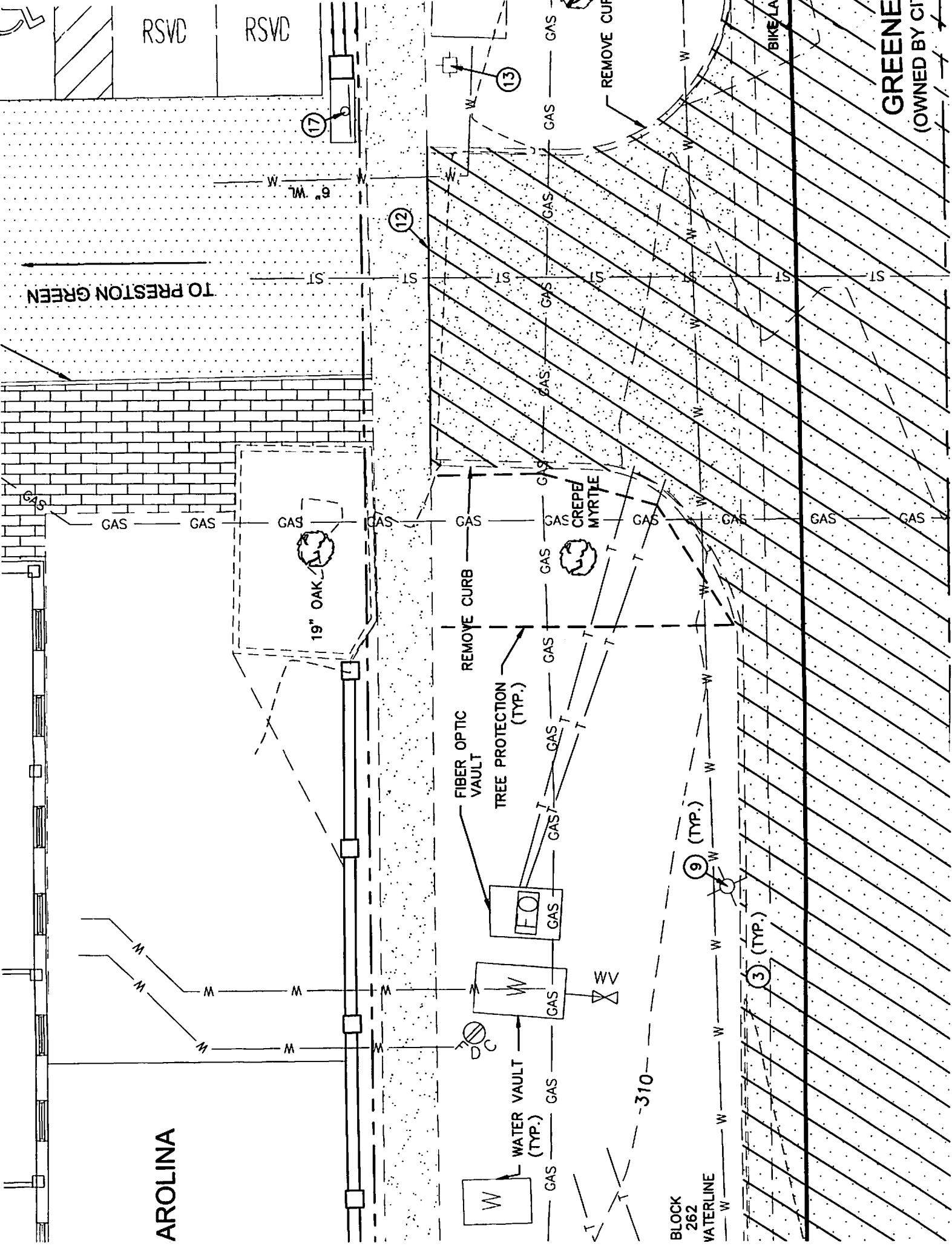

RSVD RSVD

TO PRESTON GREEN

AROLINA

GREENE
(OWNED BY CIT)

17

12

13

19" OAK

CREPE MYRTLE

FIBER OPTIC VAULT

TREE PROTECTION (TYP.)

WATER VAULT (TYP.)

REMOVE CUF

DC

310

9 (TYP.)

3 (TYP.)

BLOCK 262 WATERLINE

BIKE LANE

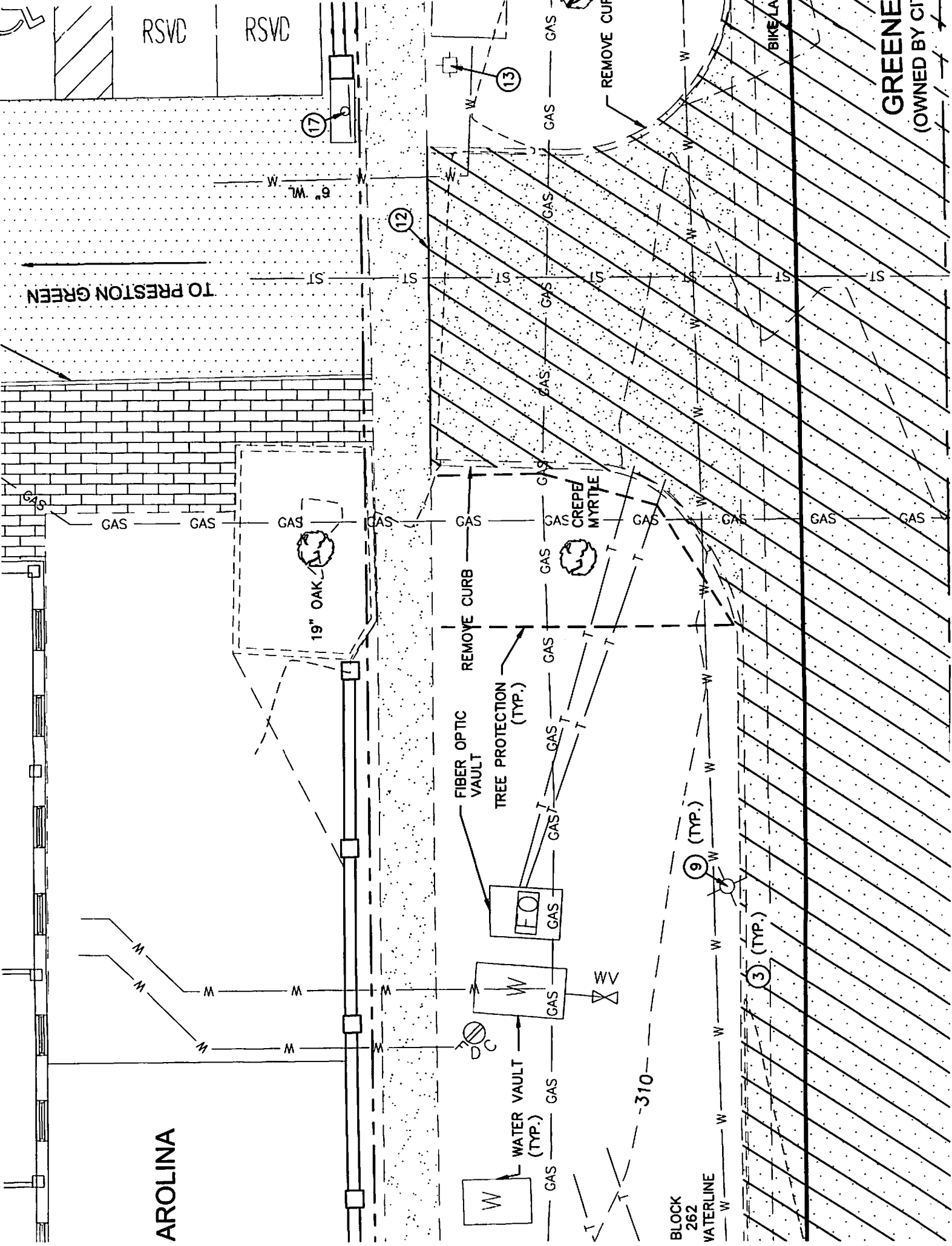

RSVD RSVD

GREENE
(OWNED BY CIT)

TO PRESTON GREEN

INSTALL 2-10'
SWING GATES

AROLINA

AREA #1
SECURITY
FENCING

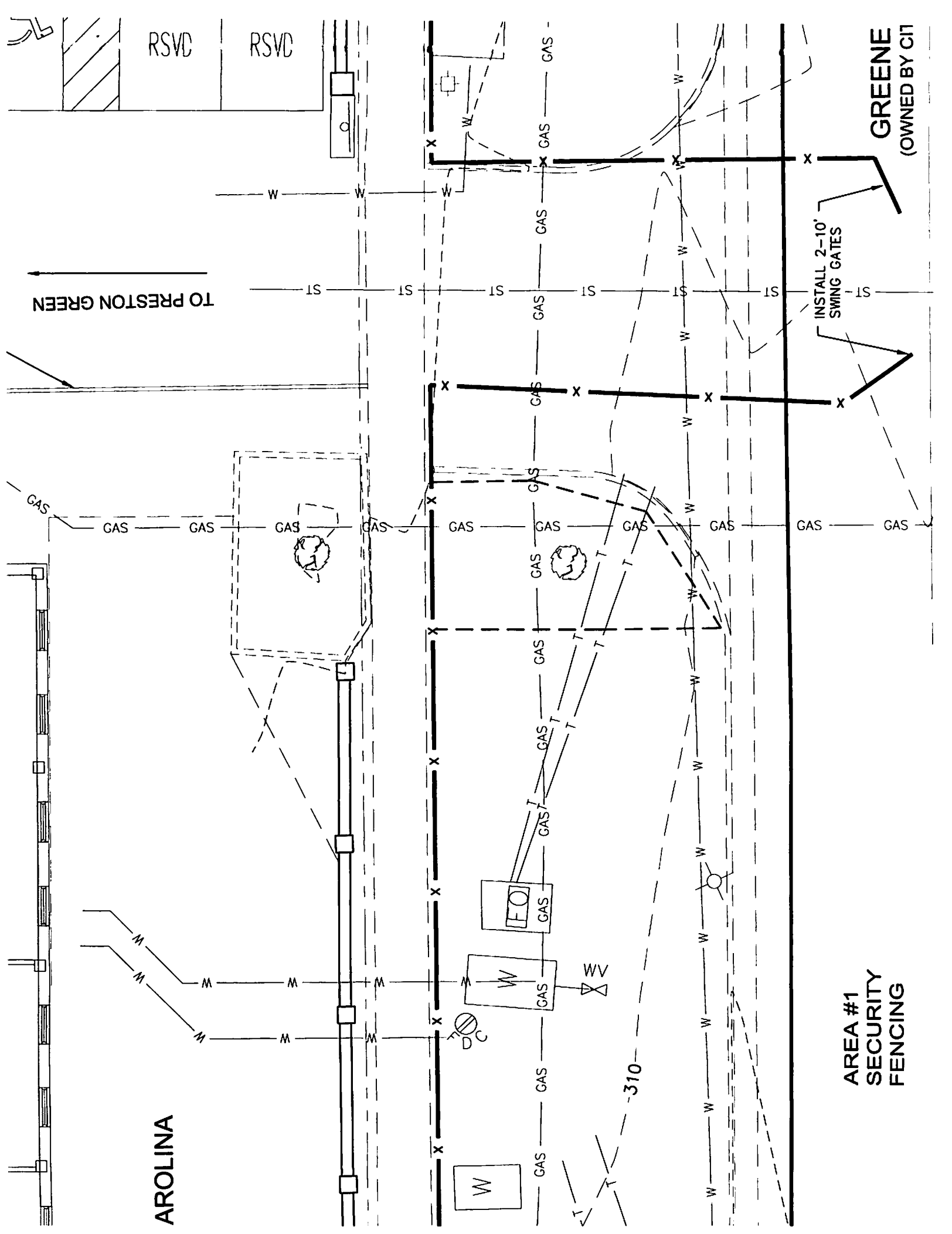

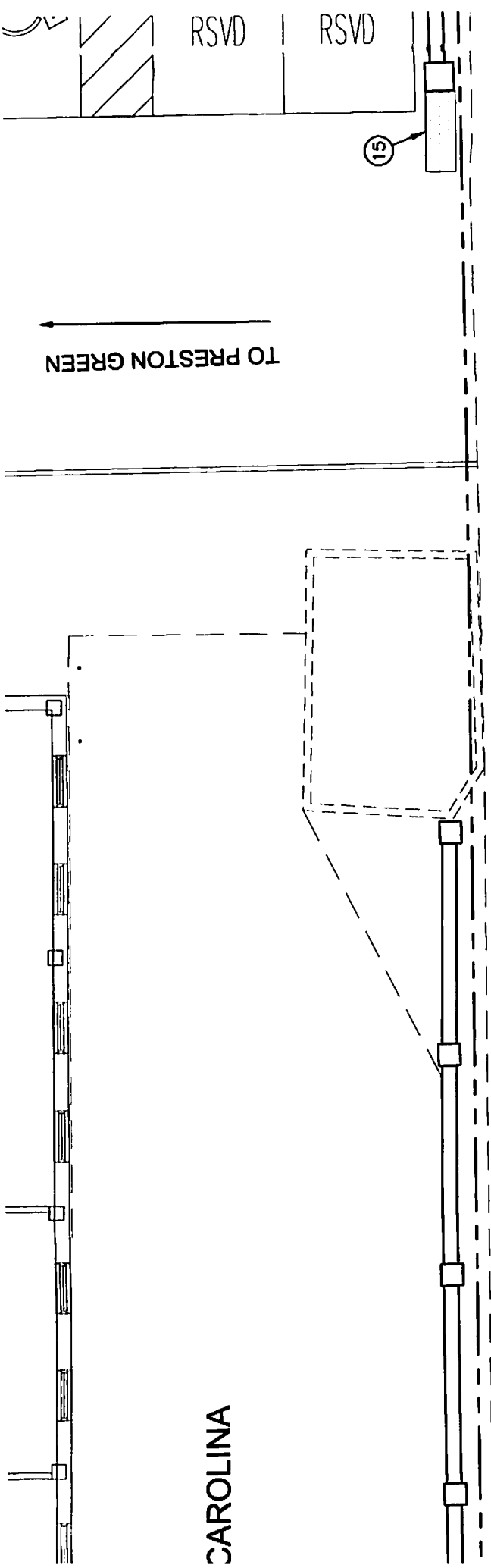

CAROLINA

TO PRESTON GREEN

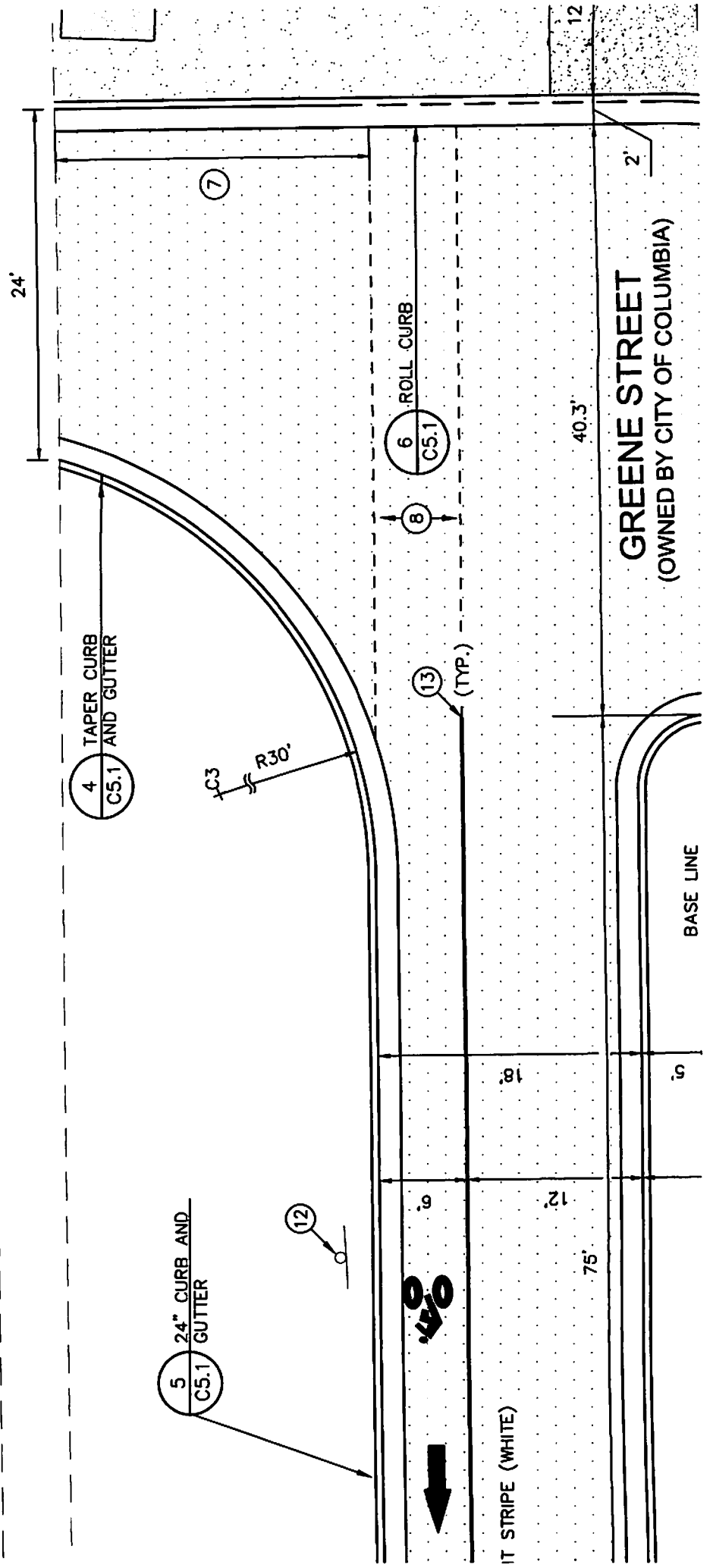

24'

4 TAPER CURB AND GUTTER C5.1

5 24" CURB AND GUTTER C5.1

R30'

6 ROLL CURB C5.1

13 (TYP.)

IT STRIPE (WHITE)

40.3'

GREENE STREET
(OWNED BY CITY OF COLUMBIA)

BASE LINE

2'

12

12'

75'

5'

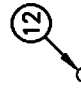

15

7

8

13

12'

12'

75'

5'

2'

12

RSVD RSVD

TO PRESTON GREEN

GREENE STREET
(OWNED BY CITY OF COLUMBIA)

CAROLINA

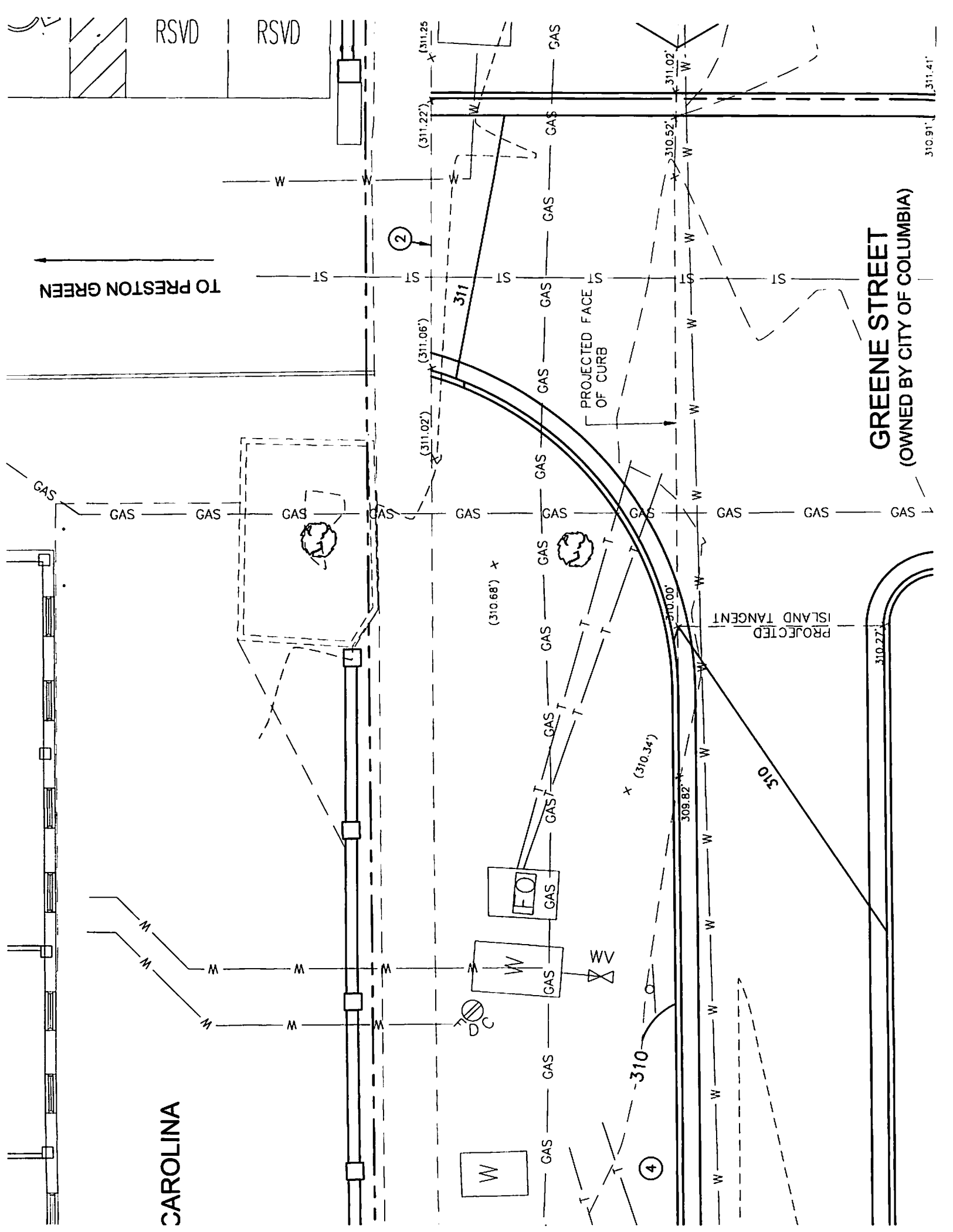

SEDIMENT CONTROL AND STORM DRAINAGE ARE IN ACCORDANCE WITH THE COLUMBIA SEDIMENT AND EROSION CONTROL AND STORM DRAINAGE ORDINANCE.

REMO
TEMPORAR

TEMP
TEMPORAR
AREAS FRI

TEMP
TEMPORAR
STORM ST
BE CONST
CAPACITY
AT ANY PI
STABILIZED

L BRACE
CORNER
ICEPOST (TYP.)

SOUTH CAROLINA REGISTERED PROFESSIONAL ENGINEER

AIRBORNE DUST CONTROL

THE CONTRACTOR SHALL IMPLEMENT DUST CONTROL MEASURES AS OUTLINED IN THE SOUTH CAROLINA DHEC STORMWATER MANAGEMENT BMP HANDBOOK AS NEEDED TO CONTROL AIRBORNE DUST DURING CONSTRUCTION. COORDINATE WITH ENGINEER PRIOR TO IMPLEMENTATION OF VARIOUS MEASURES.

PREDOMINANT SOIL TYPE

URBAN LAND Ur

GRASSING PER 1000 SQUARE FEET (TEMPORARY)

FROM MAY 1 TO AUGUST 30
 1 LB. BROWNTOP MILLET GRASS
 15 LBS. 10-10-10 FERTILIZER
 5 LBS. MAGNESIUM SULFATE
 10 LBS. CALCIUM (GYPSUM)

FROM SEPTEMBER 1 TO APRIL 30
 6 LBS. ANNUAL RYEGRASS
 15 LBS. 10-10-10 FERTILIZER
 5 LBS. MAGNESIUM SULFATE
 10 LBS. CALCIUM (GYPSUM)

FENCING.

IF TREE
OR

TREE

MULCH

PROTECTION

BY

WITHIN 5'
FOR SHALL

PETHEYLENE
AST 210

SEDI

1. THE CC
STRUCT
DISTUR

2. STABILI
HAVE 1
STATED

> WF
MUST
> WF
RESUN

3. ALL SE
OTHER
THE NE

4. SEDIME

5. THE CC
EXCESS
THE FIT
SUBSEC
REPAIR

6. ALL GR
THEY S
BE SMC

7. THE CC
RUNOFF

8. IF NECI
HYDRO
NEEDEL

9. PROVID
ALL DIC
COVER,

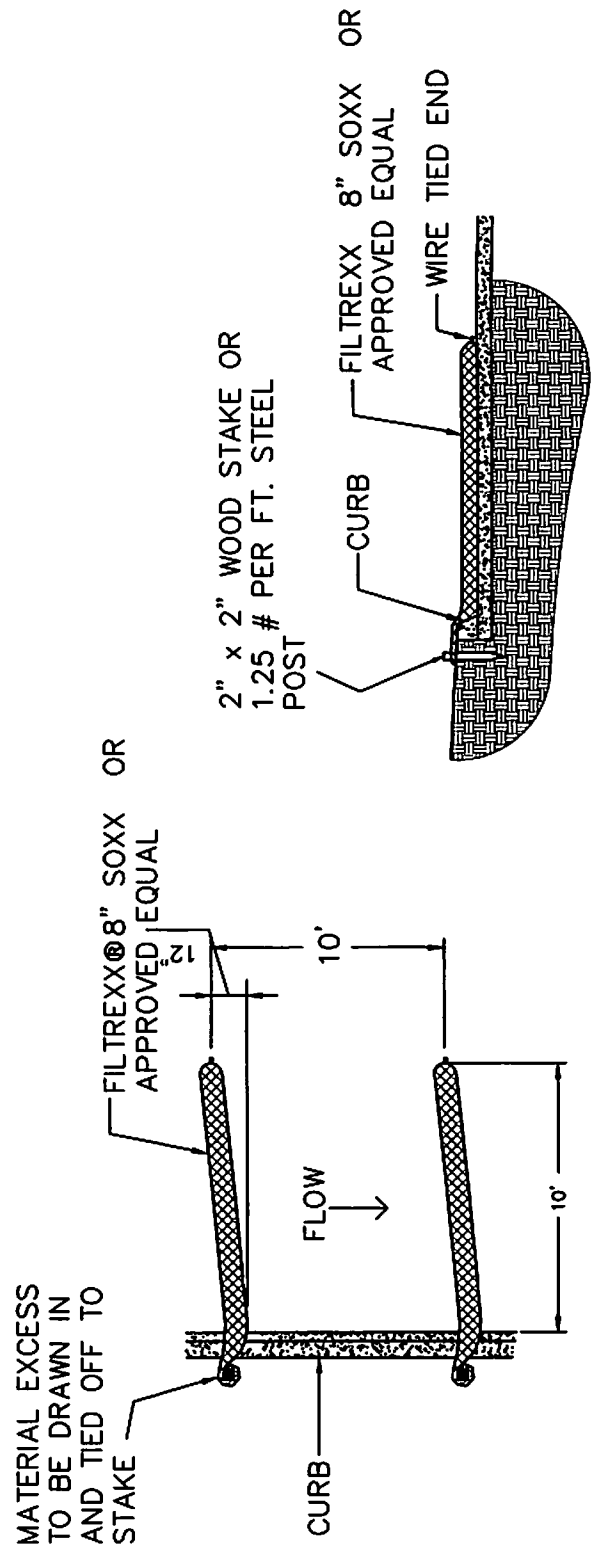

SECTION

E

MINIMUM GUTTER



NOTES:

- 1. CURB AND GUTTER TO BE CONSTRUCTED IN 10 FOOT LENGTHS.
- 2. 1/2 INCH EXPANSION JOINT SHALL BE PROVIDED AT INTERVALS NOT TO EXCEED 100 FEET, AT THE ENDS AND MID-POINT OF RETURNS, AND AT ANY POINT WHERE THE NEW CURB AND GUTTER ABUTS OTHER CONCRETE STRUCTURES.

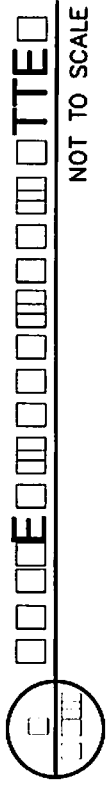

CONSTRUCTED IN 10-FOOT LENGTHS.
 IT SHALL BE PROVIDED AT INTERVALS
 AT THE ENDS AND MID-POINT OF
 JOINT WHERE THE NEW CURB AND
 CONCRETE STRUCTURES.
 JOINTS SHALL BE PROVIDED BETWEEN
 HINGED GUTTER, UNLESS OTHERWISE
 STATED.

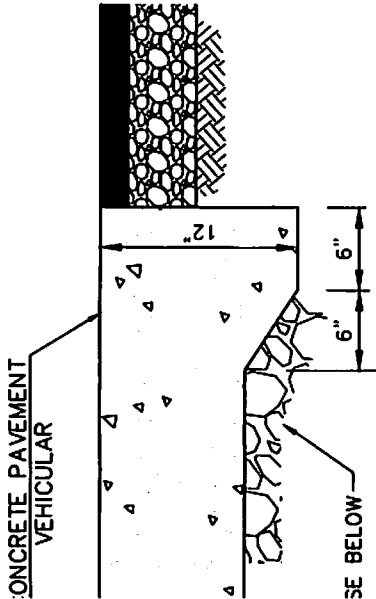
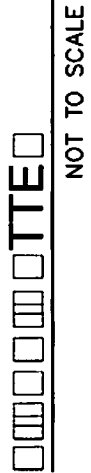

NOT TO SCALE

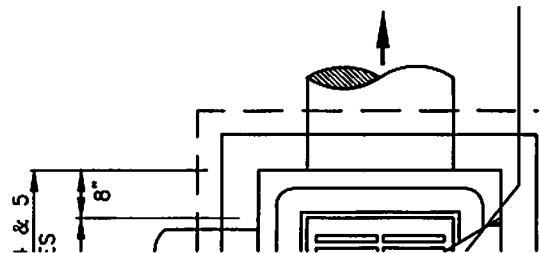

STEPS WHEN REQUIRED

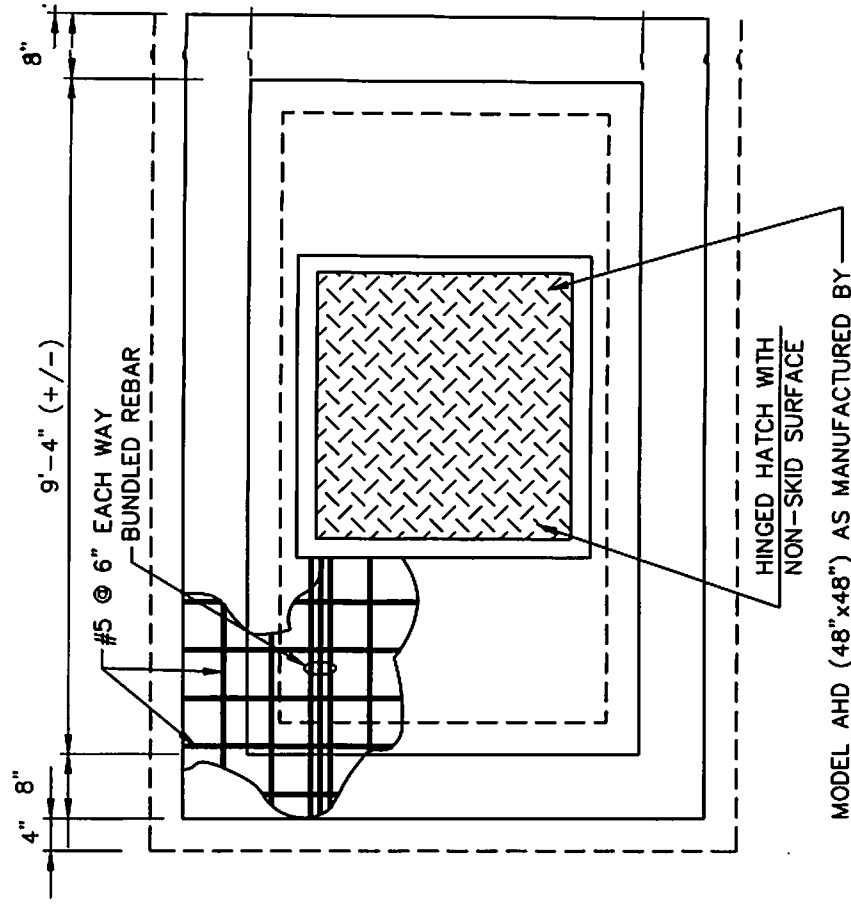

MODEL AHD (48"x48") AS MANUFACTURED BY
 USE FABRICATIONS, INC. (800-253-6873)
 OR APPROVED EQUAL

TOSTEELCORPORATION

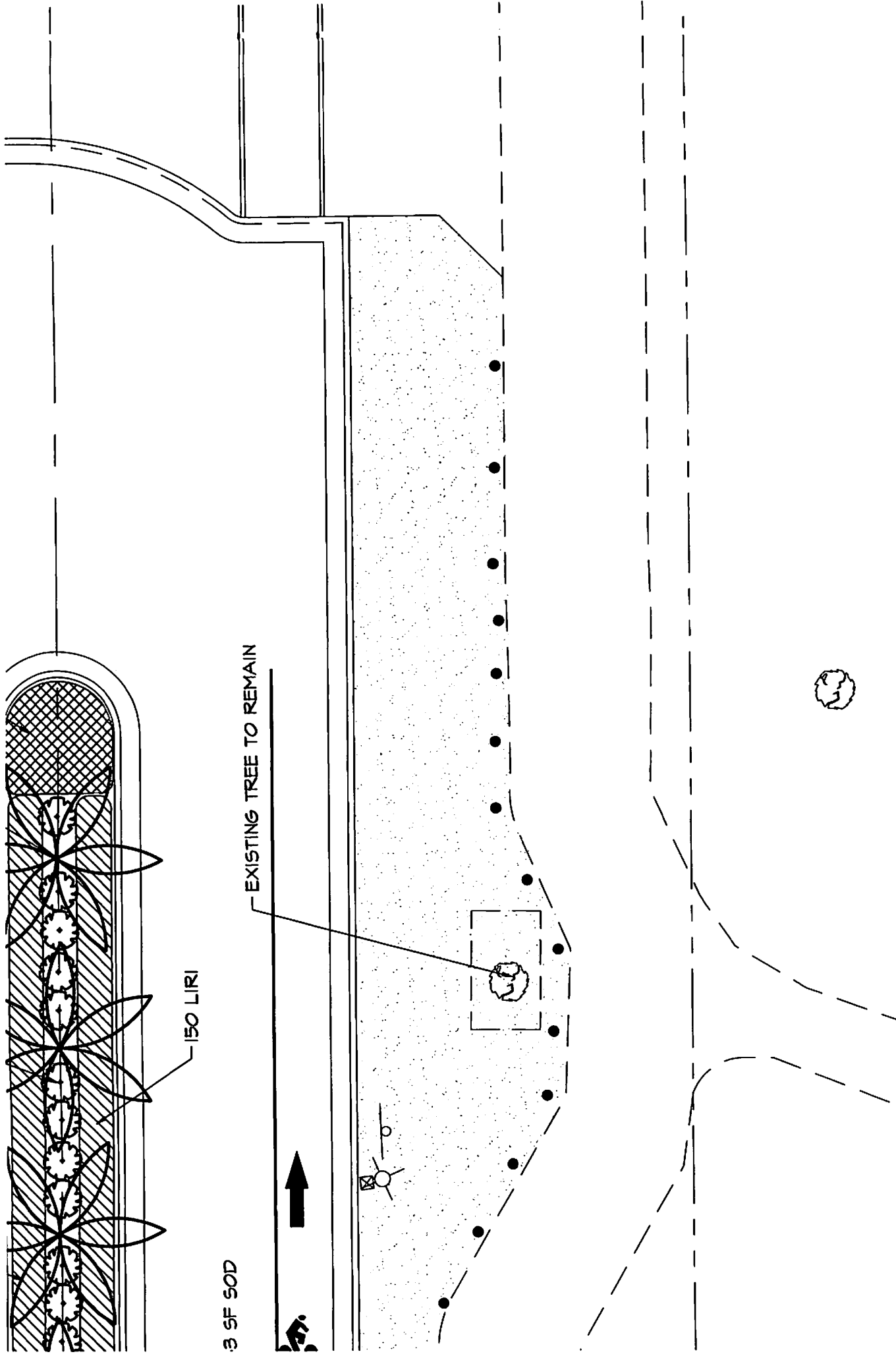

3 SF SOD

150 LIRI

EXISTING TREE TO REMAIN

NOT TO SCALE



NOT TO SCALE

PROCEDURES FOR PERFORMING A PERCOLATION TEST

PERCOLATION TEST

WELL OR POSTHOLE DIGGER, DIG HOLE 18" TO 24" DEEP. HOLE DIAMETER SHOULD BE A MINIMUM OF 4 INCHES. DIAMETER OF THE HOLE SHOULD BE UNIFORM FROM TOP TO BOTTOM WITH THE BOTTOM BEING FLAT.

FILL WITH WATER TO THE TOP AND LET STAND FOR AT LEAST AN HOUR TO PRE-WET THE SOIL.

BE CAREFUL TO WITHIN A COUPLE INCHES OF THE TOP. DON'T OVERFLOW THE HOLE.

FOR MEASUREMENT, PLACE A STICK ACROSS THE TOP OF THE HOLE AND USE A RULER OR MEASURING TAPE TO MEASURE THE PERCENTAGE OF WATER DROPS IN WATER LEVEL.

IF HOLE TO DRAIN FOR AT LEAST ONE HOUR. A LONGER PERIOD OF TIME (2 TO 3 HOURS) WILL GIVE A MORE ACCURATE READING OF AVERAGE PERCOLATION RATES.

USE THE FOLLOWING TABLE TO INTERPRET AVERAGE DROP IN WATER LEVEL PER HOUR AND REFER TO THE TABLE BELOW TO INTERPRET

HOW TO INTERPRET RESULTS

ONE INCH PER HOUR	WELL DRAINED AND SUITABLE FOR ALL SPECIES INCLUDING SENSITIVE SPECIES
ONE-HALF INCH PER HOUR	MODERATELY WELL DRAINED AND ACCEPTABLE FOR MANY SPECIES INCLUDING WET SITE SPECIES
ONE INCH PER HOUR	POORLY DRAINED AND SUITED TO WET SITE SPECIES
WELL IN HOLE DROPS...	SITE IS...

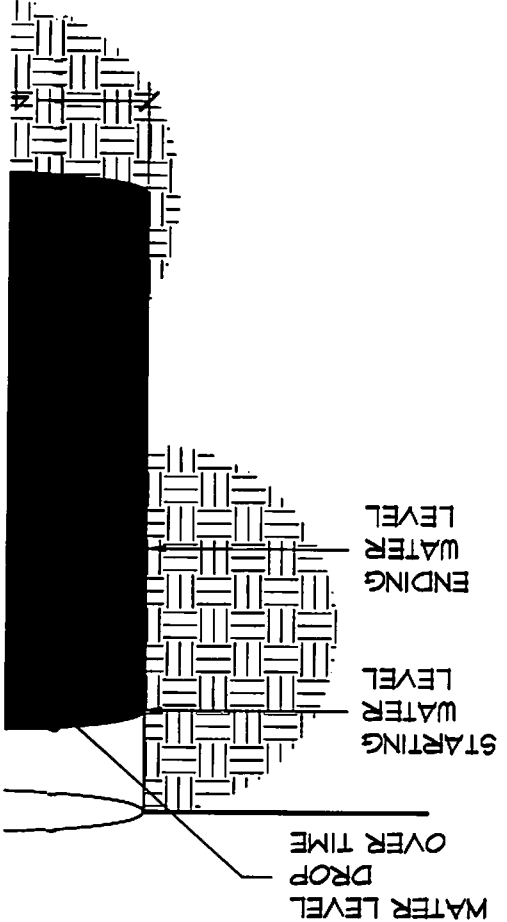

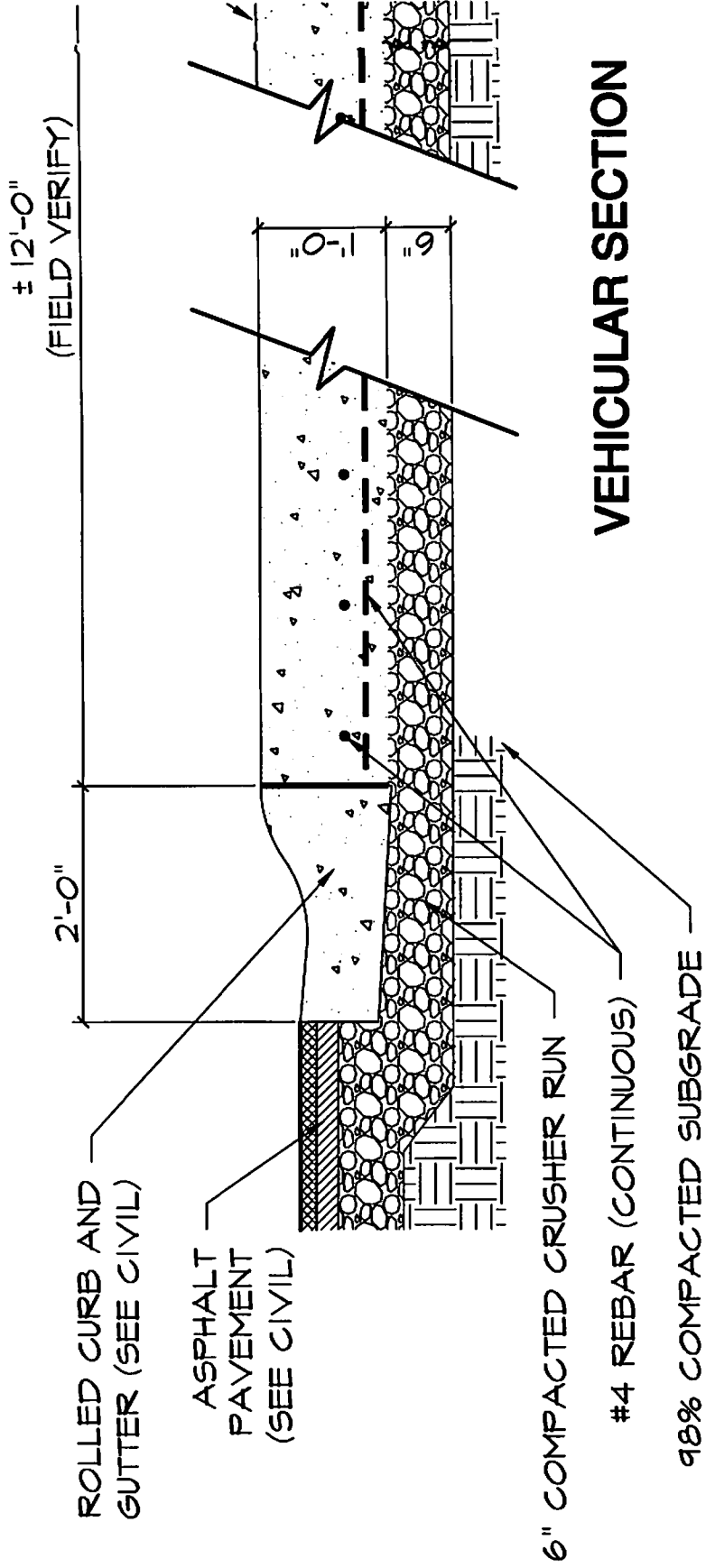

DRIVEWAY SECTION (BASE BID)

A
L-3.1

SECTION

DRIVE
VIL)

BRICK PAVEMENT TO BE MAINTAIN KED BRICK PAVERS, 2 3/4"x4"x8" THICK, BY PINE HALL. WWW.PINEHALLBRICK.COM - (704) 599-7749, C APPROVED EQUAL. PATHWAY RED BRICK PAV NOT OCCUR IN BRICK BIKE LANES. BIKE LANE TO BE COCOA BY PINE HALL OR APPROVED

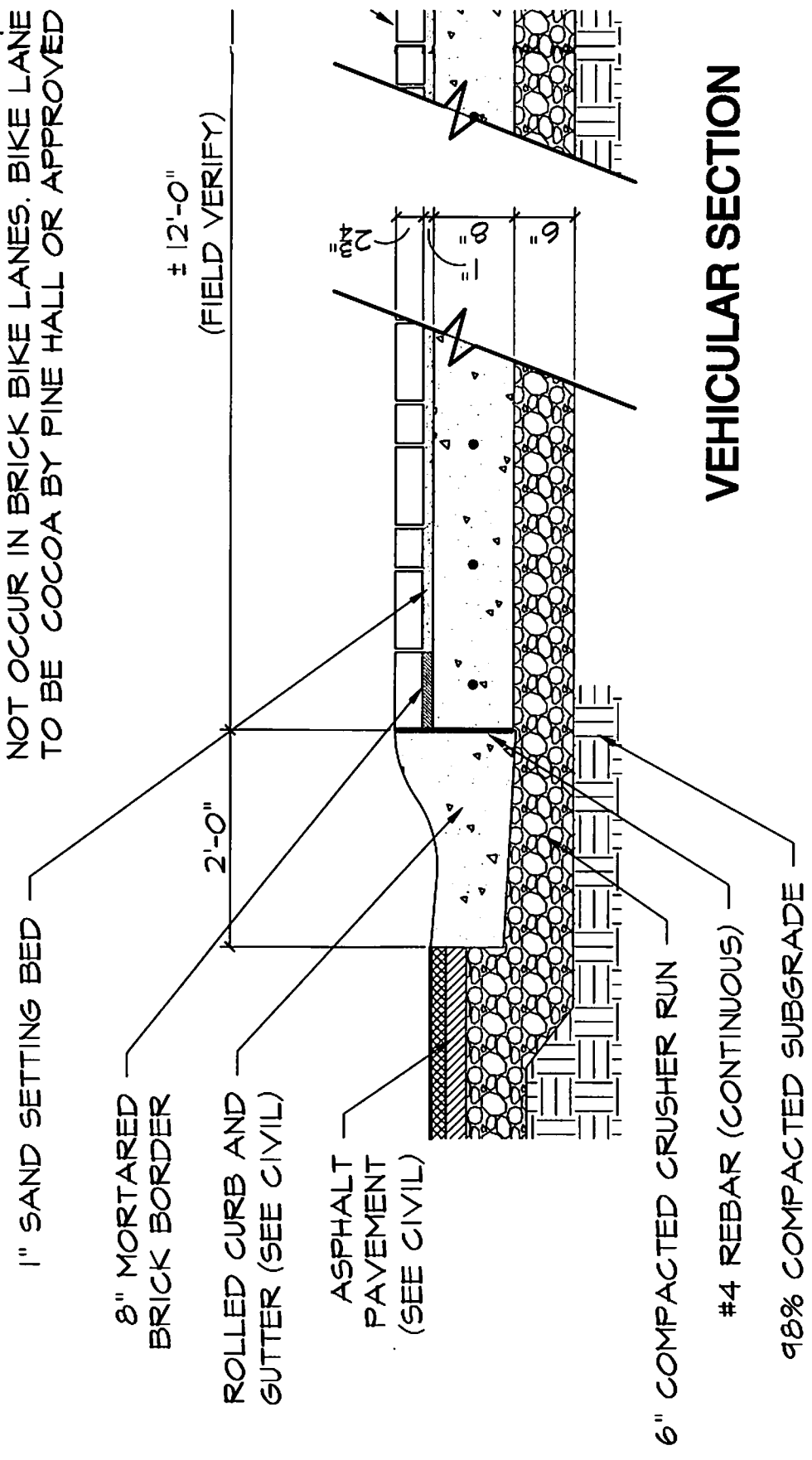

VEHICULAR SECTION

B DRIVEWAY SECTION
L-3.2 SECTION



EXPANSION JOINT (TYP)

DRIVE
VIL)

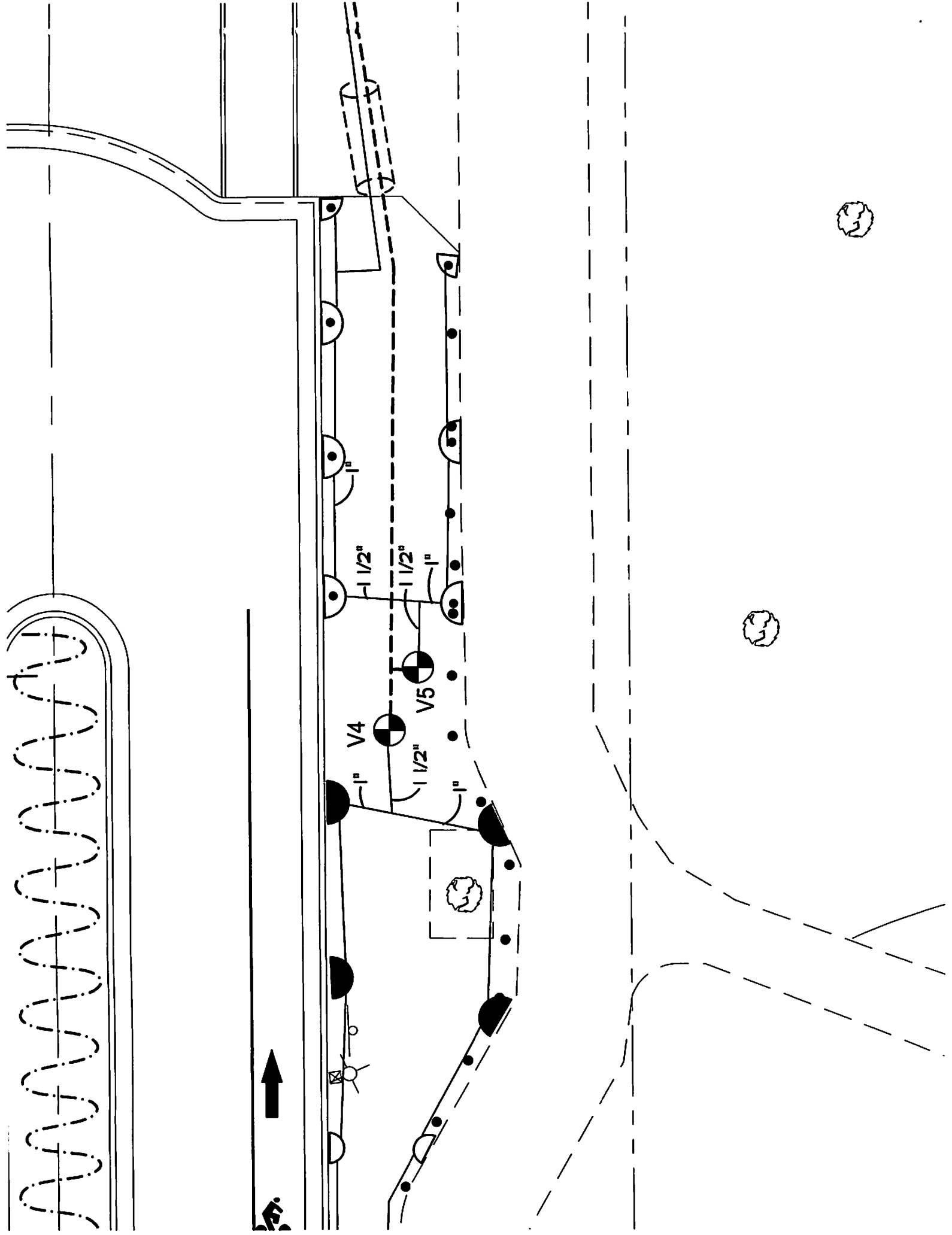

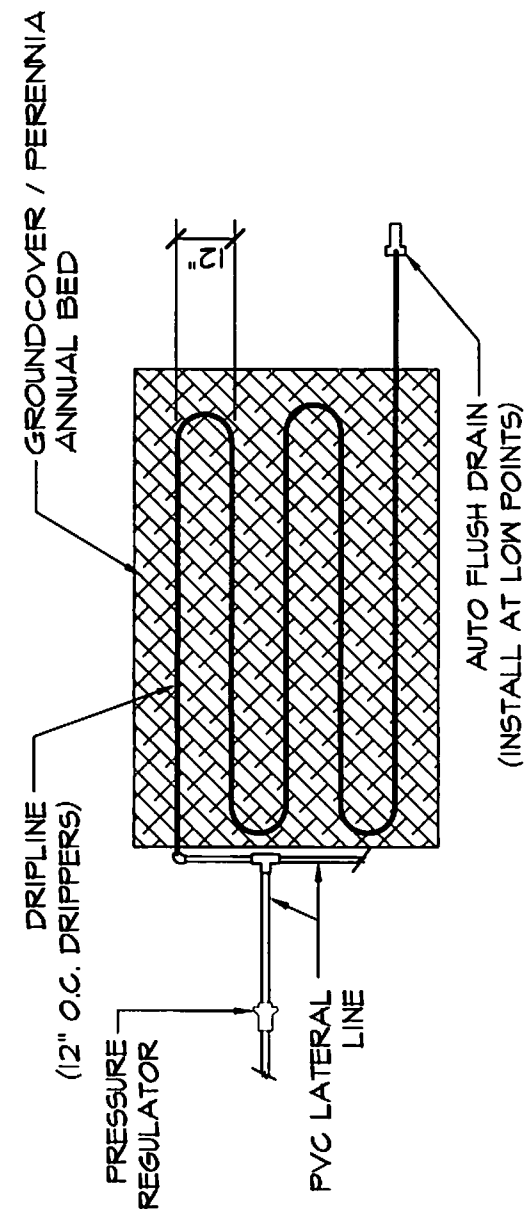
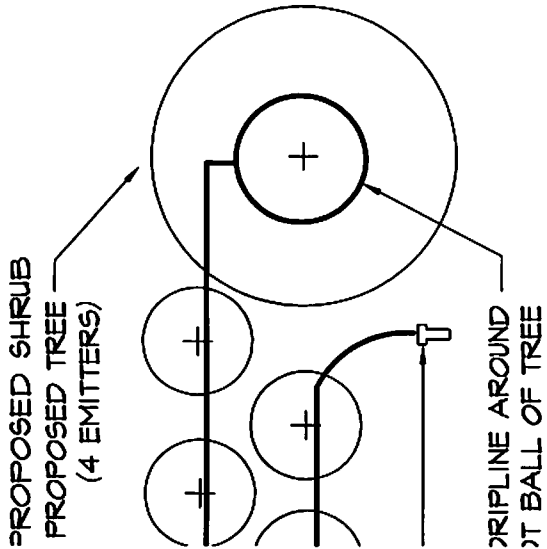

IN SHRUBS

NOT TO SCALE

F
1-2

DRIPLINE IN GROUND

PLAN

N

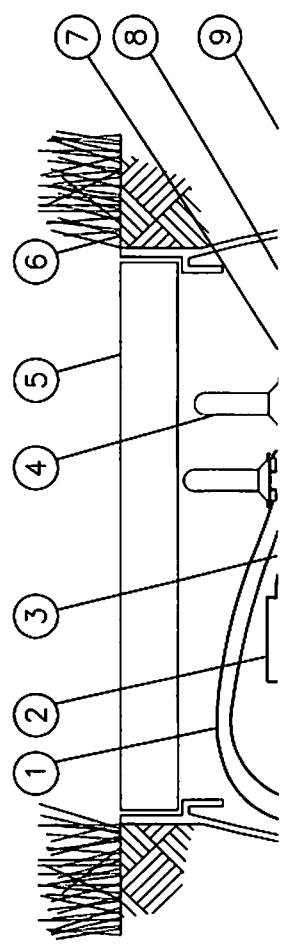

- ① GREEN/YELLOW WIRE FROM SD-210TURF TO GROUND ROD BRASS CLAMP (1 OF 2)
- ② SENSOR DECODER:
RAIN BIRD SD-210TURF M13009 SENSOR DECODER
- ③ RED WIRE FROM SD-210TURF TO FLOW SENSOR
- ④ DB SERIES WIRE CONNECTOR:
RAIN BIRD DBTWC25 (1 OF 6)
- ⑤ 12-INCH VALVE BOX WITH COVER:

- 15. MINIMUM COVER FOR LIGHTING, TRAFFIC CONTROL AND IRRIGATION POWER CIRCUITS SHALL BE 30
- 16. CONTRACTOR IS CAUTIONED THAT THESE PLANS ARE DIAGRAMMATIC ONLY AND THAT EXACT LOCATIONS AND ROUTINGS FOR NEW WORK SHALL BE AS OBVIOUSLY INDICATED AND AS DIRECTED BY OWNER, WITH MODIFICATIONS AS REQUIRED TO AVOID CONFLICTS IN THE FIELD. CONTRACTOR SHALL FIELD VERIFY EXISTING CONDITIONS AND

- NOT GENERALLY SHOWN. EXAMINE NOTES TO DETERMINE REQUIREMENTS
- E SPECIFIED, PROVIDE IN ADDITION TO
- IED BY HASHMARK CODE.
- ONED THAT MULTIWIRE
- IRCUITS DO NOT INDICATE ALL
- RS. PROVIDE SEPARATE NEUTRAL
- IRIPE TO MATCH PHASE CONDUCTOR)

3Y "EC" WITH TRADE SIZE.

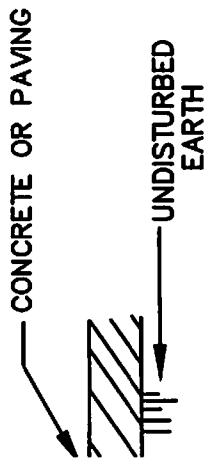

- ELECTRICAL WARNING TAPE 12" BELOW GRADE
- UNDERGROUND CONDUIT(S)

AREA

CTBANK

STEEL OR MALLEABLE IRON COMPRESSION E.M.T. FITTING RAIN TIGHT & CONCRETE TIGHT. EFCOR #761 FOR 3/4" E.M.T. (OTHER FITTINGS EFCOR: #771B 90° CONNECTOR; #751B STRAIGHT CONNECTOR). EQUALS BY REGAL, T&B, STEEL CITY.

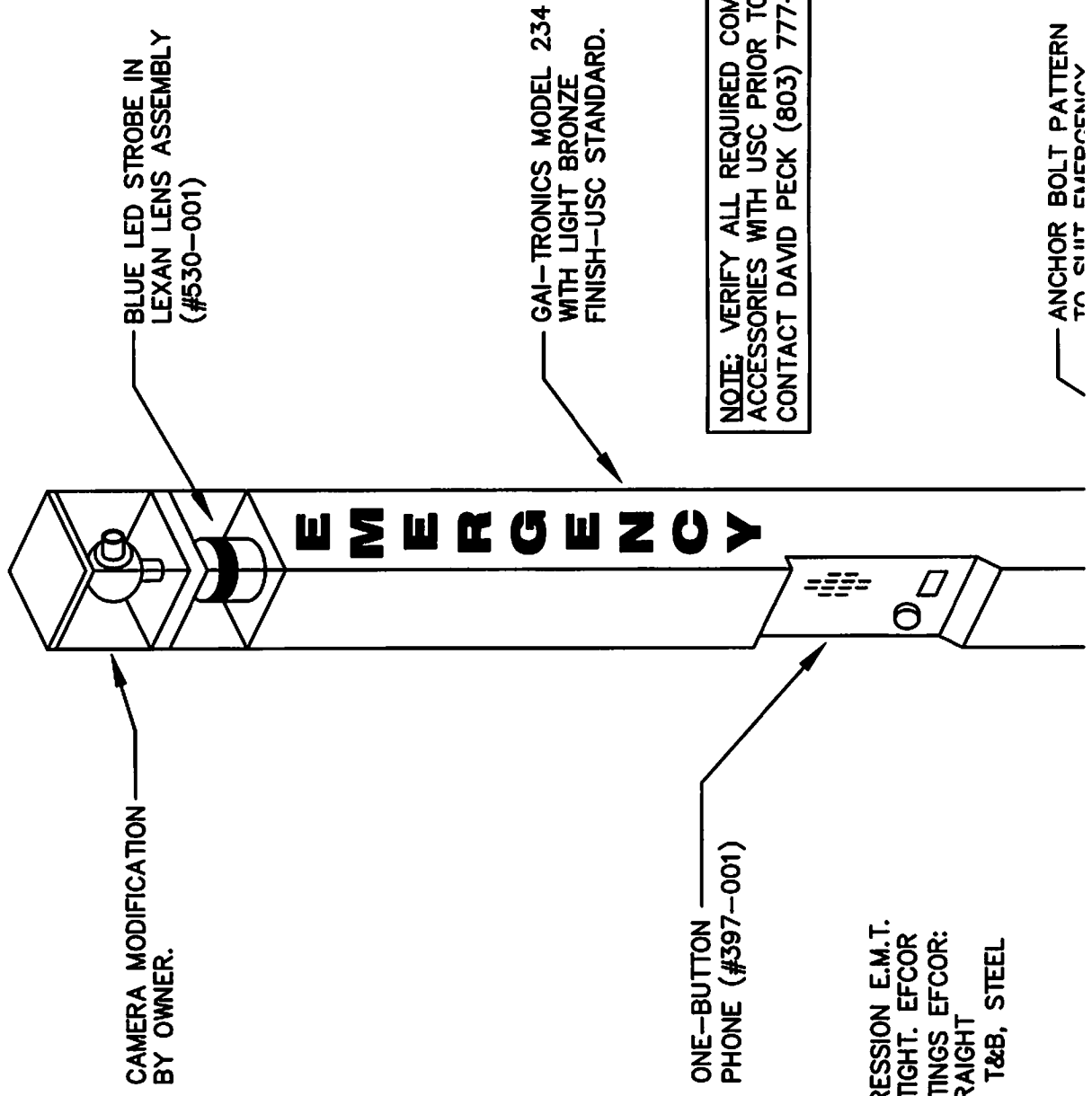

CAMERA MODIFICATION BY OWNER.

BLUE LED STROBE IN LEXAN LENS ASSEMBLY (#530-001)

GAI-TRONICS MODEL 234 WITH LIGHT BRONZE FINISH--USC STANDARD.

ONE-BUTTON PHONE (#397-001)

NOTE: VERIFY ALL REQUIRED COMPONENTS AND ACCESSORIES WITH USC PRIOR TO ORDERING. CONTACT DAVID PECK (803) 777-8786

ANCHOR BOLT PATTERN TO SUIT EMERGENCY

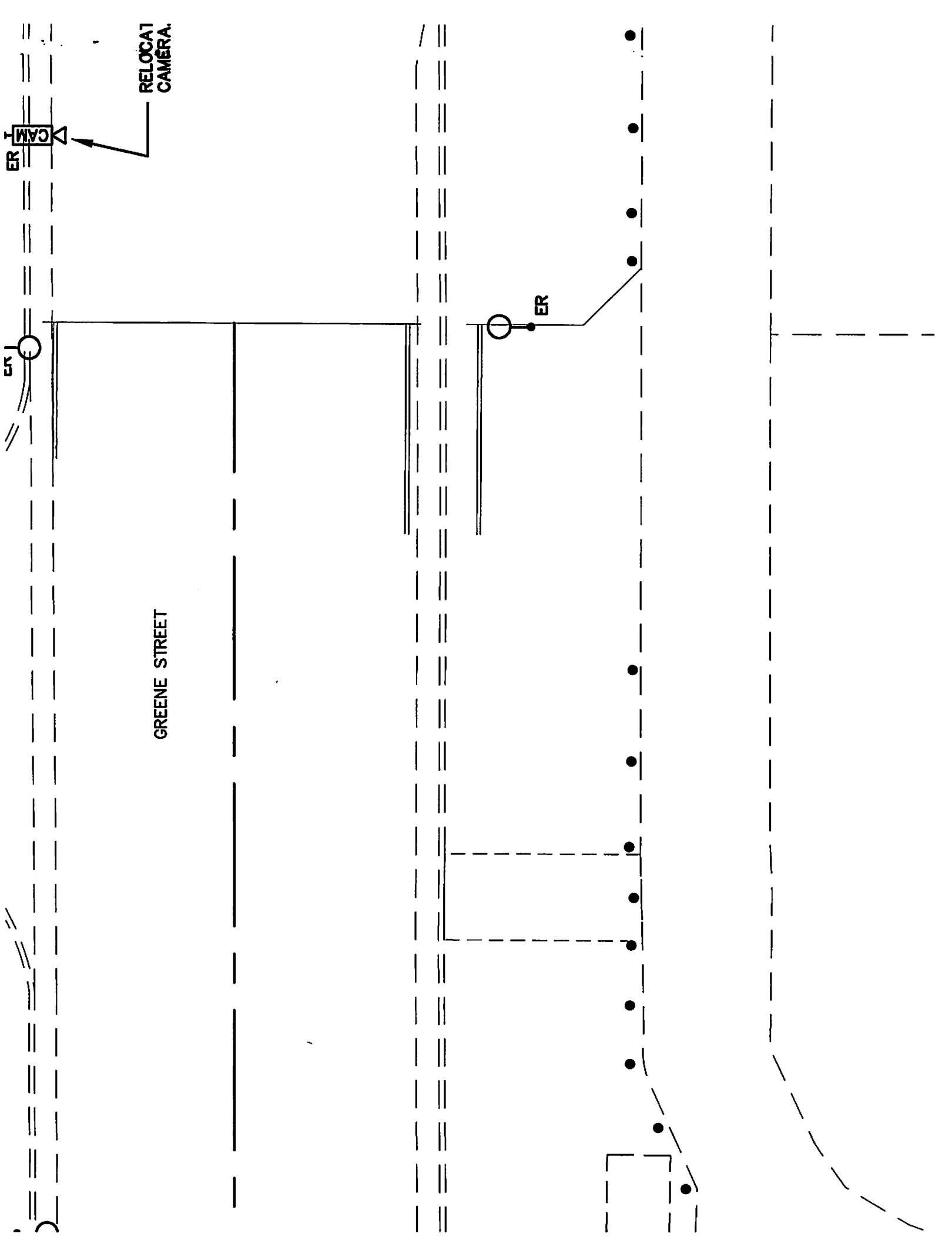

RE
INI
EX
CC
PC
TC
CC
CA

GREENE STREET

EN

EN

